

This drawing is the property of Tusonix, Inc., and may not be used, reproduced, published or disclosed to others without expressed authorization by Tusonix Inc.

**MARKETING SALES DRAWING**  
**DIMENSIONS IN INCHES - DO NOT SCALE THIS DRAWING**  
**DIMENSIONS IN METRIC - [ ]**

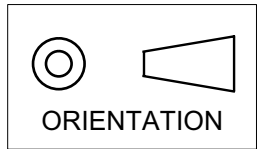

**Electrical Testing**  
**per Tusonix standard**  
**test plans and Mil-Std-202**  
**Test Methods.**

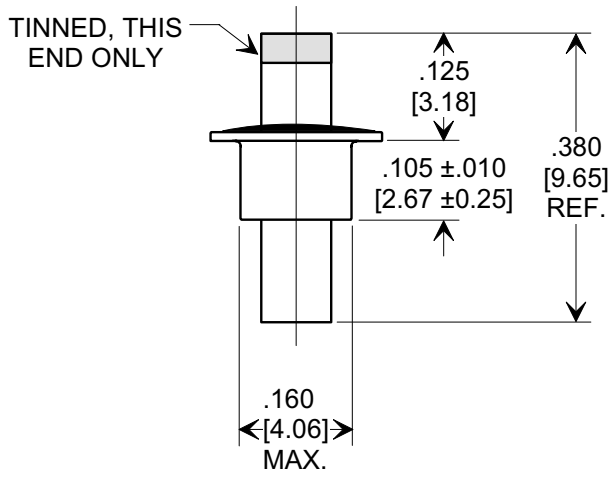
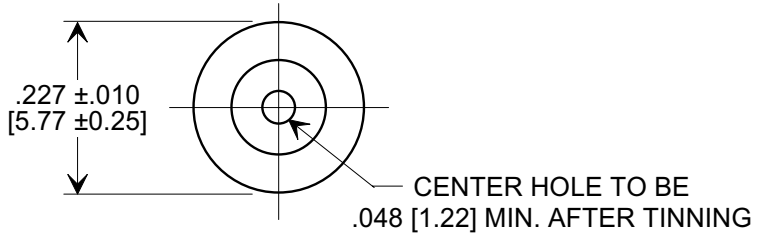
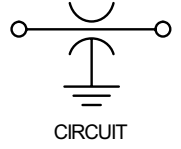

**SPECIFICATIONS**

Capacitance:	100 pF
Tolerance:	±10%
Temp. Coef.:	X5U
Operating Temp.:	-55°C TO 85°C
Voltage Rating:	500 VDC @ + 85°C
DWV:	875 VDC
IR MIN. @ 100 VDC:	10 GΩ

<b>REVISION RECORD</b>	Original Release	<b>20060119-2-02</b>
	C.O.	
	WAS SK 8188-645.S.M. 01-23-06	
	<b>0</b>	

--TOLERANCES-- Unless Otherwise Specified
<b>DECIMAL ± .015 [0.38]</b>
<b>ANGLES ±</b>
<b>TUSONIX</b> TUCSON, ARIZONA

Title <b>FEED - THRU CAPACITOR</b>	
Drawn S.M. 10-21-05	Scale 4 X
Approved T.C. 10-21-05	
<b>A</b>	<b>2404-699-X5U0-101K</b>