

SCALA NON IMPEGNATIVA  
(DO NOT SCALE)  
DIMENSIONI IN  
DIMENSIONS IN mm

**METRIC**

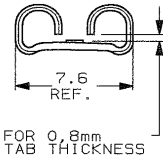
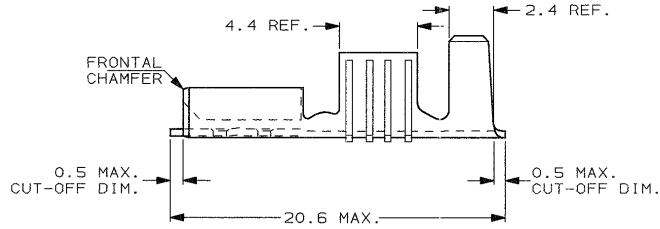
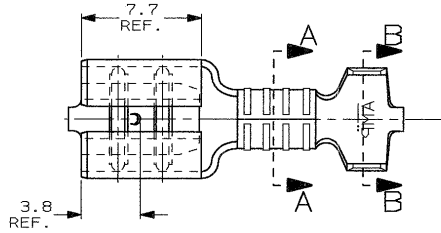

1) PER LE VERSIONI A NASTRO  
VEDERE DISEGNO 160301.  
(FOR STRIP FORM VERSION SEE DRAWING 160301).

2) OBSOLETE PARTS: OBSOLETE CIS STREAMLINING PER D.RENAUD/D.SINISI

SEZIONE A-A  
SECTION A-A

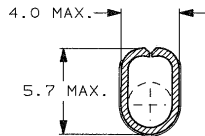

SEZIONE B-B  
SECTION B-B

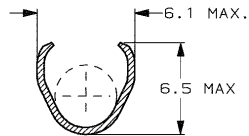

2) OBSOLETE

STAGNATO (TIN PLATED)	BRONZO FOS. (PHOS. BRONZE)	1-160305-9	R
ARGENTATO (SILVER PLATED)	BRONZO FOS. (PHOS. BRONZE)	1-160305-8	R
STAGNATO (TIN PLATED)	OTTONE (BRASS)	1-160305-6	R
NUDO (UNPLATED)	BRONZO FOS. (PHOS. BRONZE)	1-160305-4	R
NUDO (UNPLATED)	OTTONE (BRASS)	1-160305-3	R
FINITURA / COLORE (FINISH / COLOUR)	MATERIALE (MATERIAL)	NUMERO (PART NUMBER)	REV

CUSTOMER DWG. FOR REFERENCE ONLY      DISEGNO PER CLIENTE SOLO PER RIFERIMENTO

THIS DRAWING IS UNPUBLISHED		RELEASE FOR PUBLICATION		19
© COPYRIGHT 19 BY AMP INCORPORATED, HARRISBURG, PA. ALL INTERNATIONAL RIGHT RESERVED. AMP PRODUCTS MAY BE COVERED BY U.S. AND FOREIGN PATENT AND/OR PATENT PENDING.				
TOLLERANZE, SE NON DIVERSAMENTE SPECIFICATO	DIAM. ISOLANTE (INS. DIA. RANGE)	RANGO FILO (WIRE RANGE)	mm2	SCALA (SCALE)
± 0.3	3.8-5.0	4.0-6.0		4:1
ANGOLI (ANGLES)	± 2°		AMP	
DIS. H. YAALI (GR.) 08 AUG 2000		DESCRIZIONE (DESCRIPTION) FASTON® Connector, .250" sr. REC. CONTACT (LOOSE PIECE VERSION)		
R1	REVISED PER ECO-09-022178	KK	DEP. (CHKD) 08 AUG 2000	LOC. SIZE NUMERO (DWG NO) IA3 C-160305
R	OBSOLETE PARTS & REDRAWN ETDG-0245-00	H. Y.	APP. (APP.) 08 AUG 2000	REV. FOGLIO (SHEET) R1 01
REV.	REVISIONI (REVISION RECORD)	DIS. DATA (DRS) (DATE)		1

DISTRIBUZIONE  
PRINTED LIST