

2mm Push Button Switches

Head and Collar

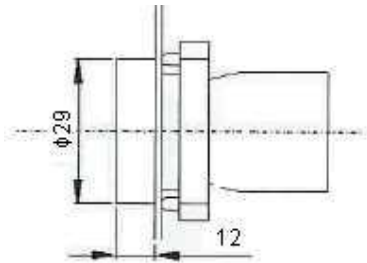

General Characteristics

| | |
|----------------------|---------------------------------------------------------------------------------------------------------------------|
| Products | Push buttons, selector switches, latching mushroom head push buttons, pilot lights and illuminated push buttons |
| Reference standard | IEC 947-5-1/EN 60947-5-1, UL 508, CSA C-22-2 n° 14 |
| Approval | |
| Protection degree | IP 65 according to IEC 947-1 |
| Pollution degree | 3 |
| Temperature | -40°C ~ +70°C (storage) -25°C ~ +70°C (working) |
| Vibration resistance | Mushroom head push buttons: 8gn Other push buttons and pilot lights: 15gn (40 to 500Hz) conforming to IEC 68-2-6 |
| Shock resistance | Push buttons : 70gn Mushroom head push buttons : 15gn Selector switches : 200gn Conforming to IEC 68-2-27 |
| Working position | All working positions are allowed |
| Mechanical life | Push buttons and selector switches 1 million operations, emergency mushroom push buttons 300,000 operations |

<http://www.farnell.com>
<http://www.newark.com>
<http://www.cpc.co.uk>



2mm Push Button Switches

Head and Collar



Contact Elements Characteristics

| | |
|---------------------------------------------------------------------------------------|-----------------------------------------------------------------------------------------------------------------------|
| Rated thermal current | I_{th} 10A |
| Rated insulation Voltage | U_i 500V conforming to IEC 947, UL 508 and CSA 22-2 n° 14 |
| Insulation category | Group C conforming to NF C20-040, VDE 0110 |
| Operating force | Push buttons- 1 'NO' = 10N, 1 'NC' = 8N Additional contacts- 'NO' = +5N, 'NC' = +3N |
| Dielectric strength | 2.5KV for 1 minute |
| Insulation resistance | 2M Ω minimum (500 V dc) |
| Initial contact resistance | $\leq 25m\Omega$ |
| Shot circuits protection | 10A 500V, cartridge fuse gl or N conforming to IEC 337-1 |
| Terminal reference | Conforming to CENELEC EN 50013 |
| Connections | On screw with non losable plate lamp sec. 2.5mm ² maximum (14AWG) |
| Contact operation | Self cleaning type, slow action, positive opening |
| Operation frequency | 3600 operations per hour |
| Utilization category | AC 15 (DC 13) |
| Rated power Conforming to IEC 947-5-1 Load factor : 0.5 AC supply (50/60 Hz) | DC supply Power broken in watts for 1 million operations Voltage : 24V 48V 120V Inductive load : 65W 48W 40W |

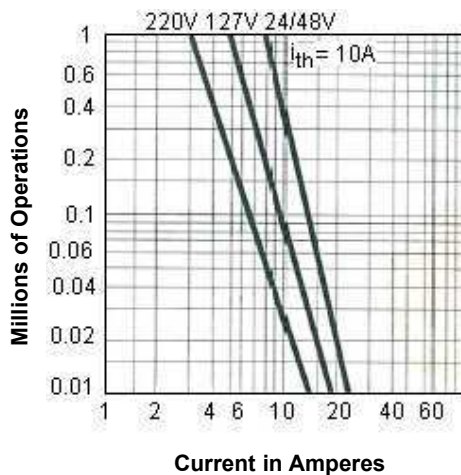

2mm Push Button Switches

Head and Collar



AC Ratings, Inductive - NEMA A600

35% Power Factor

| Volts | Makes Amperes | VA | Break Amperes | VA | Continuous Carrying Amperes | Resistive 75% Power Factor Make, Break and Continuous Amperes |
|-------|---------------|------|---------------|-----|-----------------------------|---------------------------------------------------------------|
| 120 | 60 | 7200 | 6 | 720 | 10 | 10 |
| 240 | 30 | | 3 | | | |
| 480 | 15 | | 1.5 | | | |
| 600 | 12 | | 1.2 | | | |

DC Ratings, NEMA Type Q600

Inductive and Resistive

| Volts | Make and Break | Continuous |
|-------|----------------|------------|
| 125 | 55 | 2.5 |
| 250 | 0.27 | |
| 600 | 0.10 | |

Part Number Table

| Description | Part Number |
|---------------------------|-------------|
| 22mm Switches Flush White | RCB2-BA1 |
| 22mm Switches Flush Black | RCB2-BA2 |
| 22mm Switches Flush Green | RCB2-BA3 |
| 22mm Switches Flush Red | RCB2-BA4 |
| 22mm Switches Flush Amber | RCB2-BA5 |
| 22mm Switches Flush Blue | RCB2-BA6 |

Disclaimer This data sheet and its contents (the "Information") belong to the Premier Farnell Group (the "Group") or are licensed to it. No licence is granted for the use of it other than for information purposes in connection with the products to which it relates. No licence of any intellectual property rights is granted. The Information is subject to change without notice and replaces all data sheets previously supplied. The Information supplied is believed to be accurate but the Group assumes no responsibility for its accuracy or completeness, any error in or omission from it or for any use made of it. Users of this data sheet should check for themselves the Information and the suitability of the products for their purpose and not make any assumptions based on information included or omitted. Liability for loss or damage resulting from any reliance on the Information or use of it (including liability resulting from negligence or where the Group was aware of the possibility of such loss or damage arising) is excluded. This will not operate to limit or restrict the Group's liability for death or personal injury resulting from its negligence. SPC Multicomp is the registered trademark of the Group. © Premier Farnell plc 2009.

<http://www.farnell.com>
<http://www.newark.com>
<http://www.cpc.co.uk>

