

G Series

Capacitor Discharge & Symmetry

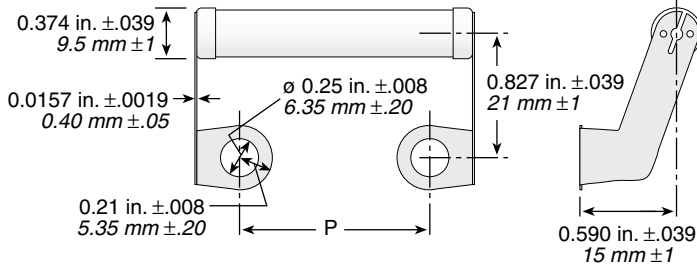

Series	Wattage @25°C	Wattage @70°C	Limiting Voltage	Critical Value	Ohmic Range	Length P (in. ±.039 / mm±1)
GW10	10	8.5	685	47KΩ	1Ω-82K	0.866 / 22.0
GW13	13	11	940	68KΩ	1Ω-120k	1.252 / 31.8

ORDERING INFORMATION

G Series — **GW10J5K00E** — E = RoHS compliant

Component Modifier	Wattage	Tolerance	Resistance Value	Examples:
W = wirewound	10 watts	K = 10%	R = Decimal	1K00 = 1,000Ω
	13 watts	J = 5%	K = 1,000	10K0 = 10,000Ω
		G = 2%		82K0 = 82,000Ω
		F = 1%		120K = 120,000Ω

Check product availability at www.ohmite.com

STANDARD PART NUMBERS

Ohms	10 watt	13 watt
1K	GW10J1K00E	GW13J1K00E
2.5K	GW10J2K50E	GW13J2K50E
5K	GW10J5K00E	GW13J5K00E
7.5K	GW10J7K50E	GW13J7K50E
10K	GW10J10K0E	GW13J10K0E
15K	GW10J15K0E	GW13J15K0E
20K	GW10J20K0E	GW13J20K0E
25K	GW10J25K0E	GW13J25K0E
40K	GW10J40K0E	GW13J40K0E
50K	GW10J50K0E	GW13J50K0E
75K	GW10J75K0E	GW13J75K0E

Check product availability using the Worldwide Inventory Search at ohmite.com

FEATURES

- High Power Dissipation up to 13W @25°C
- Specially Designed to meet Repetitive Pulse Loading
- Corrosion Resistant Terminals for long life
- Superior Vibration Resistance
- IEC 115-1 Reference Standard

SPECIFICATIONS

- Temperature Range:** -55°C to 200°C
- Terminal Strength:** >25N
- Derating:** 25°C to 350°C, Linearly
- TCR:** ±100 ppm/°C
- Tolerance:** 1%, ±2%, ±5%, ±10%

PERFORMANCE DATA

Endurance at Rated Temperature	Full Rated Power for 1000hrs, (1.5hrs ON, 0.5hrs OFF) at 25°C	ΔR < 5% + 0R05
Short Term Overload	10 x Rated Power for 5 secs, IEC115-1, Clause 4.1.3	ΔR < 2% + 0R05
Damp Heat Steady State	90-95% RH, 40°C, 56 Days, IEC 115-1, Clause 4.17.3	ΔR < 5% + 0R05
Climatic Sequence	As per IEC 115-1, Clause 4.23	ΔR < 5% + 0R05
Solderability	Not Applicable-Resistor is Designed for Screw Mounting Only	
Terminal Strength	25 N Pull Test for 10 Seconds, IEC 115-1, Clause 4.16	ΔR < 0.5% + 0R05

COMPATIBLE CAPACITORS

BHC		ILL Capacitor	
GW10 Series ALS30/31 KE, KF	Case Sizes ND, NF, NP, NT, RD, RH, RP	GW10 Series LKP, LRP	Case Sizes 51, 51
GW13 Series ALS30/31	Case Sizes ND, NF, NP, NT, RD, RH, RP	GW13 Series LKP	Case Sizes 77, 90
Cornell Dubilier		Nichicon UK	
GW10 Series 3186	Case Sizes EA, EB, EC, ED, EE, EF, EG, EH	GW10 Series NR, NT, NW, NX, QR	Case Sizes 51, 51, 51, 51, 51
GW13 Series 3186	Case Sizes GC, GD, GE, GF, GG, GH, GJ, DN	GW13 Series NR, NT, NW, NX, QR	Case Sizes 76.2, 90, 76.2, 90, 76.2, 90, 76.2, 90
GW10 Series 3188	Case Sizes EA, EB, EC, ED, EE, EF, EG, EH	GW10 Series NR, NT, NW, NX, QR	Case Sizes 51, 51, 51, 51, 51
GW13 Series 3188	Case Sizes GC, GD, GE, GF, GG, GH, GJ, DN	GW13 Series NR, NT, NW, NX, QR	Case Sizes 76.2, 90, 76.2, 90, 76.2, 90
GW10 Series 520C	Case Sizes BA, BH, BB, BJ, BC, BD, BE, BF	GW10 Series NR, NT, NW, NX, QR	Case Sizes 51, 51, 51, 51, 51
GW13 Series 520C	Case Sizes DB, DJ, DC, DD, DE, DF, DP, DN, DG, FC, FD, FE, FF, FP, FN, FG	GW13 Series NR, NT, NW, NX, QR	Case Sizes 76.2, 90, 76.2, 90, 76.2, 90
GW10 Series DCMC	Case Sizes BA, BH, BB, BJ, BC, BD, BE, BF	GW10 Series NR, NT, NW, NX, QR	Case Sizes 51, 51, 51, 51, 51
GW13 Series DCMC	Case Sizes DB, DJ, DC, DD, DE, DF, DP, DN, DG, FC, FD, FE, FF, FP, FN, FG	GW13 Series NR, NT, NW, NX, QR	Case Sizes 76.2, 90, 76.2, 90, 76.2, 90
GW10 Series OTB, MPF, PF	Case Sizes All, BA, BH, BB, BJ, BC, BD, BE, BF	GW10 Series NR, NT, NW, NX, QR	Case Sizes 51, 51, 51, 51, 51
GW13 Series SCR, SF, T	Case Sizes A, All, A	GW13 Series NR, NT, NW, NX, QR	Case Sizes 51, 51, 51, 51, 51
Epcos		United Chemi-Con	
GW10 Series B41456, B41458, B43456, B43458	Case Sizes 51.6, 51.6, 51.6, 51.6	GW10 Series KMH, LXA, RWE, RWF, RWY, SME	Case Sizes 50, 50, 50, 50, 50, 50
GW13 Series B41456, B41458, B43456, B43458	Case Sizes 76.9, 76.9, 76.9, 76.9	GW13 Series LXA, LXR, KMH, RWE, RWL, RWY, SME, UTOR	Case Sizes 76, 89, 76, 89, 76, 89, 76, 89, 76, 89, 76, 89, 76
Vishay		Panasonic	
GW10 Series 36D, 36DE, 36DX	Case Sizes BY, BA, BM, BB, BD, BE, BF	GW10 Series G	Case Sizes FB, FC, FE, FG, FH, FK, FL, FN, FP
GW13 Series 36D, 36DE, 36DX	Case Sizes BY, BA, BM, BB, BD, BE, BF	GW13 Series G	Case Sizes HG, HH, HK, HL, HN, HP, HW