

Toggles

Rockers

Pushbuttons

Illuminated PB

Programmable

Keylocks

Rotaries

Slides

Tactiles

Tilt

Touch

Indicators

Accessories

Supplement

### TYPICAL INDICATOR ORDERING EXAMPLE

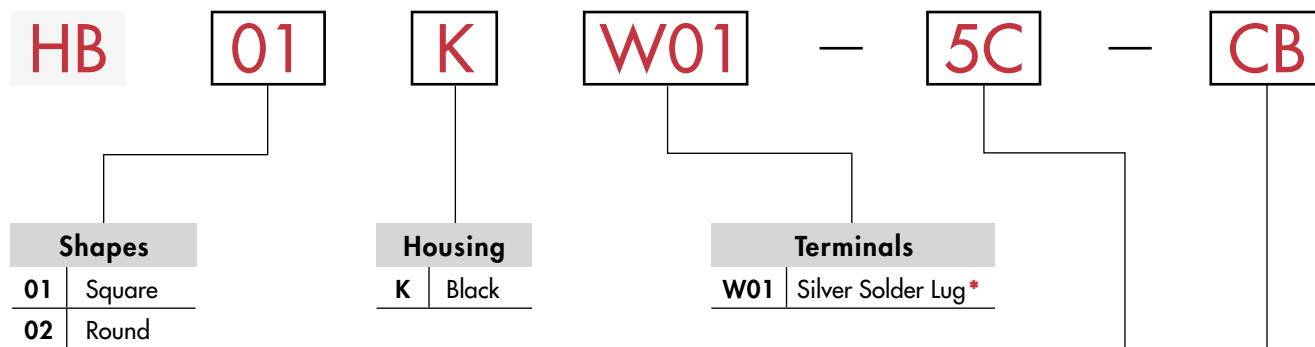

\* Wire harness & cable assemblies offered only in Americas

### DESCRIPTION FOR TYPICAL ORDERING EXAMPLE

**HB01KW01-5C-CB**



Bright		LED Cap: Lens/Diffuser Color	
5C	Red	CB	Red/White
5D	Amber	DB	Amber/White
5F	Green	FB	Green/White
		JB	Clear/White
Super Bright		LED Cap: Lens/Diffuser Color	
6B	White	JB	Clear/White
6F	Green		
6G	Blue		

### LED COLORS & SPECIFICATIONS

The electrical specifications shown are determined at a basic temperature of 25°C.  
 LED circuit is isolated and requires external power source. Single element LED is colored in OFF state.  
 If the source voltage exceeds the rated voltage, a ballast resistor is required.  
 The resistor value can be calculated by using the formula in the Supplement section.

Bright AT633	Super Bright AT624G Blue	Super Bright AT629B White	Super Bright AT630F Green	T-1 Bi-pin	Note for Super Bright:	Bright			Super Bright			Unit
						5C	5D	5F	6B	6F	6G	
					(+) O — (LED) — O (-)	Red	Amber	Green	White	Green	Blue	
						30	30	25	30	30	30	mA
						20	20	20	20	20	20	mA
						1.85	2.0	2.2	3.6	3.5	3.6	V
						5	5	5	5	5	5	V
						0.40	0.42	0.38	0.50	0.50	0.50	mA/°C
						-25° ~ +50°C			-25° ~ +50°C			

## CAP TYPES & COLORS

### Colored Cap for Bright LEDs

Lens/Diffuser  
Colors Available:

- CB** Red/White
- DB** Amber/White
- FB** Green/White

**AT4168**  
Square

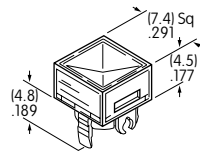

**AT4169**  
Round

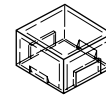
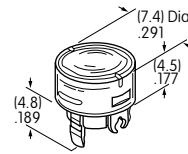

Transparent Colored Lens



Translucent White Diffuser



Colored LED AT633

Material: Polycarbonate Finish: Glossy

### White Cap for Bright & Super Bright LEDs

**JB** Clear Lens/  
White Diffuser

Material: Polycarbonate  
Finish: Glossy

**AT4033**  
Square

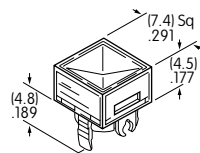

**AT4034**  
Round

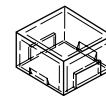
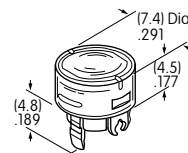

Transparent Clear Lens



Translucent White Diffuser



Colored LEDs AT624, AT629, AT630, or AT633

## TYPICAL INDICATOR DIMENSIONS

### Square

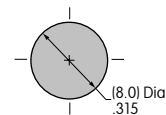
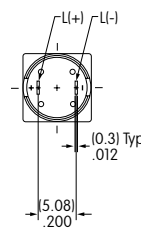
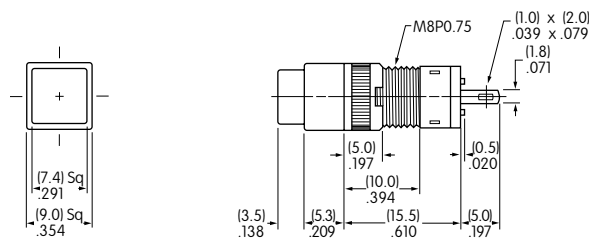

Recommended Panel Thickness: .020" ~ .197" (0.5 ~ 5.0mm)



HB01KW01-5C-CB

### Round

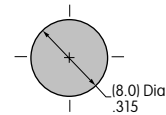
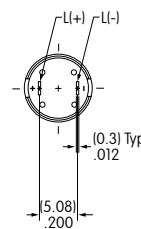
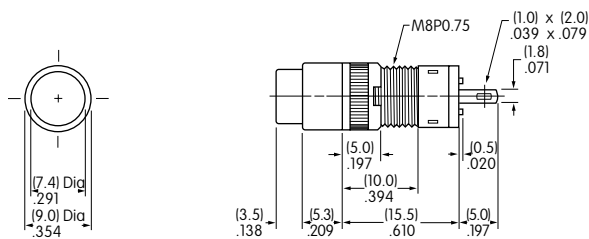

Recommended Panel Thickness: .020" ~ .197" (0.5 ~ 5.0mm)



HB02KW01-5C-CB