

## TYPICAL INDICATOR ORDERING EXAMPLE

**A**

**01**

**V**

**F**

MODELS	
<b>01</b>	Low .079" (2.0mm) Profile
<b>02</b>	High .291" (7.4mm) Profile

PC TERMINALS	
For 01 Model	
<b>P</b>	Straight
<b>B</b>	Straight with Bracket
<b>H</b>	Right Angle
<b>V</b>	Vertical
For 02 Model	
<b>P</b>	Straight

LED COLORS	
<b>C</b>	Red
<b>E</b>	Yellow
<b>F</b>	Green

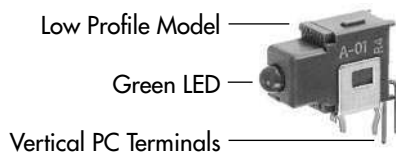

**A01VF**

### DESCRIPTION FOR TYPICAL ORDERING EXAMPLES

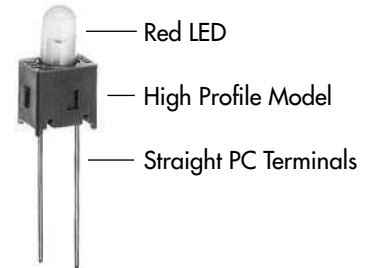

**A02PC**

## PC TERMINALS

**P**

**Straight**

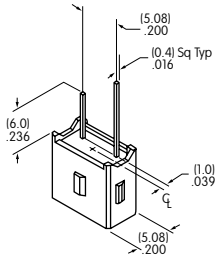

**B**

**Straight with Bracket**

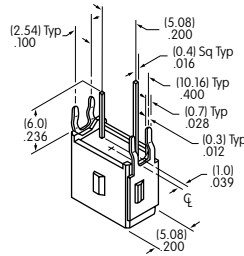

**H**

**Right Angle**

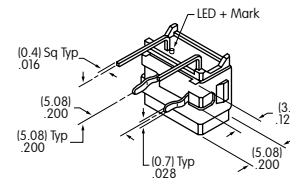

**V**

**Vertical**

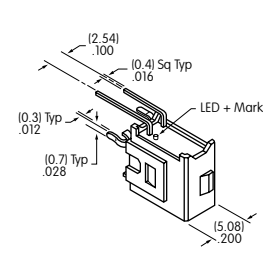

## LED COLORS & SPECIFICATIONS

Models	<b>A01</b> Indicator			<b>A02</b> Indicator			
	<b>C</b>	<b>E</b>	<b>F</b>	<b>C</b>	<b>E</b>	<b>F</b>	
LED is colored in OFF state	Color	Red	Yellow	Green	Red	Yellow	Green
Forward Peak Current	$I_{FM}$	50mA	50mA	50mA	25mA	30mA	30mA
Continuous Forward Current	$I_F$	30mA	30mA	30mA	20mA	20mA	20mA
Forward Voltage	$V_F$	1.7V	2.2V	2.1V	2.1V	2.1V	2.2V
Reverse Peak Voltage	$V_{RM}$	4V	4V	4V	4V	4V	4V
Current Reduction Rate Above 25°C	$\Delta I_F$	0.67mA/°C	0.67mA/°C	0.67mA/°C	0.33mA/°C	0.40mA/°C	0.40mA/°C
Ambient Temperature Range		-30°C ~ +85°C			-30°C ~ +85°C		

Electrical specifications are determined at a basic temperature of 25°C.

If the source voltage is greater than the LED's rated voltage, a ballast resistor must be connected in series with the LED.

The ballast resistor value can be calculated by using the formula shown in the Supplement section.

## TYPICAL INDICATOR DIMENSIONS

### Straight PC



A01PF

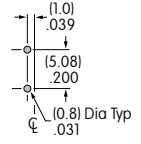
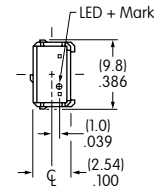
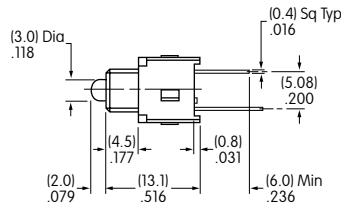
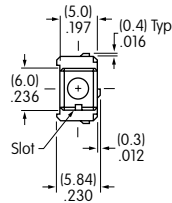

### Straight PC • Bracket



A01BF

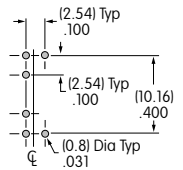
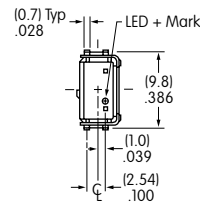
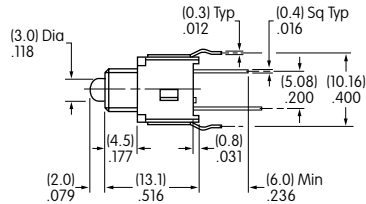
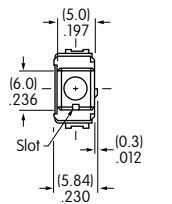

### Right Angle PC



A01HF

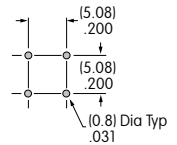
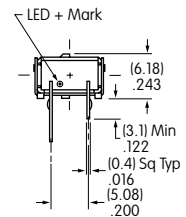
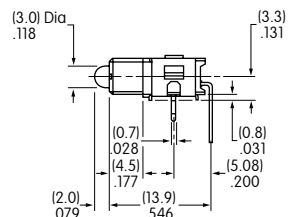
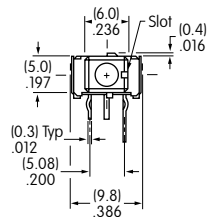

### Vertical PC



A01VF

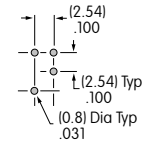
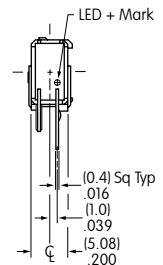
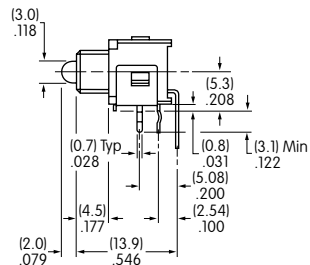
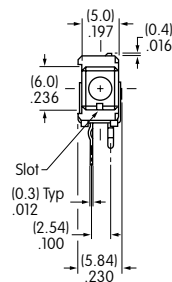

### Straight PC



A02PF

