

SAW FILTER FOR RKE

Murata part number :SAFDC312MSM0T00

Features

- Lead free component (RoHs compliant).
- Passivation layer :SiO₂
- AEC-Q200 Compliant

Package Dimensions

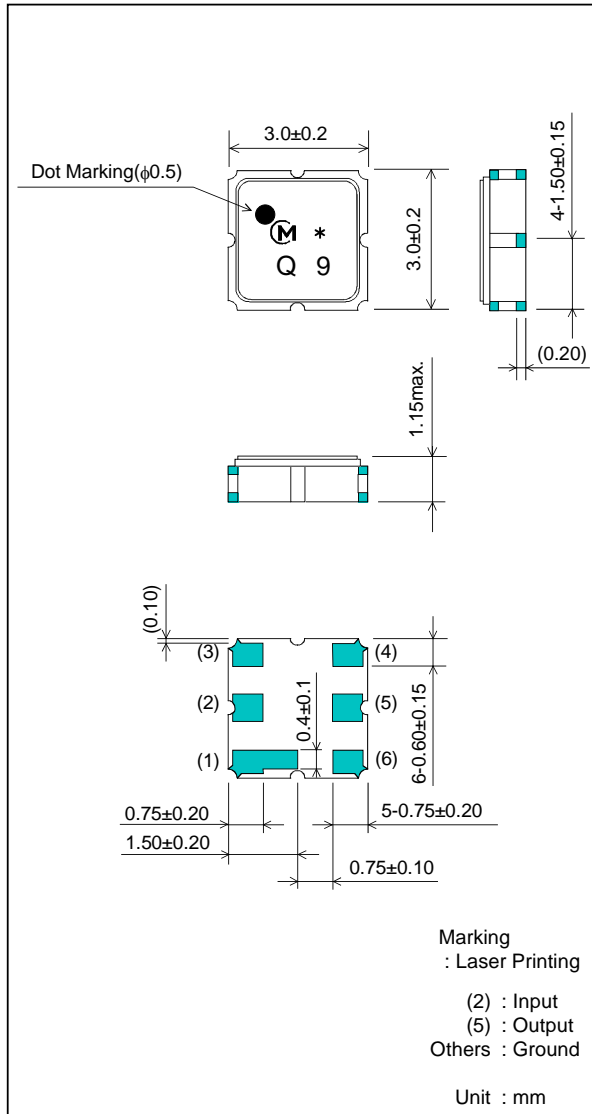

Specification

Item	Specification
	-40 to +85° C
Nominal Center Frequency(f_c)	312.15 MHz
Insertion Loss (311.8 to 312.5 MHz)	3.0 dB max.
Absolute Attenuation	
1) 268.4 to 269.7 MHz	55 dB min.
2) 290.1 to 291.1 MHz	50 dB min.
3) 301.1 to 301.8 MHz	30 dB min.
4) 322.5 to 323.2 MHz	20 dB min.
5) 333.2 to 334.2 MHz	50 dB min.
6) 354.6 to 355.9 MHz	55 dB min.
Ripple Deviation (311.8 to 312.5 MHz)	1.5 dB max.
VSWR (311.8 to 312.5 MHz)	1.8 max.
Input/Output Impedance (nominal)	50Ω
Input Signal Level	30mW (+14.8dBm), 1 minute 20mW (+13dBm), 1000 hours

SAW FILTER FOR RKE

Murata part number :SAFDC312MSM0T00

■ Frequency Performance Typical data at 25 +/-2degree

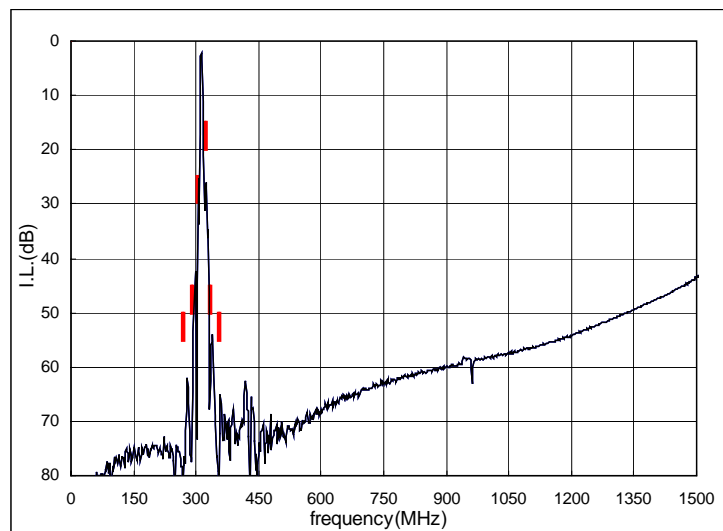
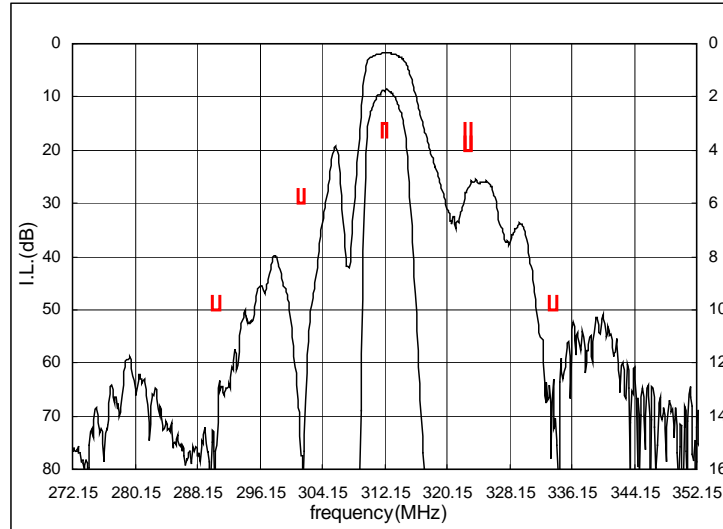

SAW FILTER FOR RKE

Murata part number :SAFDC312MSM0T00

■ Dimensions of Carrier Tape

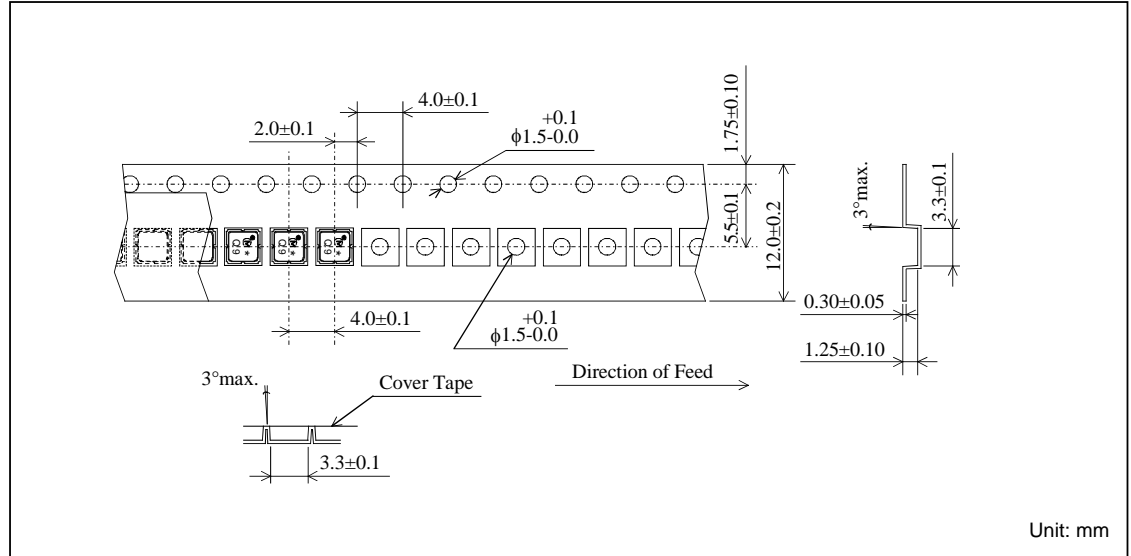

■ Dimensions of Tape

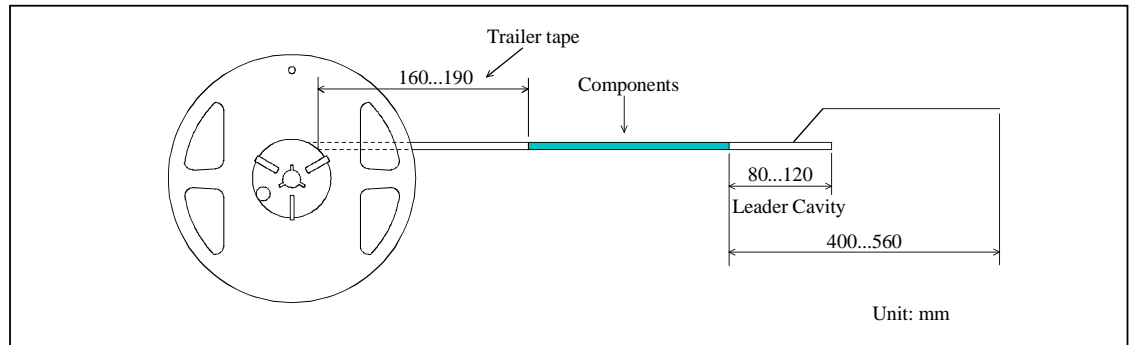

■ Dimensions of Reel

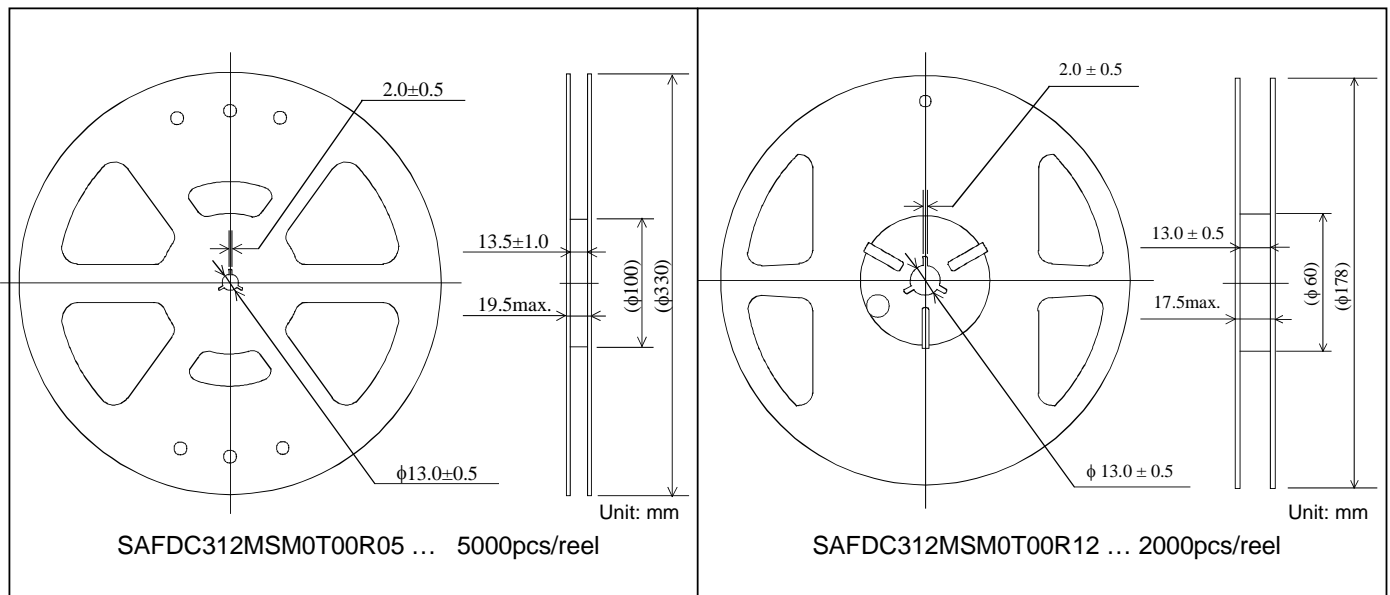

SAW FILTER FOR RKE

Murata part number :SAFDC312MSM0T00

Recommended Land Pattern

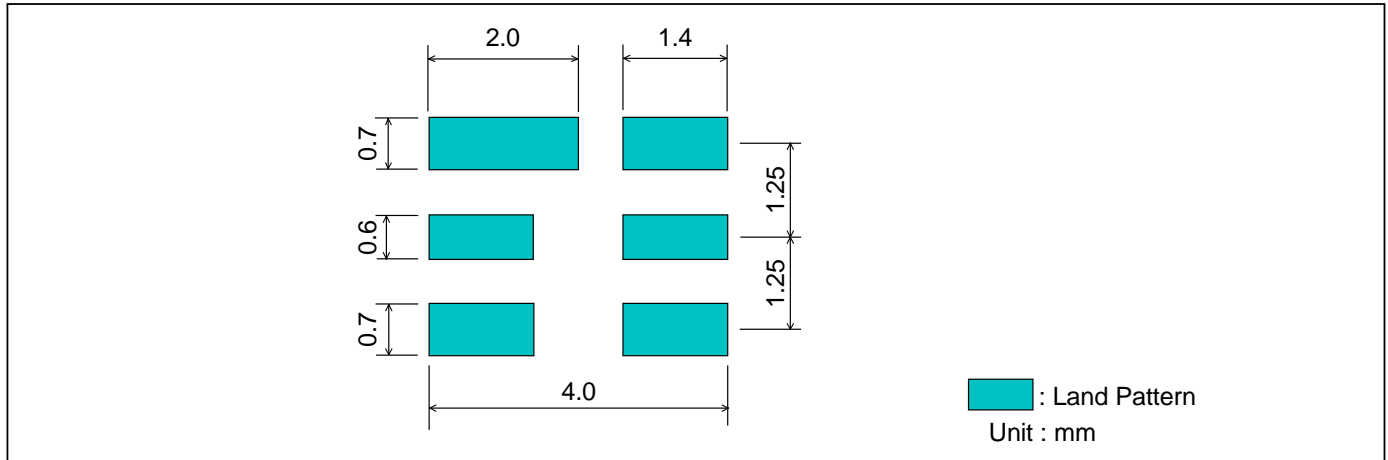

Test Circuit

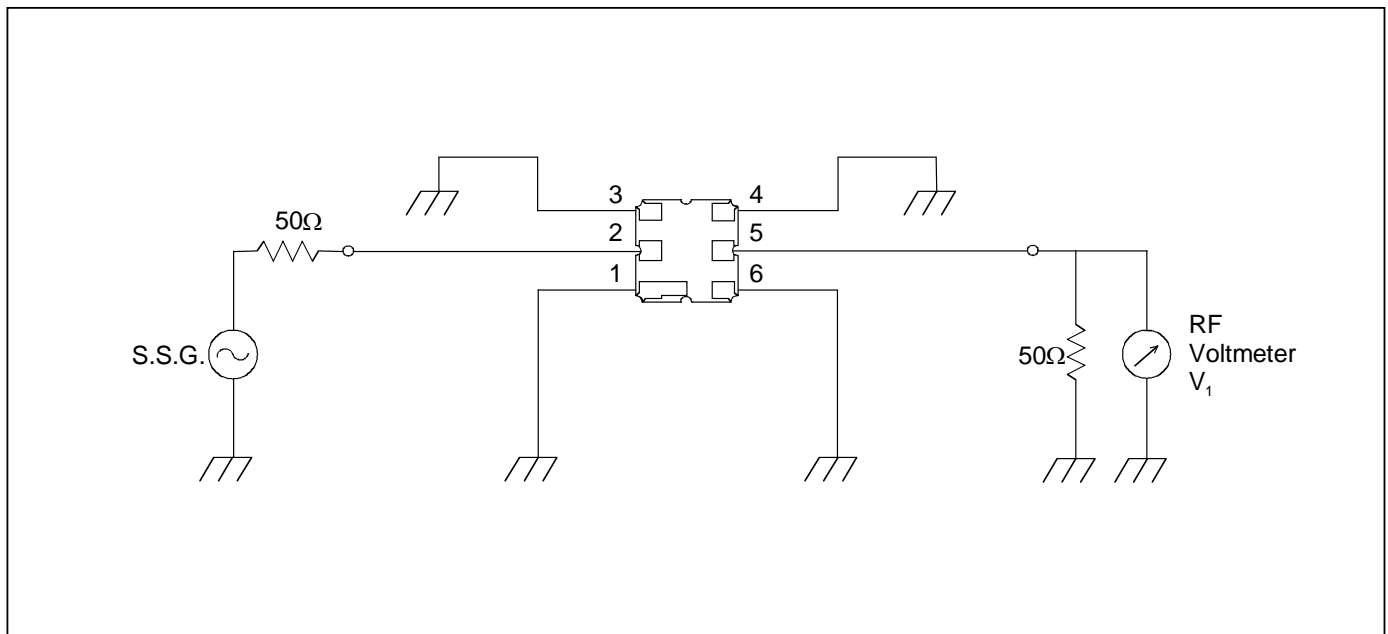

- This PDF Datasheet is downloaded from the website of Murata Manufacturing Co., Ltd. Therefore, it's specifications are subject to change or our products in it may be discontinued without advance notice. Please check with our sales representatives or product engineers before ordering.
- This PDF Datasheet has only typical specifications because there is no space for detailed specifications. Therefore, please approve our product specifications or transact the approval sheet for product specifications before ordering.