

PLEASE CHECK WWW.MOLEX.COM FOR LATEST PART INFORMATION

Part Number: [0353784810](#)
Status: **Active**
Description: 0.76/2.29mm (.030/090") Tab Wire-to-Wire Duomate Hybrid Female Housing, 48 Circuits

Documents:

[Drawing \(PDF\)](#) [RoHS Certificate of Compliance \(PDF\)](#)
[Product Specification PS-35376-001 \(PDF\)](#)

General

Product Family Crimp Housings
 Series 35378
 Product Name N/A

Physical

Circuits (maximum) 48
 Color - Resin Gray, Natural
 Gender Female
 Glow-Wire Compliant No
 Material - Resin Polyester
 Number of Rows 2
 Packaging Type Bag
 Panel Mount No
 Pitch - Mating Interface (in) 0.078 In, 0.141 In
 Pitch - Mating Interface (mm) 2.00 mm, 3.60 mm
 Stackable No
 Temperature Range - Operating -40°C to +85°C

Material Info

Reference - Drawing Numbers

Product Specification PS-35376-001
 Sales Drawing SD-35378-002

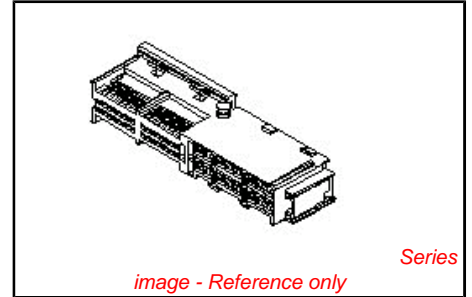

EU RoHS
ELV and RoHS
Compliant
REACH SVHC
 Not Reviewed
Halogen-Free
Status
Not Reviewed

China RoHS



Need more information on product environmental compliance?

Email productcompliance@molex.com
 For a multiple part number RoHS Certificate of Compliance, [click here](#)

Please visit the [Contact Us](#) section for any non-product compliance questions.

Search Parts in this Series
[35378Series](#)

Mates With
 35380

Use With
 35421 , 35442

PLEASE CHECK WWW.MOLEX.COM FOR LATEST PART INFORMATION

Dwg. No. SD35378-002
 SIMILAR ITEM
 PROJECT NO.
 DO NOT SCALE DRAWING
 DIMENSION IN METRIC

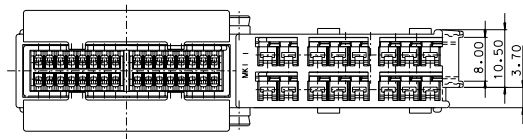
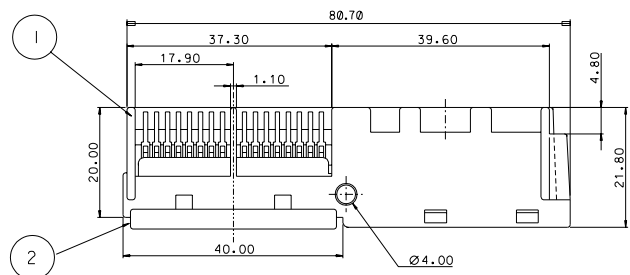
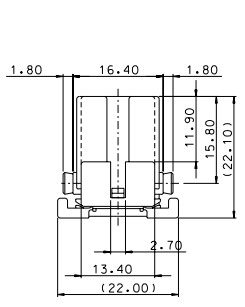
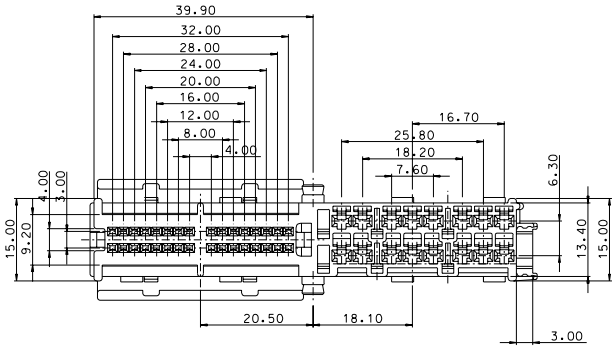

NO.	P/NAME	P/NO.	MATERIAL	Q'TY
①	DUOMATE HYBRID TYPE 48P FEMALE HOUSING	35378-4890	POLYESTER (PBT)	1
②	DUOMATE HYBRID TYPE 32P FEMALE TPA	35379-3235	POLYESTER (PBT)	1
③	DUOMATE HYBRID TYPE 16P FEMALE TPA	35388-1685	POLYESTER (PBT)	1

NOTES:

1. MATING TERMINAL PART NO:
 DUOMATE(Ø30)TYPE: 35442-1702
 UNICONN(Ø90)TYPE: 3535421-6702,35421-6802,35421-6902

2. MATING CONNECTOR PART NO: 35380-4810

3. TERMINAL RETENTION FORCE(COMBINED): 10KgF MIN.

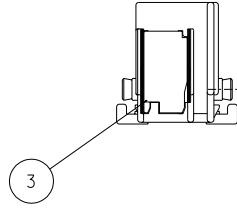

NEW RELEASE FC: MK, Y.SIK (MS/11/11) DRAWN: C.W.LEE CHKD: Y.SIK	DESCRIPTION MAJOR CRITICAL	GENERAL TOLERANCES: UNLESS SPECIFIED		SCALE	DESIGN UNITS	DIMENSIONS		SMT	REV
		(mm)	(INCH)	2/1	(mm)	(INCH)	(mm)	(INCH)	REVISE ON CAD ONLY
	4 PLACES	±0.1	±	DRAWN BY & DATE Y.SIK, KIM 96/11/11	THIRD ANGLE PROJECTION	TITLE DUOMATE HYBRID TYPE 48P FEMALE CONNECTOR ASS'Y			
	3 PLACES	±0.1	±	CHECKED BY & DATE B.K.CHOI 96/11/12		MATERIAL NO. MOLEX INCORPORATED KOREA			
	2 PLACES	±0.20	±	APPROVED BY & DATE C.W.LEE 96/11/12		DRAWING NO. SD35378-002			SHEET NO. 1/1
	1 PLACE	±0.1	±	CAD FILE NAME s3537848.dgn		MATERIAL NO. 35378-002			SIZE C
DRAFT WHERE APPLICABLE MUST REMAIN WITHIN DIMENSIONS		THIS DRAWING CONTAINS INFORMATION THAT IS PROPRIETARY TO MOLEX INCORPORATED AND SHOULD NOT BE USED WITHOUT WRITTEN PERMISSION.							