

Dimensions:mm

- A:5.0(Max)
- B:5.0(Max)
- C:2.0(Max)
- D:6.9 (Max)
- E:3.3 (REF)
- F:1.50(REF)

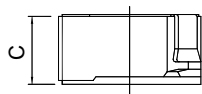

Electrical characteristics

Part No.	Inductance	TESTING	DC	RATED DC CURRENT (A)Max
	L (uH)	FREQ (KHZ)	RESISTANCE (OHM)Max	
CDH4D18N-1R0□	1.0	100	35M	1.72
CDH4D18N-2R2□	2.2	100	58M	1.32
CDH4D18N-2R7□	2.7	100	80M	1.28
CDH4D18N-3R3□	3.3	100	85M	1.04
CDH4D18N-3R9□	3.9	100	120M	0.88
CDH4D18N-4R7□	4.7	100	125M	0.84
CDH4D18N-5R6□	5.6	100	145M	0.80
CDH4D18N-6R8□	6.8	100	170M	0.76
CDH4D18N-8R2□	8.2	100	190M	0.68
CDH4D18N-100□	10.0	100	200M	0.61
CDH4D18N-120□	12.0	100	210M	0.56
CDH4D18N-150□	15.0	100	240M	0.50
CDH4D18N-180□	18.0	100	338M	0.48
CDH4D18N-220□	22.0	100	397M	0.41
CDH4D18N-270□	27.0	100	441M	0.35
CDH4D18N-330□	33.0	100	694M	0.32
CDH4D18N-390□	39.0	100	709M	0.30

□:M=±20% P=±30%