



ALL RIGHTS RESERVED. NO PORTION OF THIS PUBLICATION, WHETHER IN WHOLE OR IN PART, CAN BE REPRODUCED WITHOUT THE EXPRESS WRITTEN CONSENT OF SPC TECHNOLOGY.

SPC-F005.DWG

REVISIONS

DOC. NO. SPC-F005 * Effective: 7/8/02 * DCP No: 1398

DCP #	REV	DESCRIPTION	DRAWN	DATE	CHECKD	DATE	APPRVD	DATE
2000	A	Released	JN	01/14/09	JWM	01/14/09	JWM	01/14/09

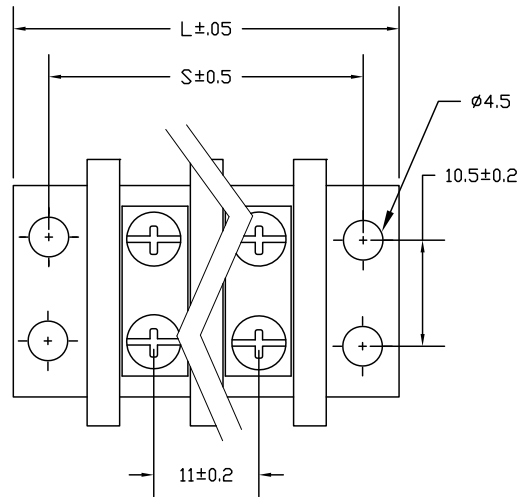
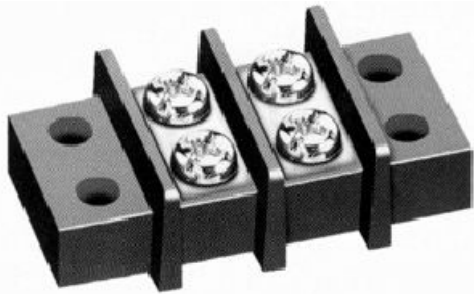

Description:

- Terminal: Brass, Tin Plated
- Insulator body: PC, Black
- Screw: steel, Ni Plated
- Operation Temperatures: -40°C ~ +105°C
- Rated current: 25Amp, AC300V
- Insulation withstands volt: AC2000V min
- Insulation resistance: >2000M Ω DC500V

Mfg. P/N	Number of Poles	L (mm)	S (mm)
MC24327	2	41.2	32.4
MC24328	4	63.4	54.6
MC24329	5	74.5	65.7
MC24330	6	85.6	76.8
MC24331	8	107.8	99
MC24332	10	130	121.2
MC24333	12	152.2	143.4
MC24334	20	241	232.2

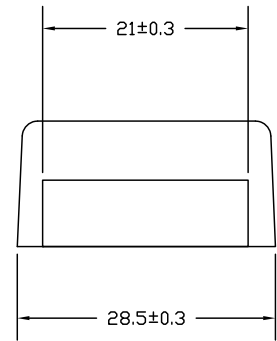
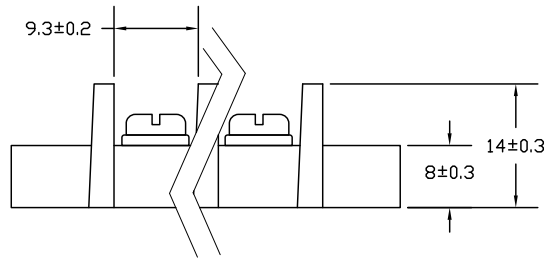

DISCLAIMER:
ALL STATEMENTS AND TECHNICAL INFORMATION CONTAINED HEREIN ARE BASED UPON INFORMATION AND/OR TESTS WE BELIEVE TO BE ACCURATE AND RELIABLE. SINCE CONDITIONS OF USE ARE BEYOND OUR CONTROL, THE USER SHALL DETERMINE THE SUITABILITY OF THE PRODUCT FOR THE INTENDED USE AND ASSUME ALL RISK AND LIABILITY WHATSOEVER IN CONNECTION THEREWITH.

TOLERANCES:

UNLESS OTHERWISE SPECIFIED, DIMENSIONS ARE FOR REFERENCE PURPOSES ONLY.

DRAWN BY:	DATE:
Jason Nash	01/14/09
CHECKED BY:	DATE:
JWM	01/14/09
APPROVED BY:	DATE:
JWM	01/14/09

DRAWING TITLE:

TERMINAL BLOCK

SIZE	DWG. NO.	ELECTRONIC FILE	REV
A	Ta-1150	TA-1150.DWG	A
SCALE: NTS	U.O.M.: INCHES [mm]	SHEET: 1 OF 1	