

# SEMS SCREW TERMINALS

15 AMP

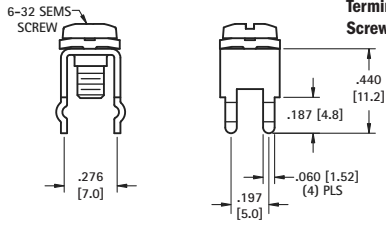

**SNAP-IN  
PC MOUNT**



**SPECIFICATIONS**

**Terminal:** .032 (.81) Brass, Matte Tin Plate  
**Screw & Washer:** Steel, Nickel Plate

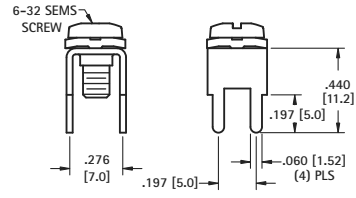

**PC MOUNT**

**CAT. NO. 7691-SEMS** (Screw Supplied Unassembled)

**CAT. NO. 7693-SEMS** (Screw Installed & Captivated)

**CAT. NO. 8191-SEMS** (Screw Supplied Unassembled)

**CAT. NO. 7701-SEMS** (Screw Installed & Captivated)



**SNAP-IN  
PC MOUNT**

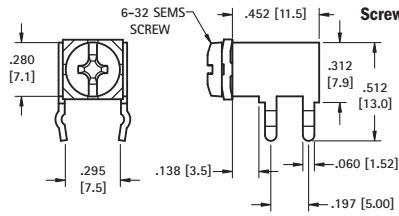

**SPECIFICATIONS**

**Terminal:** .032 (.81) Brass, Matte Tin Plate  
**Screw & Washer:** Steel, Nickel Plate

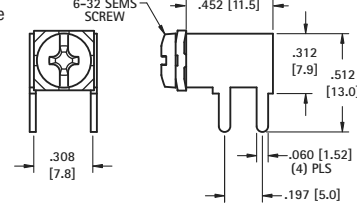

**PC MOUNT**

**CAT. NO. 7690-SEMS** (Screw Supplied Unassembled)

**CAT. NO. 7692-SEMS** (Screw Installed & Captivated)

**CAT. NO. 8190-SEMS** (Screw Supplied Unassembled)

**CAT. NO. 7700-SEMS** (Screw Installed & Captivated)



**SNAP-IN  
PC MOUNT**

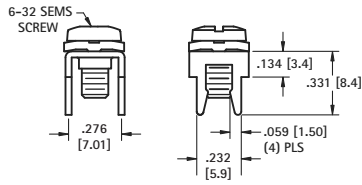

**SPECIFICATIONS**

**Terminal:** .032 (.81) Brass, Matte Tin Plate  
**Screw & Washer:** Steel, Nickel Plate

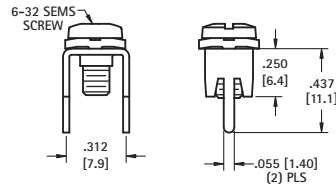

**PC MOUNT**

**CAT. NO. 8195-SEMS** (Screw Supplied Unassembled)

**CAT. NO. 7775-SEMS** (Screw Installed & Captivated)

**CAT. NO. 8198-SEMS** (Screw Supplied Unassembled)

**CAT. NO. 7778-SEMS** (Screw Installed & Captivated)



**PC MOUNT**

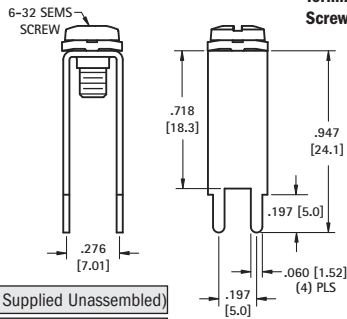

**SPECIFICATIONS**

**Terminal:** .032 (.81) Brass, Matte Tin Plate  
**Screw & Washer:** Steel, Nickel Plate

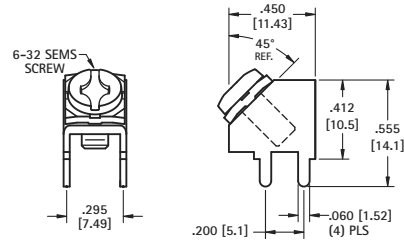

**PC MOUNT**

**CAT. NO. 7697-SEMS** (Screw Supplied Unassembled)

**CAT. NO. 7699-SEMS** (Screw Installed & Captivated)

**CAT. NO. 8189-SEMS** (Screw Supplied Unassembled)

**CAT. NO. 7702-SEMS** (Screw Installed & Captivated)

30 AMP



**SNAP-IN  
PC MOUNT**

**SPECIFICATIONS**

**Terminal:** .032 (.81) Brass, Matte Tin Plate  
**Screw & Washer:** Steel, Nickel Plate

**CAT. NO. 8197-SEMS** (Screw Supplied Unassembled)

**CAT. NO. 8199-SEMS** (Screw Installed & Captivated)

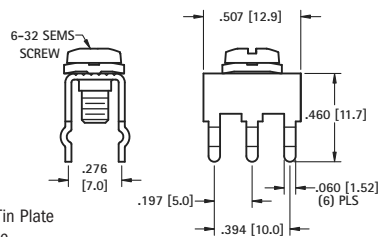

SEMS Screw Terminals provide quick and secure attachment of wire leads. SEMS screw has captivated, free spinning lock washer, eliminated twisting of wire when tightening lead to terminal. Washer will rise with head of screw when unscrewed.

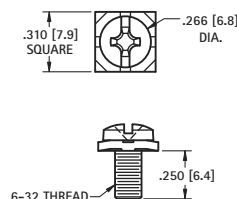

**SPECIFICATIONS**

**Screw & Washer:** Steel, Nickel Plate

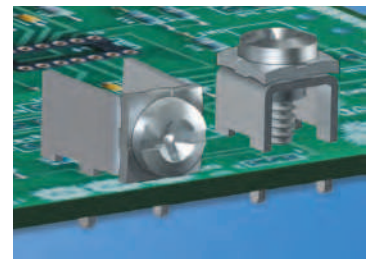

**CAT. NO. 9920** (SEMS Screw Only)