

LTR	EN	DESCRIPTION	APPR	BY	DATE
A	-	INITIAL RELEASE	RB	NH	12-18-03

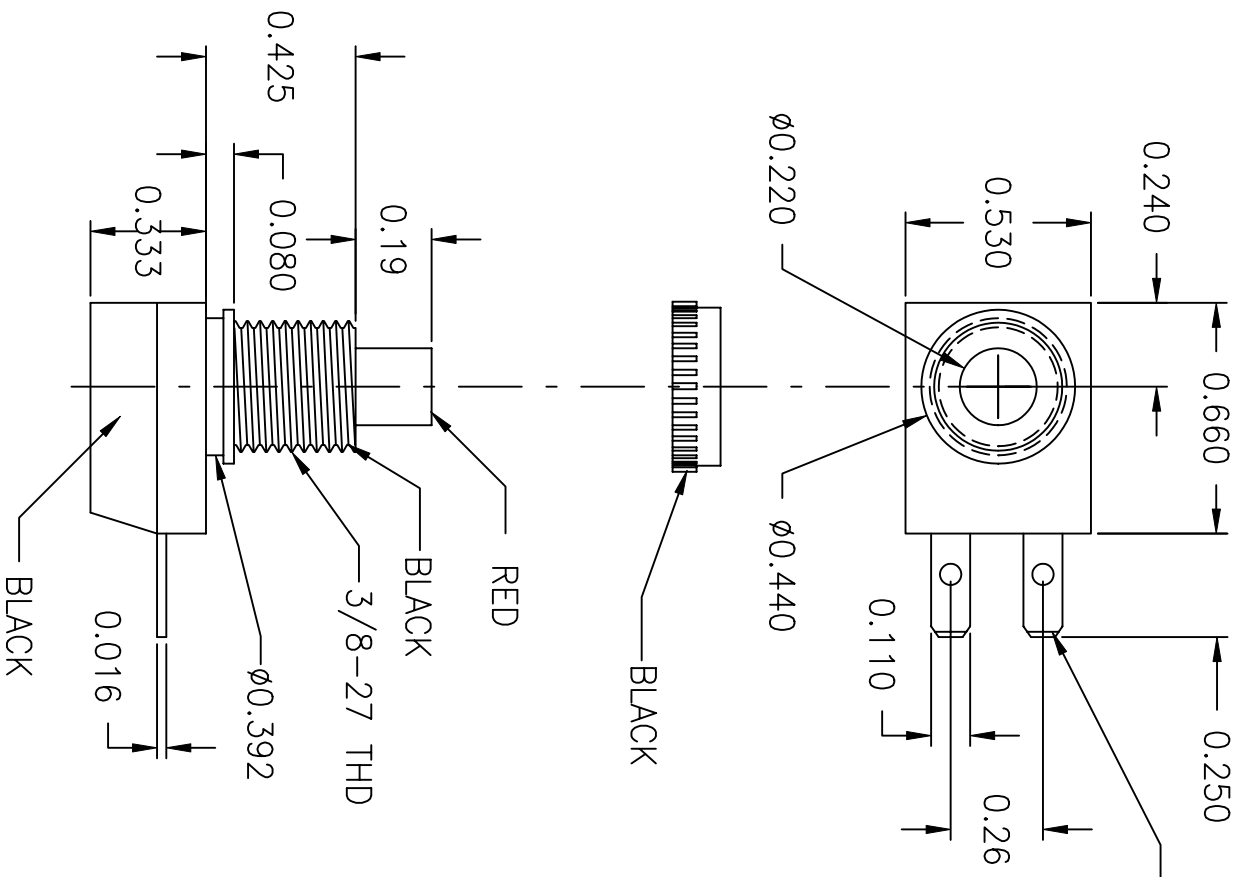

JUDCO INVENTORY NO. 40-3437-02
 SWITCH TYPE: MOMENTARY, NORMALLY CLOSED
 NUTS PACKED SEPARATELY.

CUSTOMER: DIGI-KEY
 APPROVED BY: _____
 DATE: _____

DIMENSIONS IN INCHES DIMENSIONS ARE REFERENCE		
TITLE HARBOR CITY CALIFORNIA OUTLINE J-188A-3		
DRAWN: NH	12-18-03	DWG. NO. 1415-528
APPR: KJ	12-18-03	SHEET 1 OF 1
1415US28A.DWG		

This document embodies a product, component, and/or design proprietary to JUDCO MANUFACTURING INC., and which is protected either as a trade secret, by U.S. Patent, or by copyright. It may not be used in any way without written express consent of JUDCO MANUFACTURING INC.