

SERIES 100

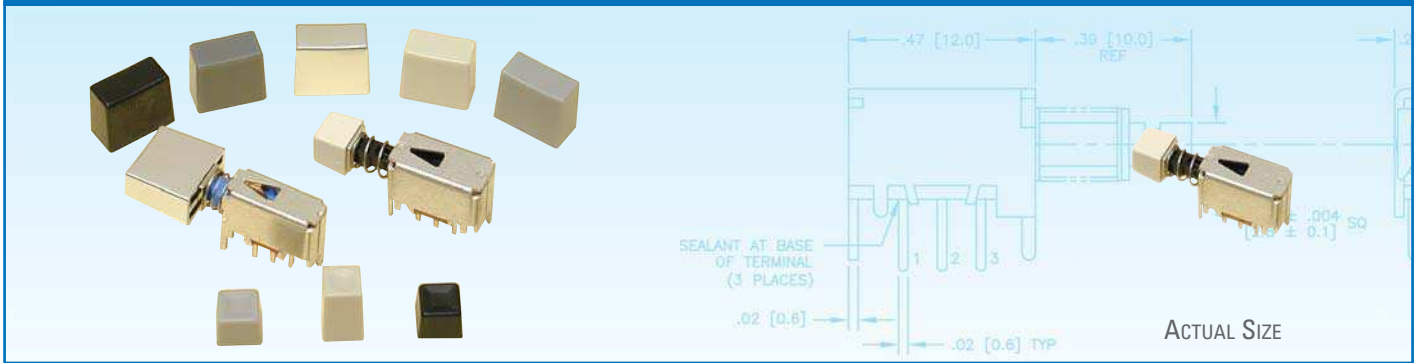

RIGHT ANGLE MINIATURE PUSHBUTTON SWITCH

The Series 100 right angle miniature pushbutton switch is available in momentary or self-lock (maintained) action with a variety of keycap styles and colors. Ideal for high volume, low-cost electrical applications.

KEY FEATURES:

- Momentary or self-lock (maintained) operation
- Single or double pole
- PCB terminals
- Silver contacts

TYPICAL APPLICATIONS:

- Toys
- Consumer electronics
- Telcom/Datacom products
- Test and measurement
- Medical

ORDERING INFORMATION:

Switch

Part Number	Switch Action	Circuit	Actuator Color
100-510-501	Momentary	DPDT	Black
100-510-502	Self-Lock (maintained)	DPDT	Blue
100-510-507	Self-Lock (maintained)	SPDT	Blue
100-510-508	Momentary	SPDT	Black

Keycaps

Part Number	Color*	Keycap Style
55-002-230	Black	Rectangular
55-002-231	Light Grey	Rectangular
55-002-232	Dark Grey	Rectangular
55-002-233	White	Rectangular
55-002-234	Bright Chrome	Rectangular
55-002-235	Satin Chrome	Rectangular
55-002-091	Sand	Large Square
80-397010	Light Grey	Small Square
80-397012	Black	Small Square
80-397013	White	Small Square

*For other colors, please consult factory.

STANDARDS / AGENCY / RATINGS:



Contact an Authorized Distributor
or Factory for Pricing

SERIES 100—RIGHT ANGLE MINIATURE PUSHBUTTON SWITCH

SWITCHES:

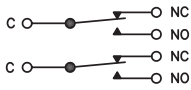

SCHEMATIC

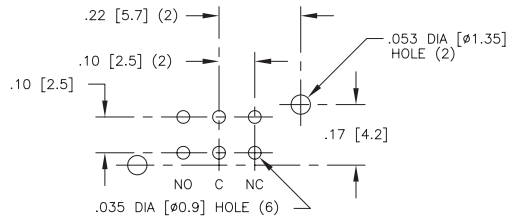

RECOMMENDED PCB HOLE PATTERN

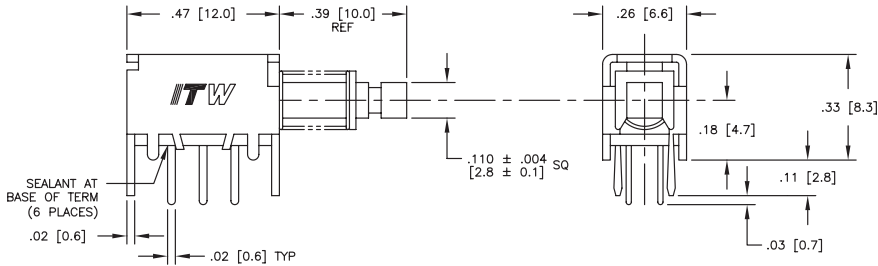

100-510-501 & -502



SCHEMATIC

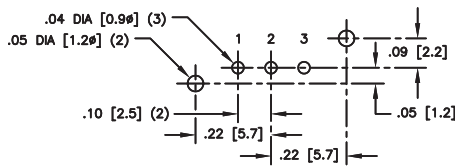

RECOMMENDED PCB HOLE PATTERN

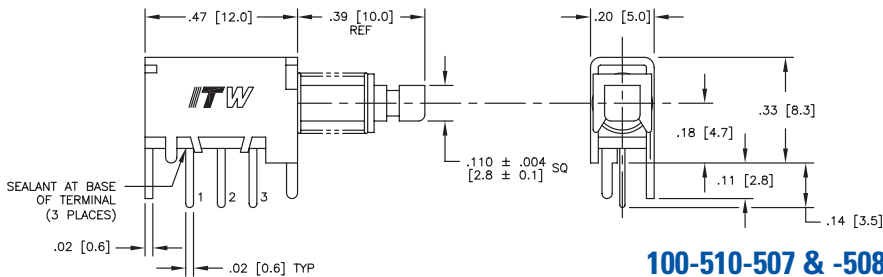

100-510-507 & -508

KEYCAPS:

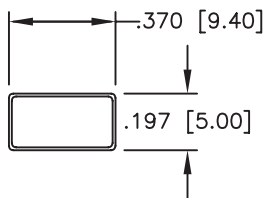

RECTANGULAR

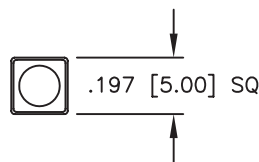

LARGE SQUARE

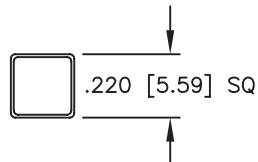

SMALL SQUARE

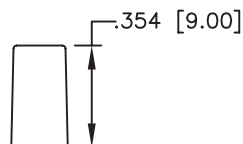
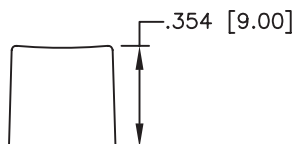

ITW Switches

7301 W. Ainslie Street
Harwood Heights, IL 60706

800.544.3354

708.667.3770

708.667.3440 (Fax)

www.itwswitches.com

customer_service@itwswitches.com

Contact an Authorized Distributor
or Factory for Pricing