

# Customer Information Sheet

DRAWING No.: M22-636XXXX SHEET 2 OF 2 IF IN DOUBT - ASK © NOT TO SCALE THIRD ANGLE PROJECTION ALL DIMENSIONS IN mm

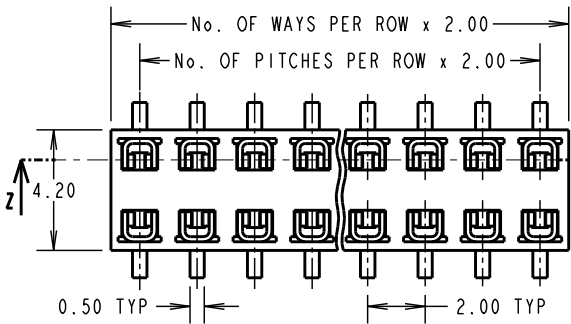

**SPECIFICATION:**  
 MATERIAL = 30% GLASS FILLED NYLON 6T UL94V-0  
 CONTACTS = PHOSPHOR BRONZE  
 FINISH: (OVER NICKEL)  
 42 = 0.02 - 0.08µ GOLD ON CONTACT AREA  
 2.5 - 3.8µ 100% TIN ON TAILS  
 46 = 2.5 - 3.8µ 100% TIN  
**ELECTRICAL:**  
 CURRENT RATING = 1.5 AMPS  
 CONTACT RESISTANCE = 20 MILLIOHMS MAX  
 INSULATION RESISTANCE = 1000 MEGAOHMS MIN  
 DIELECTRIC WITHSTANDING = 500V AC MIN

**MECHANICAL:**  
 CONTACT RETENTION = 4.9N MIN  
 INSERTION FORCE = 2.0N MAX  
 WITHDRAWAL FORCE = 0.30N MIN  
**ENVIRONMENTAL:**  
 TEMPERATURE RANGE = -55°C TO +105°C  
**PACKING:**  
 TUBE  
 FOR COMPLETE SPECIFICATION, SEE COMPONENT SPECIFICATION C018XX (LATEST ISSUE).

RECOMMENDED PCB LAYOUT

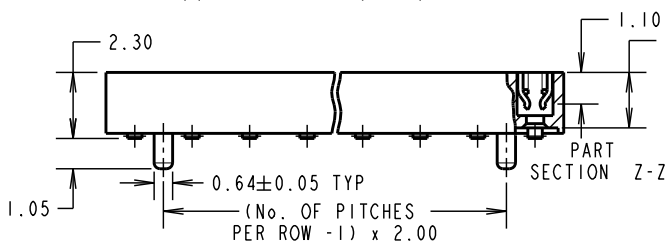

No. OF PITCHES PER x 2.00 ±0.10  
 (No. OF PITCHES PER ROW - 1.00) x 2.00

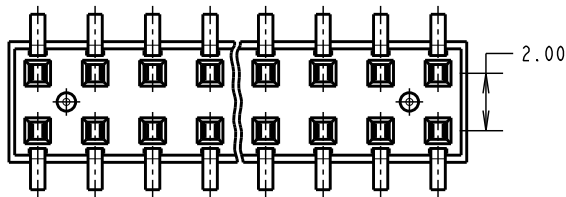
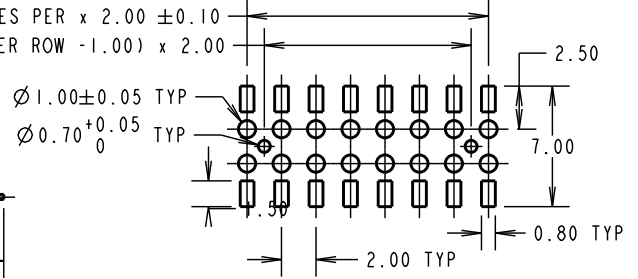
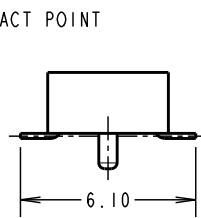

NOTES:  
 1. ALL TOLERANCES ARE ±0.20 UNLESS OTHERWISE STATED.

ORDER CODE:  
**M22-636XXXX**  
 No. OF WAYS PER ROW  
 02 TO 32  
 FINISH:  
 42 - SELECTIVE GOLD + 100% TIN  
 46 - 100% TIN OVER NICKEL

RA	8	10.05.11	11266
NAME	ISS.	DATE	C/NOTE
APPROVED: R. ADDE			
CHECKED: M.G. PLESTED			
DRAWN: D. BECK			
CUSTOMER REF.:			
ASSEMBLY DRG:			

**HARWIN**

HARWIN USA  
 TEL: 603 893 5376  
 FAX: 603 893 5396  
 mis@harwin.com

HARWIN Europe (UK)  
 TEL: 023 9231 4545  
 FAX: 023 9231 4590  
 mis@harwin.co.uk

HARWIN Asia  
 TEL: +65 6 779 4909  
 FAX: +65 6 779 3868  
 mis@harwin.com.sg

THIS DRAWING AND ANY INFORMATION OR DESCRIPTIVE MATTER SET OUT HEREON ARE CONFIDENTIAL AND COPYRIGHT PROPERTY OF THE HARWIN GROUP AND MUST NOT BE DISCLOSED, LOANED, COPIED OR USED FOR MANUFACTURING, TENDERING OR FOR ANY OTHER PURPOSE WITHOUT THEIR WRITTEN PERMISSION.

**TOLERANCES**  
 X. = ±1mm  
 X.X = ±0.25mm  
 X.XX = ±0.10mm  
 X.XXX = ±0.01mm  
 ANGLES = ±5°  
 UNLESS STATED

**MATERIAL:**  
 SEE ABOVE

**FINISH:**

**S/AREA:** mm<sup>2</sup>

**TITLE:**  
 2mm PITCH DIL SMT VERTICAL  
 LOW PROFILE SOCKET ASSEMBLY

**DRAWING NUMBER:**  
**M22-636XXXX**

SHT 2 OF 2