

RECOMMENDED PCB LAYOUT

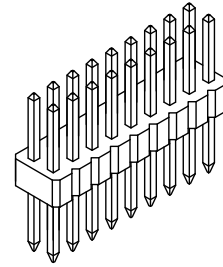
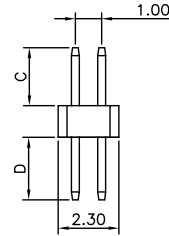

| CONTACTS | DIMENSIONS | |
|----------|------------|-------|
| | A | B |
| 4 | 1.00 | 2.00 |
| 6 | 2.00 | 3.00 |
| 8 | 3.00 | 4.00 |
| 10 | 4.00 | 5.00 |
| 12 | 5.00 | 6.00 |
| 14 | 6.00 | 7.00 |
| 16 | 7.00 | 8.00 |
| 18 | 8.00 | 9.00 |
| 20 | 9.00 | 10.00 |
| 22 | 10.00 | 11.00 |
| 24 | 11.00 | 12.00 |
| 26 | 12.00 | 13.00 |
| 28 | 13.00 | 14.00 |
| 30 | 14.00 | 15.00 |
| 32 | 15.00 | 16.00 |
| 34 | 16.00 | 17.00 |
| 36 | 17.00 | 18.00 |
| 38 | 18.00 | 19.00 |
| 40 | 19.00 | 20.00 |
| 42 | 20.00 | 21.00 |
| 44 | 21.00 | 22.00 |
| 46 | 22.00 | 23.00 |
| 48 | 23.00 | 24.00 |
| 50 | 24.00 | 25.00 |
| 52 | 25.00 | 26.00 |
| 54 | 26.00 | 27.00 |
| 56 | 27.00 | 28.00 |
| 58 | 28.00 | 29.00 |
| 60 | 29.00 | 30.00 |
| 62 | 30.00 | 31.00 |
| 64 | 31.00 | 32.00 |
| 66 | 32.00 | 33.00 |
| 68 | 33.00 | 34.00 |
| 70 | 34.00 | 35.00 |
| 72 | 35.00 | 36.00 |
| 74 | 36.00 | 37.00 |
| 76 | 37.00 | 38.00 |
| 78 | 38.00 | 39.00 |
| 80 | 39.00 | 40.00 |

Ordering Grid: BC035-XX-X-XXXX-XXXX-L-X

No. of Contacts: 04 to 80
 Contact Plating: A = Gold Flash All Over, C = Tin All Over
Standard = Gold Flash All Over

Packing Options: G = Plastic Box (Standard), D = Tube, E = Tube with Cap
 Insulator Material: L = LCP (Standard)
 Dimension D (1/100mm) (Tail Length): Standard - 3.00mm = 0300, or specify Dimension D e.g. 2.50mm = 0250, Tol +/- 0.2mm

SPECIFICATIONS 规格:

CURRENT RATING 电流额定值: 1 AMP
 INSULATOR RESISTANCE 绝缘电阻值: 1000 MEGOHMS MIN.
 DIELECTRIC WITHSTANDING 耐电压: AC 300 V
 CONTACT RESISTANCE 接触电阻值: 20mΩ Max.
 OPERATING TEMPERATURE 工作温度: -40° C TO +105° C
 CONTACT MATERIAL 端子物料: COPPER ALLOY
 INSULATOR MATERIAL 绝缘体物料: STANDARD 标准物料: POLYESTER 聚酯, LCP, UL 94-V0
 SOLDERING PROCESS 可焊性: LCP (STANDARD 标准物料) - IR REFLOW 回流焊: 260° C for 10 sec. △, WAVE 波峰焊: 250° C for 5-10 sec, MANUAL SOLDER 人工焊接: 350° C for 3-5 sec △
 MATES WITH 配套之母座 (SUBJECT TO PIN LENGTH 在端子长度适合的条件下): BC084 BC085

| By | ASE | GG | SA | SA |
|----------|-----------------|------------------------------------|----------------------------------|------------------------------|
| DETAIL | DRAWING RELEASE | CHANGE TO SOLDER TEMP. INFORMATION | AMENDMENT TO STANDARD DIMENSIONS | AMENDMENT TO PLATING OPTIONS |
| REV DATE | A 20/05/08 | B 23/07/09 | C 08/12/09 | D 21/12/09 |



| Tolerances (except as noted) | Part Number:- | Date:- |
|--|---|-----------|
| Dimensions in mm X ± 0.30 X* ± 5° X.X ± 0.25 X* ± 3° X.XX ± 0.15 XX* ± 2° X.XXX ± 0.10 XXX* ± 1° | BC035 | 20 MAY 08 |
| Third Angle Projection | Description:- 1.0mm PITCH PIN HEADER, DUAL ROW, THROUGH HOLE, VERTICAL | |
| THIS DRAWING IS CONFIDENTIAL AND MUST NOT BE COPIED OR DISCLOSED WITHOUT WRITTEN CONSENT | | |



www.globalconnectortech.com

| Scale | Revision | Material | Drawn by | Sheet No. |
|-------|----------|----------|----------|------------|
| NTS | D | See Note | ASE | E & OE 1/1 |