



# Frontier Electronics Corp.

667 E. COCHRAN STREET, SIMI VALLEY, CA 93065

TEL: (805) 522-9998 FAX: (805) 522-9989

E-mail: frontiersales@frontierusa.com

Web: frontierusa.com

## SMD Power Choke—CSS0628P series

### A. Electrical specifications:

Part No.	Mark	L (uH) ± 30%	Test Freq.	DCR (max) (mΩ)	I rms. (A)
CSS0628P-3R0	3R0	3.0	10KHz	24	3.00
CSS0628P-3R9	3R9	3.9	10KHz	27	2.60
CSS0628P-5R0	5R0	5.0	10KHz	31	2.40
CSS0628P-6R0	6R0	6.0	10KHz	35	2.25
CSS0628P-7R3	7R3	7.3	10KHz	54	2.10
CSS0628P-8R6	8R6	8.6	10KHz	58	1.85
CSS0628P-100	100	10	10KHz	65	1.70
CSS0628P-120	120	12	10KHz	70	1.55
CSS0628P-150	150	15	10KHz	84	1.40
CSS0628P-180	180	18	10KHz	95	1.32
CSS0628P-220	220	22	10KHz	128	1.20
CSS0628P-270	270	27	10KHz	142	1.05
CSS0628P-330	330	33	10KHz	165	0.97
CSS0628P-390	390	39	10KHz	210	0.86
CSS0628P-470	470	47	10KHz	238	0.80
CSS0628P-560	560	56	10KHz	277	0.73
CSS0628P-680	680	68	10KHz	304	0.65
CSS0628P-820	820	82	10KHz	390	0.60
CSS0628P-101	101	100	10KHz	535	0.54

### B. Mechanical dimensions: (Unit: mm)

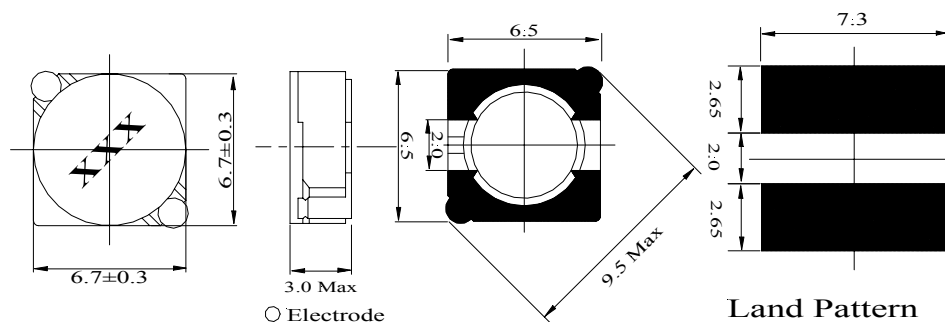

**Type 2: Shielded**

### C. Features:

1. Tolerance: N: ± 30%, M: ± 20%.
2. Operating temperature: -25°C to +85°C.
3. Inductance measured on the HP4284A LCR meter.
4. DCR measured on the 502BC milli-ohm meter.
5. Inductance drops no more than 35% at rated current applied or temperature rise  $\Delta t < 30^\circ\text{C}$ .
6. Inductance and Current range:
  - a.) CSS0638P-series: From 3.0μH (3.0A) to 100μH (0.54A).

**Note: RoHS compliant; for the ROHS parts, we add “-LFR” at the end of the P/N.**



# Frontier Electronics Corp.

667 E. COCHRAN STREET, SIMI VALLEY, CA 93065  
TEL: (805) 522-9998 FAX: (805) 522-9989  
E-mail: frontiersales@frontierusa.com  
Web: frontierusa.com

## SMD Power Choke—CSS0628P series

### D. Characteristic curve:

#### 1. L vs. Frequency:

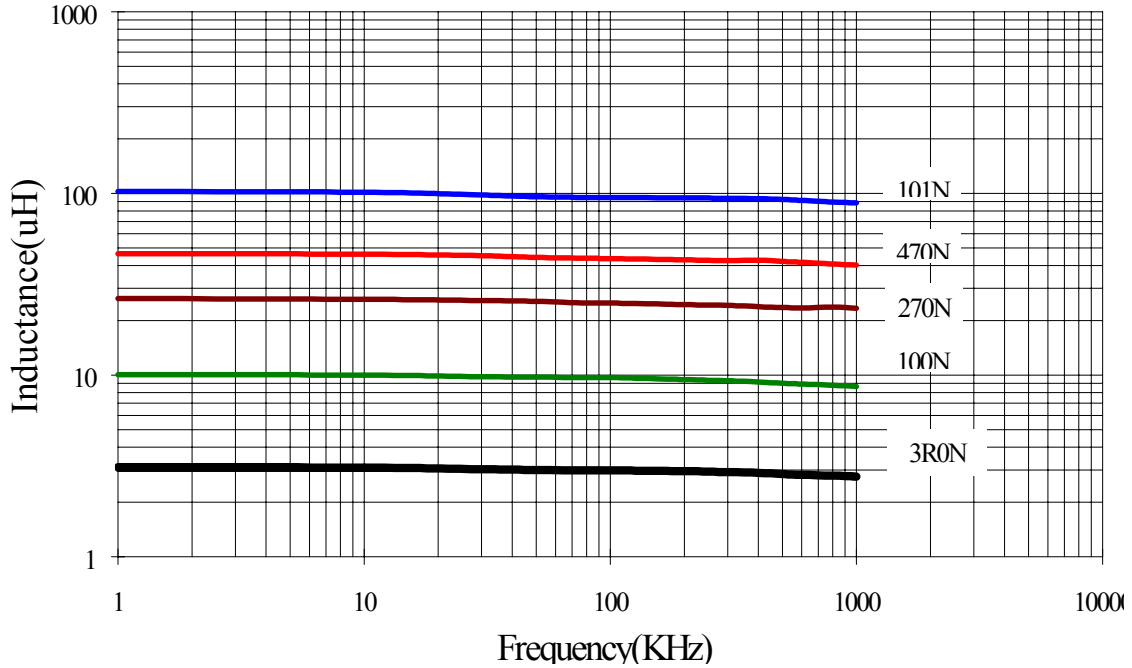

#### 2. Typical L vs. DC Current:

