

Tous droits strictement réservés. Reproduction ou communication a des tiers interdite sous quelque forme que ce soit sans autorisation écrite du propriétaire. Propriété de FCI. Droits de reproduction FCI.

All rights strictly reserved. Reproduction or issue to third parties in any form whatever is not permitted without written authority from the proprietor. Property of FCI. Copyright FCI.

**FCI**

PRODUCT NO.10035690-XXX-3W

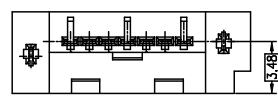
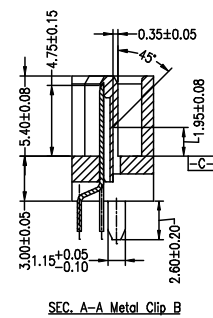
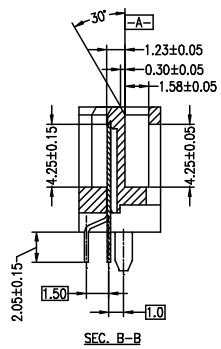
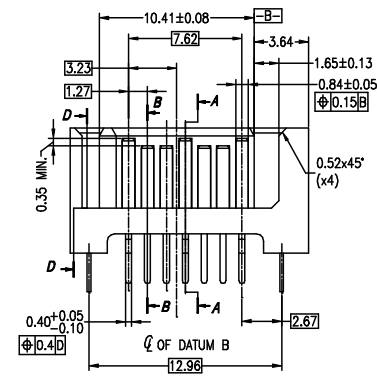
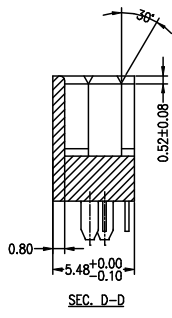
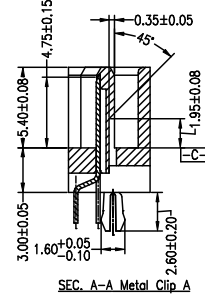
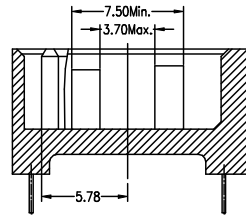
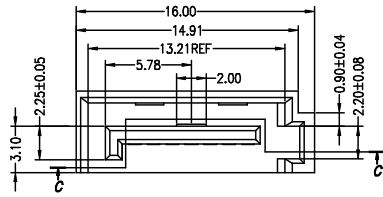

mat'l. code SEE NOTE		tolerances unless otherwise specified		CUSTOMER COPY	www.fciconnect.com <b>S-ATA SIGNAL PLUG DIP VERTICAL TYPE ASS'Y</b>
ltr	ecn no	dr	date	projection	
A	T05-0213	W.L.	09/09/05	linear	MM
				angles	0° ±2°
				dr	Wade Liu 09/09/05
				enrg	Wade Liu 09/09/05
				chr	Wade Liu 09/09/05
				appd	Sterling Lin 09/09/05
sheet	revision			scale	A 10035690
index	sheet				code 1 of 3

ACAD

PDM: Rev:A STATUS:Released Printed: Apr 14, 2006

cage code  
22526

Tous droits strictement réservés. Reproduction ou communication a des tiers interdite sous quelque forme que ce soit sans autorisation écrite du propriétaire. Propriété de c FCI. Droits de reproduction FCI.

All rights strictly reserved. Reproduction or issue to third parties in any form whatever is not permitted without written authority from the proprietor. Property of FCI. Copyright FCI.



PRODUCT NO.10035690-XXX-4W

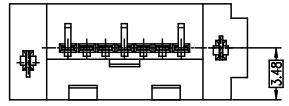
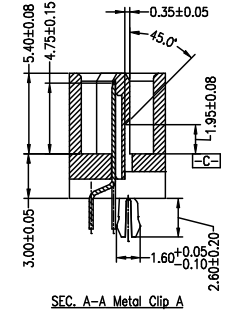
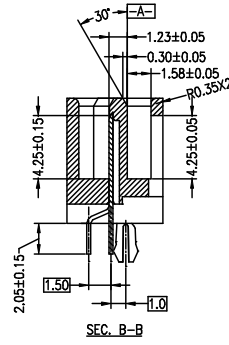
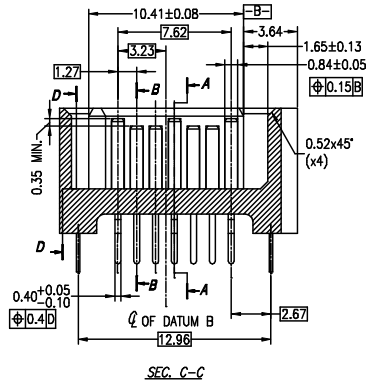
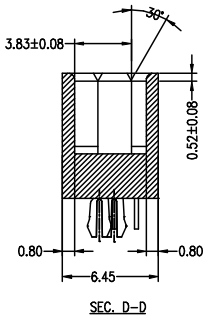
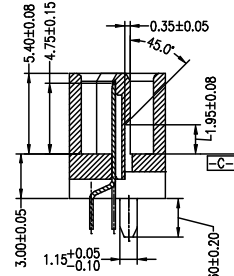
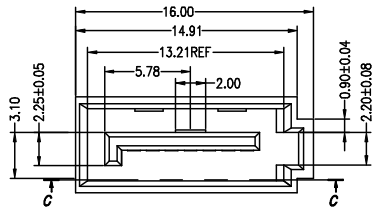

mat'l. code		SEE NOTE		tolerances unless otherwise specified		CUSTOMER COPY		 www.fciconnect.com	
ltr	ecn no	dr	date	linear	.XX±0.15	projection	title		
A				angles	0° ±2°		S-ATA SIGNAL PLUG		
				dr	Wade Liu 09/09/05		DIP VERTICAL TYPE ASS'Y		
				enrg	Wade Liu 09/09/05	MM	product family SATA		
				chr	Wade Liu 09/09/05	scale	size dwg no		
				appd	Sterling Lin 09/09/05		A 10035690		
sheet index	revision sheet								code
									2 of 3

cage code 22526

ACAD

PDM: Rev:A STATUS:Released Printed: Apr 14, 2006

Tous droits strictement réservés. Reproduction ou communication a des tiers interdite sous quelque forme que ce soit sans autorisation écrite du propriétaire. Propriété de c FCI. Droits de reproduction FCI.



All rights strictly reserved. Reproduction or issue to third parties in any form whatever is not permitted without written authority from the proprietor. Property of FCI. Copyright FCI.

1 | 2

3

4

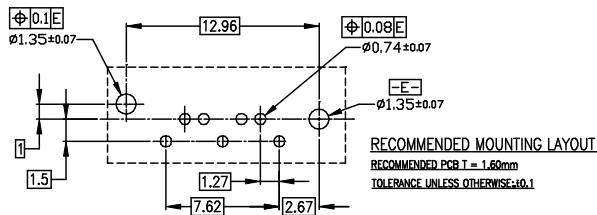

- 10035690-X X-X XX
- BLANK: Plating Tin/Lead
  - LF: Plating Lead Free
  - 3W: 3 Wall
  - 4W: 4 Wall
  - 2: Metal clip A
  - 3: Metal clip B
  - Au thickness of contact point
    - 0: 15u" min
    - 2: 3u" min
  - Housing Color
    - 0: Black
    - 1: Blue

**NOTES :**

1. MATERIAL
  - i) HOUSING : HIGH TEMPERATURE THERMOPLASTIC UL94V-0
  - ii) TERMINAL : COPPER ALLOY
  - iii) HOLD DOWN : COPPER ALLOY
2. FINISH
  - i) TERMINAL : Au PLATING AT CONTACT POINT  
100u" min Sn-Pb or PURE TIN PLATING AT SOLDER TAIL WITH NICKEL UNDERPLATE
  - ii) HOLD DOWN : 100-200 u" Sn-Pb or PURE TIN PLATING.
3. P/N : 10035690-XXXXLF  
THE HOUSING WILL WITHSTAND EXPOSURE TO 260 DEGREE C PEAK TEMPERATURE FOR 10 SECONDS IN A WAVE SOLDER APPLICATION WITH 1.6MM MINIMUM THICK CIRCUIT BOARD.
4. Packaging spec. GS-14-840.
5. Prodcut Spec. GS-12-194.

mat'l. code		SEE NOTE		tolerances unless otherwise specified		CUSTOMER COPY		 www.fciconnect.com	
ltr	ecn no	dr	date	linear	.XX±0.15	projection	title		
A				angles	0° ±2'		S-ATA SIGNAL PLUG		
				dr	Wade Liu 09/09/05	MM	product family		code
				enrg	Wade Liu 09/09/05		SATA		-
				chr	Wade Liu 09/09/05	scale	size dwg no		sheet
				appd	Sterling Lin 09/09/05		A 10035690		3 of 3
sheet index	revision sheet								

1 | 2

3

4

ACAD

cage code  
22526

PDM: Rev:A

STATUS: Released

Printed: Apr 14, 2006