

PRODUCT NUMBER  
77773-YXXLF

WHEN REQUIRED, ADD SUFFIX LETTER "LF"  
INDICATES THE PRODUCT IS RoHS  
COMPATIBLE, SEE NOTE 7

PLATING

3=0.76µm GOLD/GXT ON CONTACT AREA  
3.81µm TIN-LEAD ON TAIL

4=3.81µm TIN-LEAD ON CONTACT AREA  
AND ON TAIL

WHEN "LF" IS REQUIRED, 2µm MIN  
MATTE TIN OVER 1.27µm MIN NICKEL  
IS PROVIDED INSTEAD OF TIN-LEAD

STYLE	SIZE	OMIT PIN POSITION FROM TOP VIEW
01	1x09	2
02	1x35	4;5;6;7;8;12;13;14;15;16;20;21;22;23;24;28;32
03	1x21	2;4;6;8;10;12;14;16;18;20;21
04	1x21	1;2;4;6;8;10;12;14;16;18;20
05	1x10	8
06	1x06	1
07	1x08	7
08	1x04	2
09	1x04	3
12	1x21	2;4;6;8;10;12;14;16;18;20
13	1x05	2,4
14	1x03	2

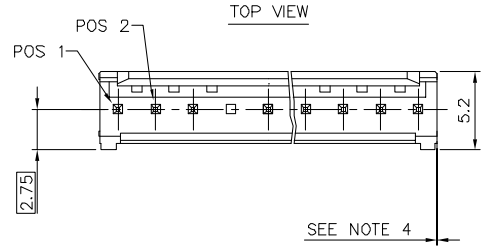

NOTES:

- BODY MATERIAL: POLYESTER 30% GLASSFILLED COLOR BLUE, FLAME RETARDANT PER UL-94 V0.
- CONTACT MATERIAL: PHOSPHOR BRONZE.
- 22N MIN PIN RETENTION IN EITHER DIRECTION
- 0.6 MAX PROTRUSION PERMITTED AT 4 PLACES
- PACKAGING :  
- POLYBAGS FROM 02 TO 06 POSITIONS  
- TUBE FROM 07 TO 36 POSITIONS
- TO DETERMINE DIMENSIONS :  
N = NUMBER OF POSITIONS PER ROW  
EXAMPLE : 8 POS N x 2.54 = 20.32mm
- RoHS COMPATIBLE PRODUCT SPECIFICATIONS

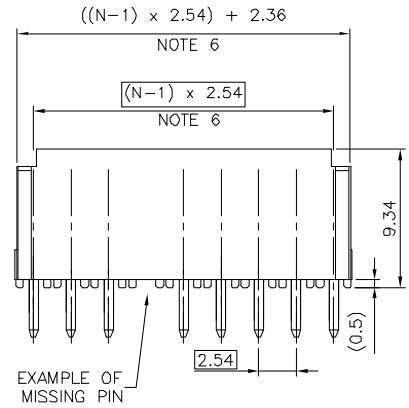
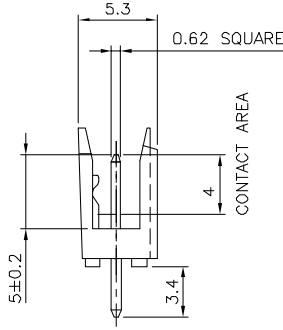

- PLATING:  
- "LF" MEANS THE PRODUCT IS LEAD-FREE, 2µm MINIMUM MATTE TIN OVER 1.27µm MINIMUM NICKEL UNDERPLATE.
- MANUFACTURING PROCESS COMPATIBILITY  
- THE HOUSING WILL WITHSTAND EXPOSURE TO 245°C ±5°C SOLDER BATH TEMPERATURE FOR 5 SECONDS IN A WAVE SOLDER APPLICATION WITH A 1.6mm MIN THICK CIRCUIT BOARD.
- LABELING:  
- MEETS PACKAGING SPECS AS PER GS-14-920
- LEGAL STATEMENT: SEE GS-22-008

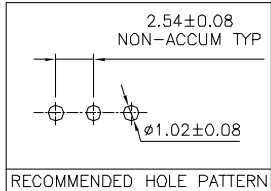

mat'l. code	SEE P/N	surface	ISO 1982	tolerance	ISO 486 ISO 1181	projection	product family
ltr	ecm no	dr	date	tolerances unless otherwise specified		mm	DUBOX HDR
V	F08-0147	YGV	08.04.14	linear .XX ±0.3		scale 4:1	DUBOX,SR,STR
W	F09-0028	LMU	09.03.11	angles .XXX ±0.05			SELECTIVELY LOADED
R	F05-0117	LMU	05.01.27	dr COMPAGNON J 95.03.06			dwg no
S	F05-0156	LMU	05.03.22	engr PHAMVAN JM 95.03.06			sheet 1 of 1
T	F05-0244	JCO	05.09.06	chr JMC 95.04.04			size
U	F06-0228	LMU	06.07.11	app JMP 95.04.04			A3
sheet index	revision sheet						type
							CUSTOMER Drawing