

REV	ECR	DR	DATE
A	---	JW	2013-01-25

spec ref	-	dr	John Wang	approval		projection	MM	size	A2	scale	1:1	
tolerance std	ASME Y14.5	eng	John Wang	approval		chr		ecn no		rel level	Released	
surface	linear	0.X	±0.5	0.XX	±0.25	0.XXX	±0.10	www.fcj.com	cat. no.	10124179	rev	A
ASME Y14.5	angular	°	±2°									sheet 1 of 4

PDS: Rev :A STATUS:Released Printed: Mar 19, 2013

Copyright FCJ

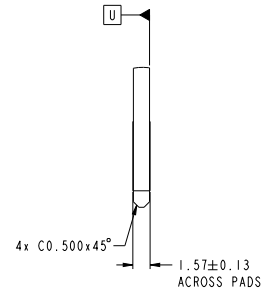
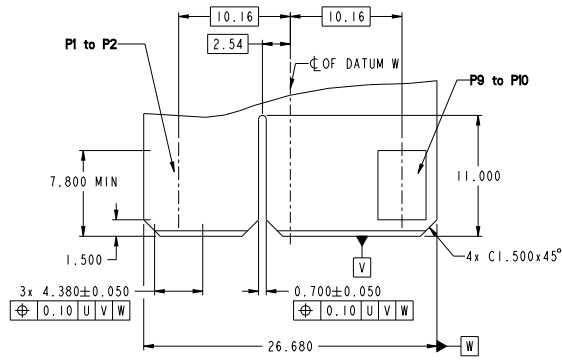

Copyright FCI

dr	Julio Wang	designed	projection	MM	size	A2	scale	1:1
eng	Julio Wang	designed			ecn no			
chr					rel level	Released		
appr	Paulo Wang	designed	product family					
		STD VERT RECPT 20P OMIT 8P HIGH POWER CARD EDGE		10124179	rev A			
www.fcicom		cat. no.	Product - Customer Draw		sheet 3 of 4			

PDS: Rev :A

STATUS:Released

Printed: Mar 19, 2013

HPCE PART NUMBER (TABLE 3)				
PART NUMBER	TAIL TYPE	ORIENTATION KEY	DIM "A" TYPICAL TAIL LENGTH	DIM "B" RECOMMENDED BOARD THICKNESS
10124179-001LF	SOLDER	YES	3.17 ±0.25	1.59 - 2.38
10124179-002LF	SOLDER	NO		
10124179-003LF	PRESS-FIT	YES	3.17 ±0.25	1.57 MIN
10124179-004LF	PRESS-FIT	NO		

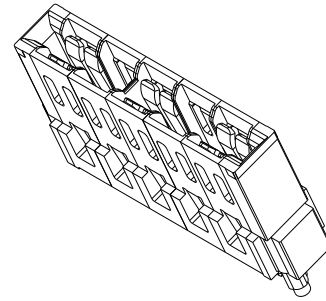

NOTES:

1. CONNECTOR MATERIALS:
 HOUSING: HIGH TEMPERATURE THERMAL PLASTIC, BLACK
 UL 94V-0 COMPLIANT
 CONTACTS: HIGH PERFORMANCE COPPER ALLOY.
2. CONTACT FINISH REF. GS-12-604 SECTION 5.2.
3. PRODUCT SPECIFICATION: GS-12-604.
4. APPLICATION SPECIFICATION: GS-20-128.
5. PRODUCT MARKING (FCI - PART NUMBER & DATE CODE) ON HOUSING IN AREA SHOWN.
6. PACKAGING MEETS FCI SPECIFICATION GS-14-937.
7. HOUSING COMPONENT WILL WITHSTAND EXPOSURE TO 260°C PEAK TEMPERATURE FOR 60 SECONDS IN A CONVECTION, INFRA-RED, OR VAPOR PHASE REFLOW OVEN.
8. COPPER PLATING THICKNESS IN CENTER OF VIA-HOLE CAN BE NO MORE THAN 0.003 LESS THAN OTHER AREAS.
9. ALL HOLE SIZES ARE FINISHED HOLE SIZES.
10. MOUNTING HOLES ARE UNPLATED.
 Ø 2.40 +/- 0.1 FOR PRESS-FIT TAILS
 Ø 2.18 +/- 0.03 FOR SOLDER TAILS
11. PRESS FIT APPLICATION TOOL DRAWING : 10119453.

dr	Julio Wang	designed	projection	MM	size	A2	scale	1:1
eng	Julio Wang	designed			ecm no			
chr					rel level			Released
appr	Paul Wang	designed	product family					
www.fcicom		cat. no.	STD VERT RECPT 20P OMIT 8P		10124179	rev	A	
			HIGH POWER CARD EDGE				Product - Customer Draw sheet 4 of 4	

PDS: Rev :A STATUS:Released Printed: Mar 19, 2013

Copyright FCI