

REV	DESCRIPTION	DATE	APPROVED
U	REVISED PER ECO 14778	11-5-02	W

DASH NO.	CABLES ACCOMMODATED	A DIM	B DIM	C FLATS	D FLATS	E DIA	ASSEMBLY PER
-7	TRC-50-2 TRC-75-2	1.135	.096	.438	.438	.500	TAI-189
-8	B227, BELDEN	1.716	.130	.625	.688	.750	TAI-103
-9	TWC-78-2 TWC-124-2	1.135	.096	.438	.438	.500	TAI-102
-9A	BL782, TIMES BL902, TIMES BL1242, TIMES			△	△		
-10	R6-22 754E, AT&T						TAI-103
-11	760A, AT&T	1.716	.130	.625	.688	.750	TAI-128
-12	16 PEVL, AT&T V1-AL, GENERAL						TAI-129
-13	TRF-50, TIMES						TAI-129
-13A	B232, BELDEN						TAI-129
-14	B233, BELDEN						TAI-129
-23	250-3884, MICRODOT						TAI-189
-24	202-3934, MICRODOT						TAI-102
-24A	9530A5117, RAYCHEM						TAI-189
-25	T-43M, GENERAL						TAI-102
-25A	S021H5311, RAYCHEM						TAI-189
-26	7028A5116, RAYCHEM						TAI-189
-27	T187PSJ2618EN, MOVEN 202-3927, MICRODOT 202-3942, MICRODOT						TAI-102
-29	TWC-78-1/TWC-124-1A 761A, AT&T B441, BELDEN	1.135	.096	.438	.438	.500	TAI-102
-30	TRC-50-1 TRC-75-1						TAI-189
-42	21-204, ESSEX 4493, CONSOLIDATED						TAI-189
-43	250-4044/250-4045 293-3930, MICRODOT						TAI-102
-45	M27500-22TE214 1100-66F, STANDARD	1.716	.130	.625	.688	.750	TAI-103
-46	B860, BELDEN	1.135	.096	.438	.438	.500	TAI-102
-47	M17176-00002	1.716	.130	.625	.688	.750	TAI-102
-49	TWAC-78-1F2						TAI-189
-54	B9207, BELDEN	1.135	.096	.438	.438	.500	TAI-102
-55	B9272, BELDEN						TAI-189
-56	GC875G1, GRUMMAN						TAI-189
-57	GC875G1, GRUMMAN						TAI-102
-58	GC875T244, GRUMMAN	1.135	.096	.438	.438	.500	TAI-102
-59	GC875L1, GRUMMAN						TAI-189
-60	M17177, THERMATICS 380-10045, BOEING						TAI-189
-64	7528A5314, RAYCHEM						TAI-189

FIG 1 △
-9 SHOWN

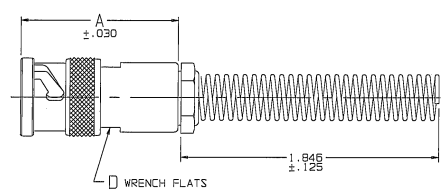
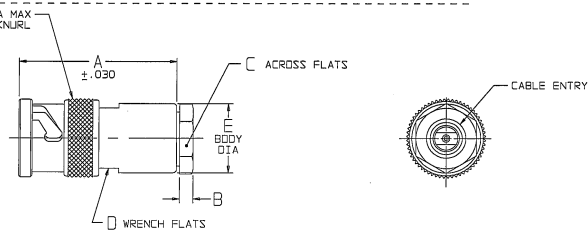

FIG 2 △
-9 SHOWN



DASH NO.	DIA	DASH NO.	DIA
-7	.274	-29	.191
-8	.345	-30	.235
-9	.285	-32	.191
-9A	.285	-33	.217
-10	.455	-42	.300
-11	.347	-43	.200
-12	.485	-45	.193
-13	.352	-46	.475
-13A	.352	-47	.164
-14	.490	-49	.132
-23	.183	-54	.323
-24	.191	-55	.250
-24A	.200	-56	.191
-25	.285	-57	
-25A	.191	-58	.198
-26	.191	-59	.217
-27	.145	-60	.217
		-64	.183

RED INDICATES ORIGINAL

6. EXAMPLE OF A COMPLETE MODEL NO.

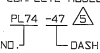

BASIC MODEL NO. DASH NO.

△ IF BEND RELIEF SPRING REQD (SEE FIG 1)
ADD SUFFIX "BR" TO MODEL NO.
(NOT AVAILABLE WITH CABLE GROUPS -8, -10, -11,
-12, -13, -13A, -14, -46 & -54)

△ CLAMP NUT OMITTED

△ 2-LUG BAYONET CONCENTRIC TWINAX/TRIAX TRB CABLE PLUG

2. FINISH: TFS-1A (NICKEL)

1. ALL DIM ARE IN INCHES

TYPE	DASH NO./CABLE GROUP																
TWINAX	-8	-9	-9A	-10	-11	-12	-24	-25	-27	-29	-30	-45	-46	-47	-49	-54	-55
TRIAX	-7	-13	-13A	-14	-23	-24A	-25A	-26	-32	-33	-42	-43	-56	-57	-59	-60	-64
QUADAX	-58																

INTERPRET DRAWING PER REVISIONS AS IN INCHES AND UNLESS OTHERWISE SPECIFIED	UNLESS SPECIFIED XXX ± .005 XXXXX ANGLES	TROMPETER ELECTRONICS, INC.
DATE: 11-4-02	FINISH: 11-5-02	TITLE: PL74/PL74BR
305-0515	310-0025U	SCALE: NONE
NEXT ASSY	DO NOT SCALE DIMS	DATE: 3/27/78
		SHEET: 1C