

CLIFF

Screened DIN Connectors



D5-SA



D5-SS

The economically priced range of **CLIFF**[®] Screened DIN Connectors is complimentary to our unscreened range. Available in either 3, 4, 5, 6, 7 and 8 pin versions, they are intended for use in many types of consumer and professional audio equipment including MIDI. We also offer a range of molded DIN Leads, contact our sales office for more details on these products.

Significant features include:

- Standard size DIN connectors, to DIN 41524.
- Built in EMI / RFI screen.
- Robust construction.
- 3 pin to 8 pin versions available.
- Right angle PCB Mounting.
- Optional 5 pin version (D5FS) with 2 front mounting holes for direct chassis grounding.
- Suitable for wave soldering.

Cliff Electronic Components, Ltd.

76 Holmethorpe Avenue, Holmethorpe Ind. Est.
Redhill, Surrey RH1 2PF. England

Tel: +44 (0) 1737 771375

Fax: +44 (0) 1737 766012

Email: sales@cliffuk.co.uk



Visit us online at:

www.cliffuk.co.uk

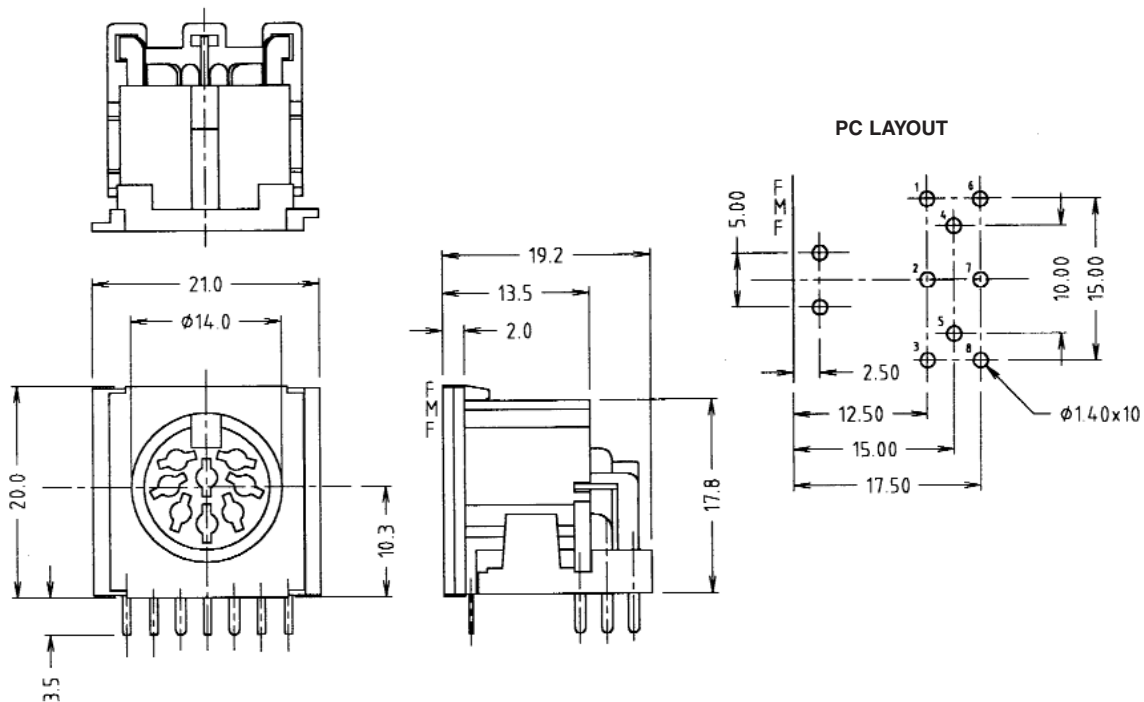

ARRANGEMENT OF CONTACTS						
MODEL No.	DIN-3SA	DIN-4SA	DIN-5SA	DIN-6SA	DIN-7SA	DIN-8SA
P/No.	FM 6723	FM 6724	FM 6725	FM 6726	FM 6727	FM 6728

Electrical Specifications:

Rated Current: 4A.

Rated Voltage: For Low Voltage use to 34Vac max.

Operating Temperature: -20 to 70 °C.

Contact Resistance (new): <5mΩ. (mated)

Contact Resistance (after 1000 insertions): 15mΩ. max.

Mechanical Specifications:

Insertion Life (Minimum): >1000 insertions and removals

Insertion Force: <10N

Materials:

Housing: PBT UL-94V0

Contacts: Brass

Plating: Tin

EMI/RFI Screen: Stainless Steel