

Fiber optic cables

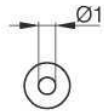
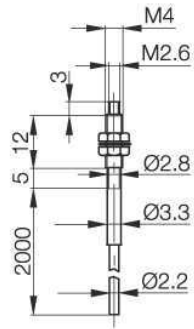

V1175

Mechanical data:

Type	Through-beam
Diameter of Core	1 mm
Diameter of Jacket	2,2 mm
Fiber arrangement	Standard
Optical head attachment	M4 thread
Light exit	straight
max. Range	600 mm
max. Range with BFB 75K-001	600 mm
max. Range with BFB 75K-002	600 mm
max. Range with BOS 18KF	120 mm
max. Range with BOS 6K	230 mm
max. Range with BOS 73K	500 mm
max. Range with BOS 74K	220 mm
characteristics	Temperature resistant
Fiber bending radius	25 mm
Sensing face material	plastic
Ambient temperature Ta max.	+115 °C
Ambient temperature Ta min.	-55 °C

General data:

Sensortyp	Fiber optics
For use with	Fiber optic amplifier