

# Hardware

For miniature switches

- Standard hardware is automatically supplied with the switches
- Non standard hardware is to be ordered separately



### Hardware supplied with sealing options :

- K version : 2 hex nuts + sealing washer
- X408 option : 1 hex nut + 1 O-ring

## STANDARD HARDWARE FOR SWITCHES Ø 6 (.236) - 5000 SERIES

### HEX NUT

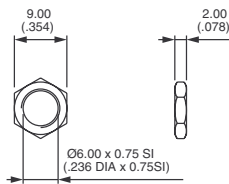

Nickel plated **U208**  
Matt black **U726**

### LOCKING RING

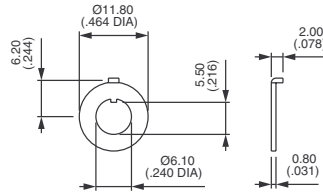

Nickel plated **U198**  
Matt black **U728**

### LOCKWASHER

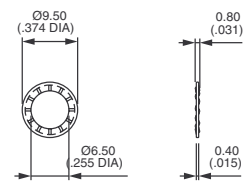

Stainless steel **U215**

## NON STANDARD HARDWARE FOR SWITCHES Ø 6 (.236) - 5000 SERIES

### KNURLED NUT

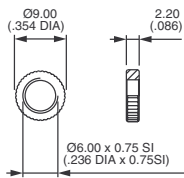

Chrome plated **U826**

### SPECIAL NUT 12 (.472) ACROSS FLATS

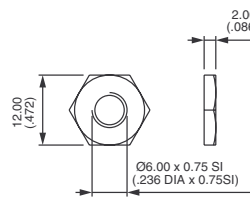

Chrome plated **U1916**

### KNURLED CAP NUTS

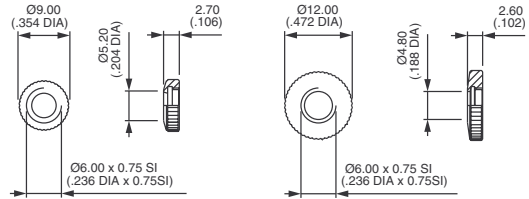

Chrome plated **U461**  
Matt black **U502**

Chrome plated **U232**

## STANDARD HARDWARE FOR SWITCHES Ø 6,35 (1/4) - ALL SERIES

### HEX NUT

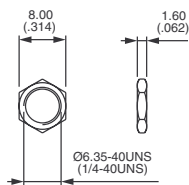

Nickel plated **U76**  
Matt black **U94**

### LOCKING RING

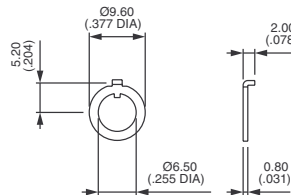

Nickel plated **U78**  
Matt black **U93**

### LOCKWASHER

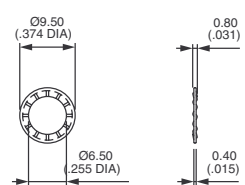

Stainless steel **U215**

### HARDWARE SUPPLIED (unsealed types)

SERIES	HEX NUT	LOCKING RING	LOCKWASHER
SF	2	1	1
11000	2	1	1
13000	2	1	1
18000-8000-SP	2	1	1
21000N	2	-	-
5000	2	1	1
9400-9600	2	-	1

# Hardware

For miniature switches

## NON STANDARD HARDWARE FOR SWITCHES Ø 6,35 (1/4) - ALL SERIES

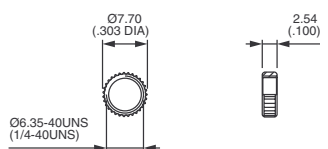
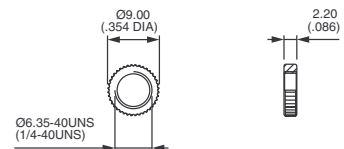
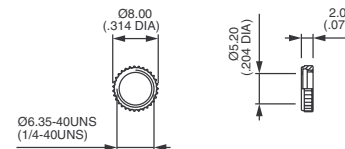
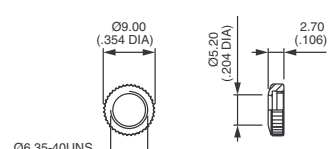
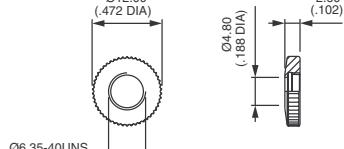
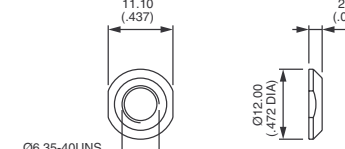
<p><b>KNURLED NUT</b></p>  <p>Nickel plated <b>U369</b></p>	<p><b>KNURLED NUT</b></p>  <p>Nickel plated <b>U229</b> Matt black <b>U230</b></p>	<p><b>KNURLED NUT</b></p>  <p>Chrome plated <b>U501</b></p>
<p><b>KNURLED CAP NUT</b></p>  <p>Chrome plated <b>U216</b> Matt black <b>U218</b></p>	<p><b>KNURLED CAP NUT</b></p>  <p>Chrome plated <b>U268</b> Matt black <b>U725</b></p>	<p><b>DRESS NUT</b></p>  <p>Nickel plated <b>U443</b> Matt black <b>U848</b></p>

\* U216 and U268 : consult factory for mounting on 11000 three and four pole, and 5000 locking lever models.

## OTHER HARDWARE FOR SWITCHES Ø 6,35 (1/4) - ALL SERIES

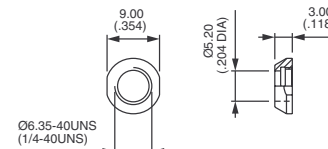
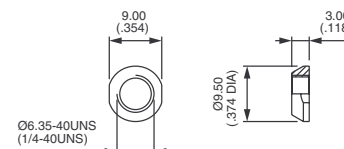
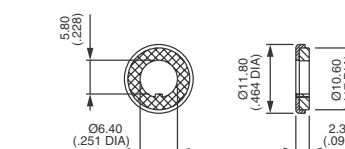
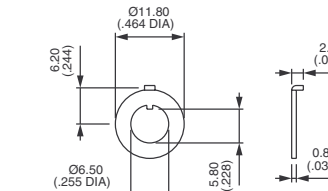
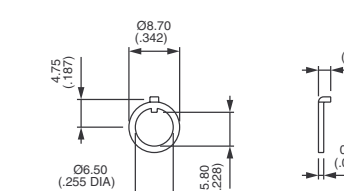
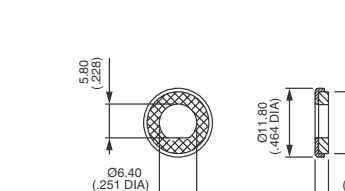
<p><b>CONIC CAP NUT</b></p>  <p>Nickel plated <b>U500</b></p>	<p><b>CONIC NUT</b></p>  <p>Chrome plated <b>U542</b> Nickel plated <b>U561</b></p>	<p><b>SEALING WASHER</b> for keyway bushing</p>  <p><b>U360</b></p>
<p><b>SPECIAL LOCKING RING</b> Spacing 6,2 mm (.244)</p>  <p>Nickel plated <b>U368</b></p>	<p><b>SPECIAL LOCKING RING</b> Spacing 4,75 mm (.187)</p>  <p>Nickel plated <b>U409</b></p>	<p><b>SEALING WASHER</b> for flatted bushing</p>  <p><b>U5141</b></p>

# Hardware

For miniature switches

## STANDARD HARDWARE FOR SWITCHES Ø 10 (.393) - 10400 AND 10600 SERIES

**KNURLED CAP NUT  
(std for 10600)**

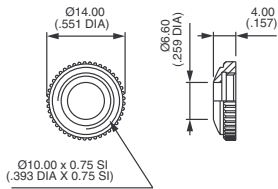

Chrome plated  
**U2220**

**KNURLED NUT  
(std for 10400)**

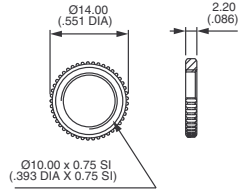

Chrome plated  
**U2311**

**HEX NUT**

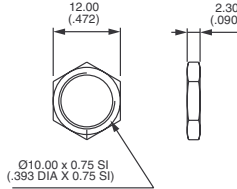

Nickel plated  
**U842**

**LOCKING RING**

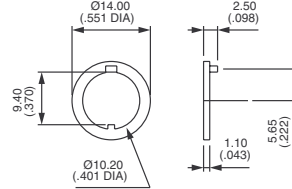

Nickel plated  
**U844**

**LOCKWASHER**

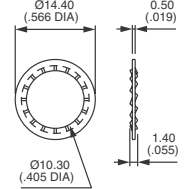

Stainless steel  
**U843**

## STANDARD HARDWARE FOR SWITCHES Ø 11,9 (15/32) - 12000, 13000X768 AND 5600M SERIES

**HEX NUT**

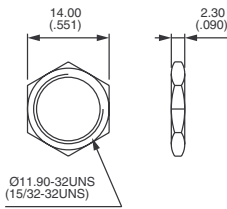

Nickel plated  
Matt black  
**U162**  
**U41**

**LOCKING RING**

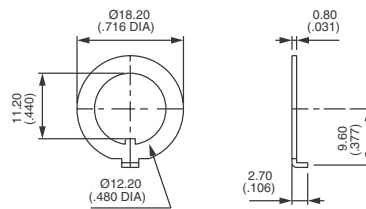

Nickel plated  
Matt black  
**U121**  
**U12**

SERIES	HARDWARE SUPPLIED	
	HEX NUT	LOCKING RING
12000	2	1
13000X768	1	-
5600M	2	1
8000X718	2	1

## NON STANDARD HARDWARE FOR SWITCHES Ø 11,9 (15/32) - 12000, 13000X768 AND 5600M SERIES

**KNURLED NUT**

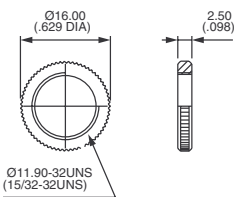

Nickel plated  
Matt black  
**U53**  
**U1634**

**KNURLED CAP NUTS**

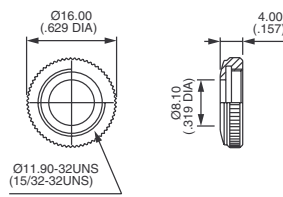

Chrome plated  
**U124**

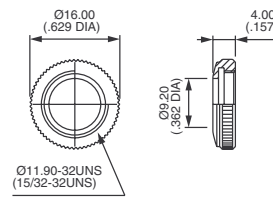

Chrome plated  
**U123**

**LOCKWASHER**

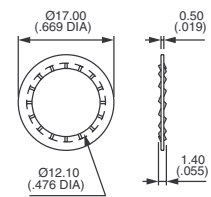

Zinc plated  
**U13**

### OTHER HARDWARE

**SEALING WASHER**

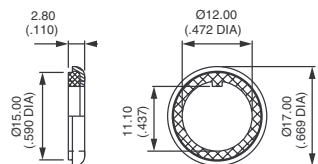

**U60**

### WRENCHES

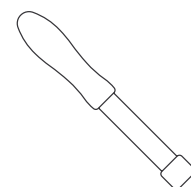

Wrenches are available for some accessories. Consult factory.

# Hardware

## For industrial switches

- Standard hardware is indicated by darkened boxes.
- For details of hardware supplied, please refer to beginning of each series.
- Special hardware is to be ordered separately.



Hardware supplied with **K** sealing option : 2 hex nuts.

NUTS	Bushing Ø 11,9 (15/32) thread 0,794-32UNS Series 3500 - 6000			Bushing Ø 12 (.472) thread 0,75 Series IB/IS - IP - 660 - 600H - 600NH 1000 - 1200 - 1500 - 1600 - 1700 - 3600 - 4000		
	Chrome plated brass	Nickel plated brass	Matt black brass	Chrome plated brass	Nickel plated brass	Matt black brass
		<b>U53</b>		<b>U412</b>	<b>U411</b>	<b>U413</b>
	<b>U92</b>	<b>U162</b>	<b>U41</b>	<b>U212</b>	<b>U166</b>	<b>U183</b>
 Hex cap nut				<b>U35</b>		
 PAL nut					<b>U42</b> (passive zinc plated steel)	
 Knurled cap nut	<b>U123</b>			<b>U117</b> $\alpha = 8,5 (.334)$ <b>U118</b> $\alpha = 10,3 (.405)$		<b>U129</b> $\alpha = 8,5 (.334)$ <b>U130</b> $\alpha = 10,3 (.405)$

### INSULATED NUT U520

 ABS or polyamide with glass fibre	For threaded bushing Ø 12 (.472) x 0,75 IS Series 1500 - 4000 - 600NH - 6-600NH								
	Blue	Black	Green	Grey	Yellow	Red	White	Chrome plated	Orange
	<b>U521</b>	<b>U522</b>	<b>U523</b>	<b>U524</b>	<b>U525</b>	<b>U526</b>	<b>U527/1</b>	<b>U528</b>	<b>U529</b>

The locking ring U121 (nickel plated) or U12 (matt black) is only provided with tropicalized switches version T or G and with series 3500 - 6000.

The lockwasher U13 must be ordered separately, except for series 660, 3500 and 6000.

# Hardware

For industrial switches

## HARDWARE FOR SWITCHES Ø 12 (.472) AND 11,9 (15/32)

### LOCKING RING

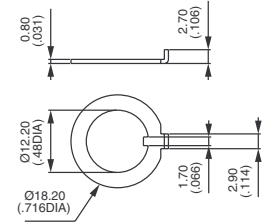

Nickel plated **U121**  
Matt black **U12**

### LOCKWASHER

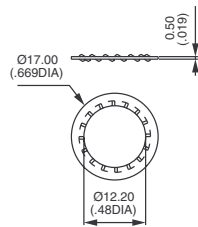

Zinc plated **U13**

### SEALING WASHER

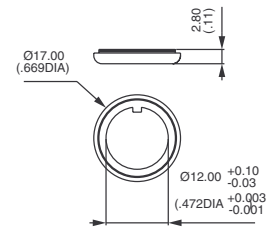

Stainless steel and neoprene **U60**

### SEALING WASHER FOR BOOTS

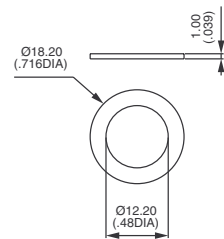

Nylon **U21**

### GROUND CONNECTOR

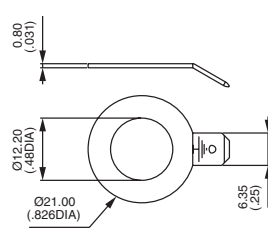

Nickel plated **U187**

### LOCKWASHER

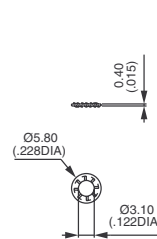

**U14**

## PLATES FOR SWITCHES Ø 12 (.472) AND 11,9 (15/32)

### Marche - arrêt

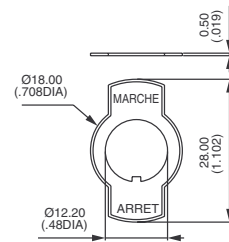

**U17**

### ON - OFF

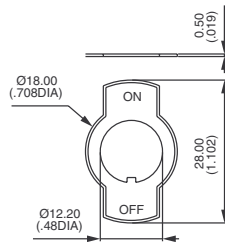

**U19**

### EIN - AUS

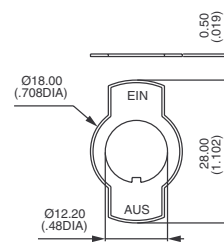

**U99**

### I - 0

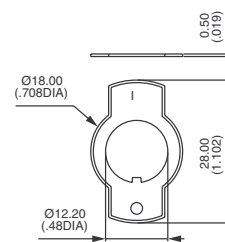

**U1050**

## SCREWS (supplied with the switches)

### CONNECTING SCREW

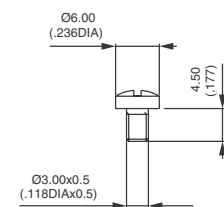

**U03**

### MOUNTING SCREW Ø 3 (.118)

(6000 SERIES)

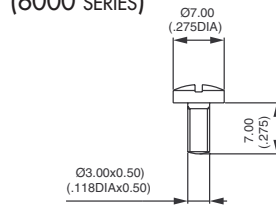

Nickel plated **U164**  
Chrome plated **U165**  
Matt black **U45**

# Hardware

For industrial switches

## HARDWARE FOR AV SERIES (ANTI-VANDAL AND SECURITY PUSHBUTTON SWITCHES)

### HEX NUT FOR MODELS Ø 16 (.629)

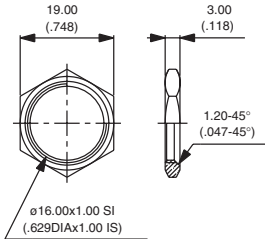

10-621 (sealed or unsealed models)

### KNURLED NUT FOR MODELS Ø 16 (.629)

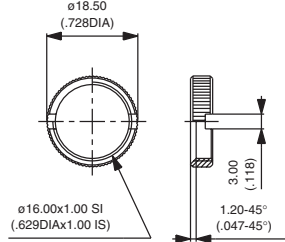

10-960-5 (sealed or unsealed models)

### KNURLED NUT FOR MODELS Ø 19 (.748)

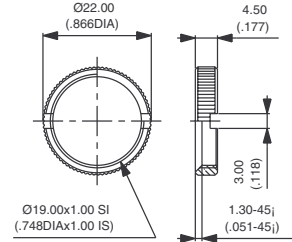

U1977-5 (sealed or unsealed models)

### HEX NUTS FOR MODELS Ø 19 (.748)

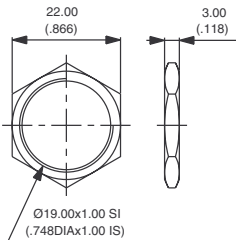

U1950-5 (unsealed models)

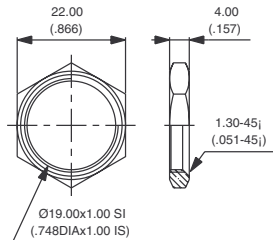

10-855-5 (sealed models)

Wrench for nut U1977-5 available under part number U1929.

### HEX NUTS FOR MODELS Ø 22 (.866)

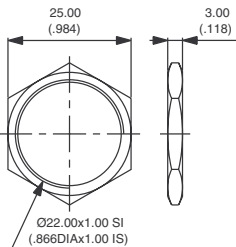

U1951-5 (unsealed models)

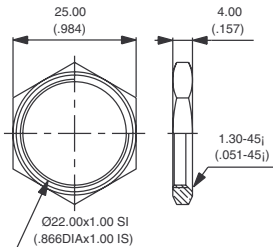

10-856-5 (sealed models)

### HEX NUT FOR MODELS Ø 24 (.944)

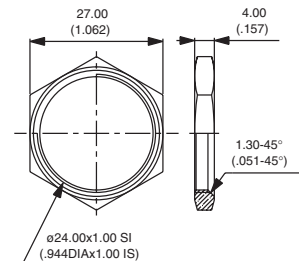

U2059-5 (sealed or unsealed models)

All above nuts are made of nickel plated brass.

For switches with front panel sealing (option K), a neoprene O-ring is supplied with each nut.