

REV.	DATE	DESCRIPTION
A	10/20/03	UPDATE DRAWING FORMAT

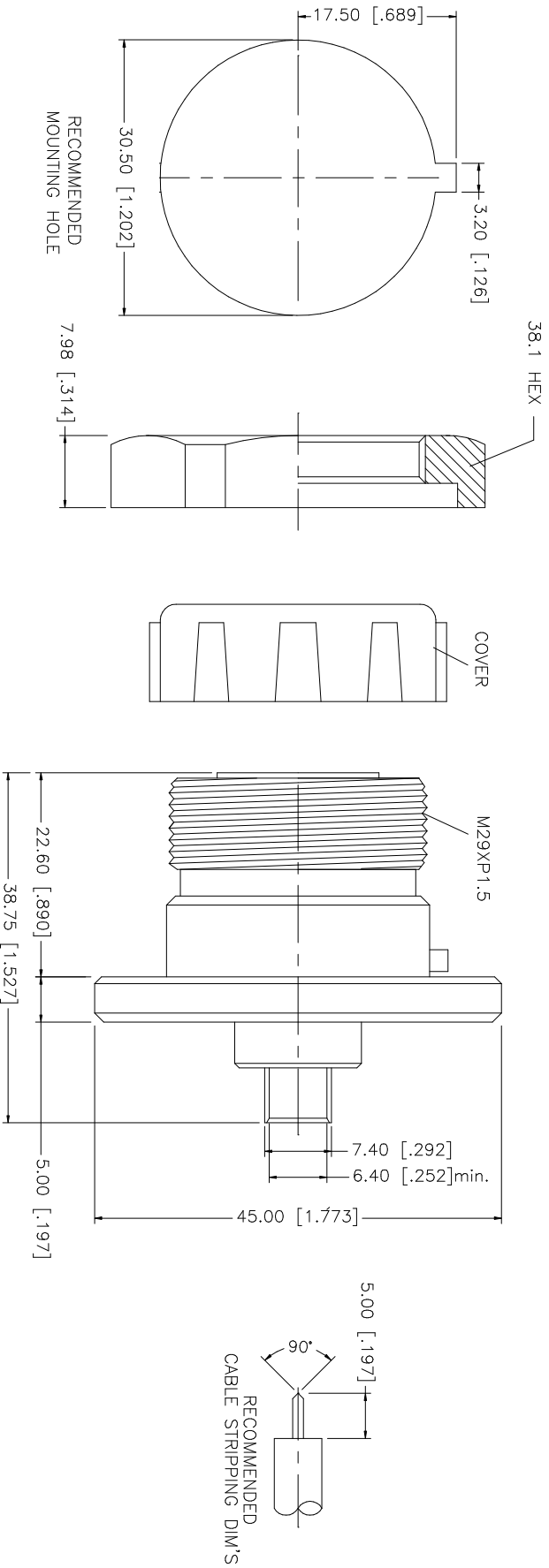

QTY	FINISH	MATERIAL	DESCRIPTION
1	SILVER	BRASS	INSULATOR BODY
1	SILVER	BER. COPPER	CONTACT PIN
1	SILVER	BRASS	HEX NUT
1	SILVER	COPPER	FERRULE
1	BLUE	P.E.	COVER

UNLESS OTHERWISE SPECIFIED DIMENSIONS ARE IN INCHES AND FOR CUSTOMER REFERENCE ONLY.	UNLESS OTHERWISE SPECIFIED DIMENSIONS ARE IN MILLIMETERS AND FOR CUSTOMER REFERENCE ONLY.
TOLERANCES FOR MILLIMETERS ARE:	TOLERANCES FOR INCHES ARE:
0.3 - 8mm ± 0.20mm	0.3 - 30mm ± 0.40mm
8 - 30mm ± 0.40mm	30 - 120mm ± 0.50mm
UNLESS OTHERWISE SPECIFIED DIMENSIONS ARE IN INCHES AND FOR CUSTOMER REFERENCE ONLY.	UNLESS OTHERWISE SPECIFIED DIMENSIONS ARE IN MILLIMETERS AND FOR CUSTOMER REFERENCE ONLY.
TOLERANCES FOR INCHES ARE:	TOLERANCES FOR MILLIMETERS ARE:
.020 - .315 ± 0.007"	0.3 - 8mm ± 0.20mm
.315 - 1.180 ± 0.015"	8 - 30mm ± 0.40mm
1.180 - 4.724 ± 0.020"	30 - 120mm ± 0.50mm

APPROVALS	DATE
DRAWN G.R.S.	10/20/03
CHECKED	
ISSUED	
SHEET 1 OF 1	

PART NO.	DWG. NO.	REV.	SIZE	SCALE
272159	272159.DWG	A	A	NA

DO NOT SCALE DRAWING
CAD FILE C:/272/272159.DWG

Amphenol Connex

PART DESCRIPTION
7/16 DIRECT SOLDER BULKHEAD JACK
 (FOR .250" SEMI-RIGID CABLE)