

#### ASJ-103

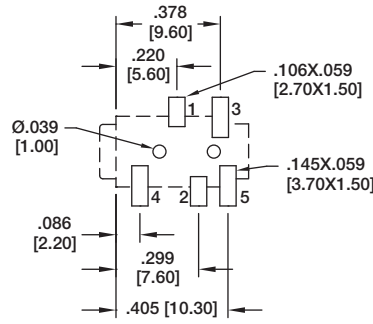
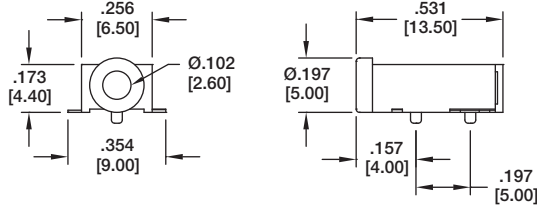

ASJ-103-J

ASJ-103-J	ASJ-103-M

Recommended PCB Layout

#### ASJ-104

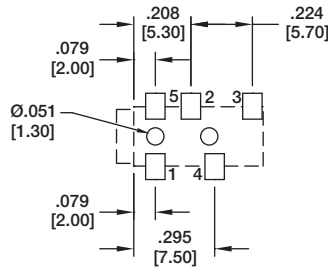
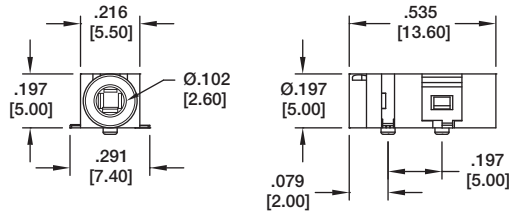

ASJ-104-J

ASJ-104-J

Recommended PCB Layout

#### ASJ-105

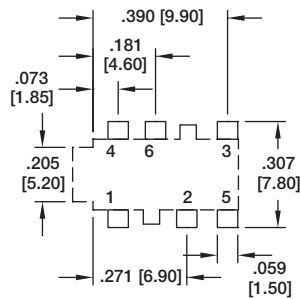
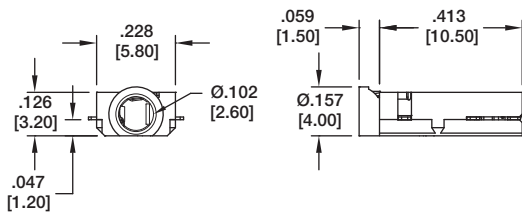

ASJ-105-A

ASJ-105-A	ASJ-105-B	
ASJ-105-D	ASJ-105-M	ASJ-105-I

Recommended PCB Layout

#### ASJ-106

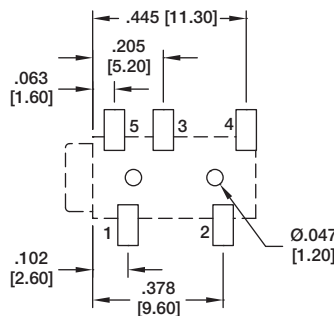
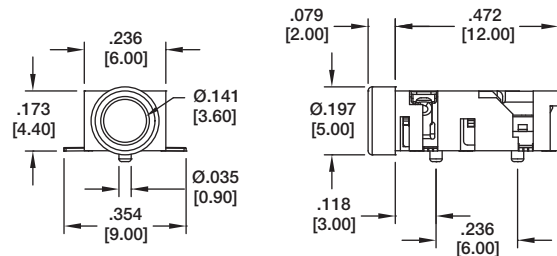

ASJ-106-C

ASJ-106-C	ASJ-106-D	
ASJ-106-K	ASJ-106-P	ASJ-106-B

Recommended PCB Layout

#### ASJ-107

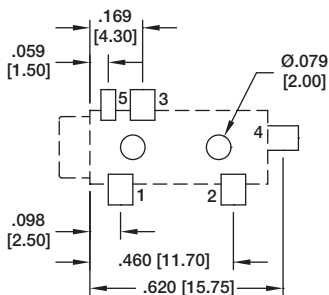
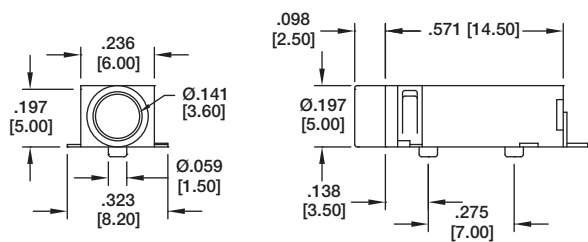

ASJ-107-B

	ASJ-107-B	ASJ-107-C
ASJ-107-D	ASJ-107-F	ASJ-107-A

Recommended PCB Layout

#### ASJ-108

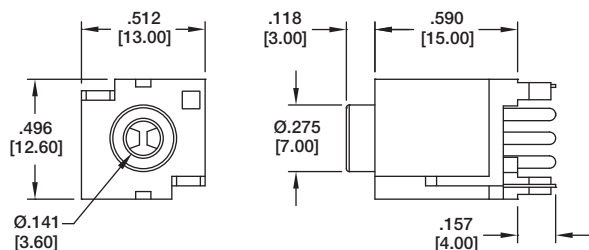

ASJ-108-A

ASJ-108-A	ASJ-108-B	ASJ-108-C	ASJ-108-D	ASJ-108-G
ASJ-108-F	ASJ-108-L	ASJ-108-N	ASJ-108-K	ASJ-108-W

#### ASJ-109

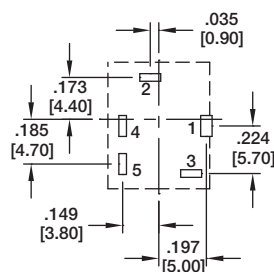
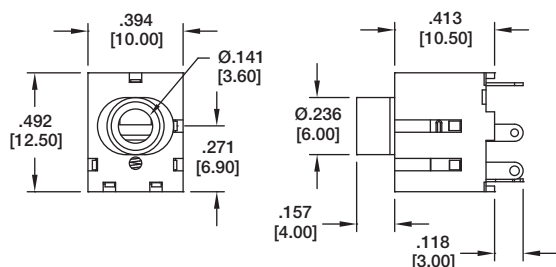

ASJ-109-A

ASJ-109-A	ASJ-109-B	ASJ-109-D

Recommended PCB Layout

#### ASJ-110

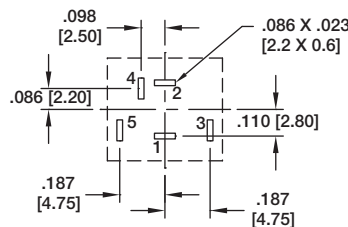
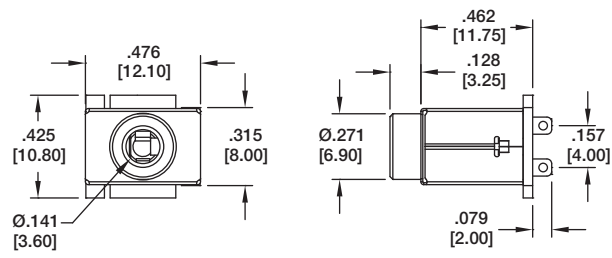

ASJ-110-A

ASJ-110-L

Recommended PCB Layout

#### ASJ-111

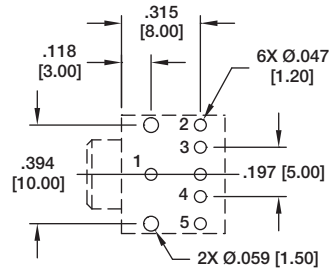
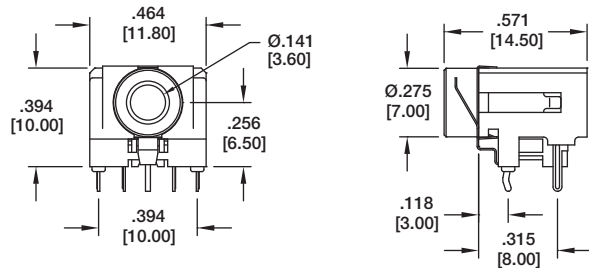

ASJ-111-1

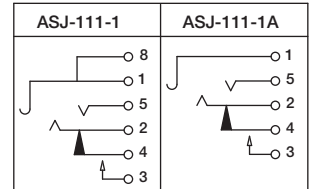

#### ASJ-112



ASJ-112-J

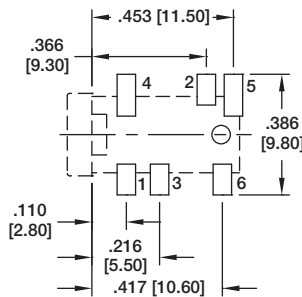
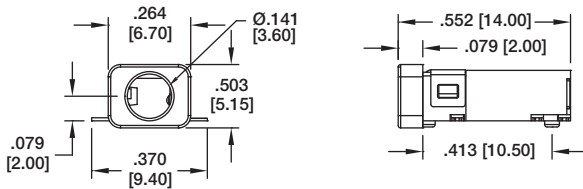

Recommended PCB Layout

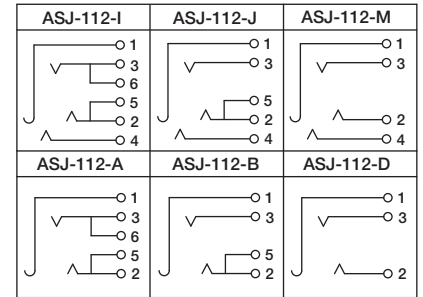

#### ASJ-113



ASJ-113-B

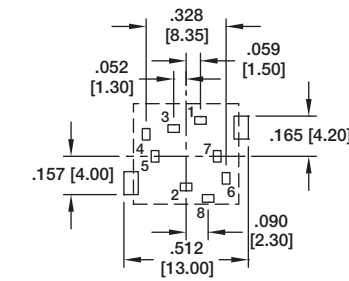
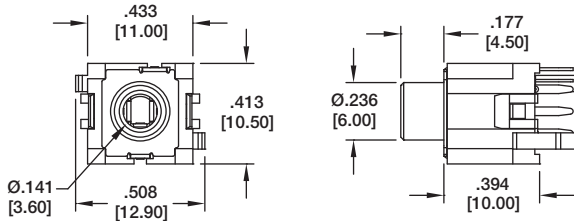

Recommended PCB Layout

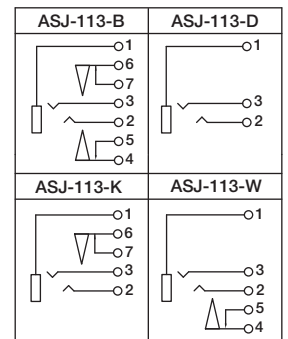

#### MONO AUDIO PLUG

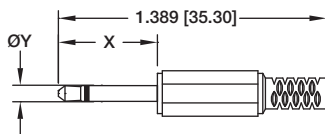

DIMENSION	X	Y
ASP-2.5-M	.468 [11.90]	$\varnothing.098$ [2.50]
ASP-3.5-M	.590 [15.00]	$\varnothing.137$ [3.50]

#### STEREO AUDIO PLUG

##### 2 CHANNEL

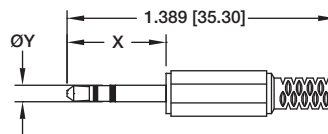

DIMENSION	X	Y
ASP-2.5-S	.468 [11.90]	$\varnothing.098$ [2.50]
ASP-3.5-S	.590 [15.00]	$\varnothing.137$ [3.50]

#### STEREO AUDIO PLUG

##### 3 CHANNEL

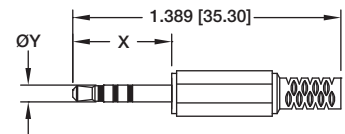

DIMENSION	X	Y
ASP-2.5-S3	.468 [11.90]	$\varnothing.098$ [2.50]
ASP-3.5-S3	.590 [15.00]	$\varnothing.137$ [3.50]