

PRODUCT NUMBER
SEE TABLE

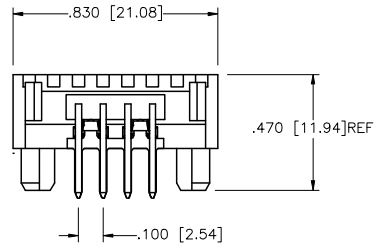
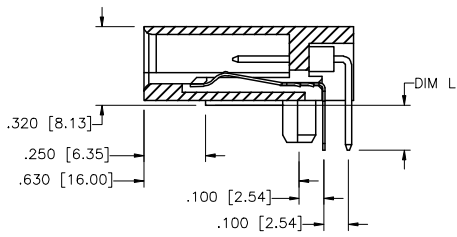
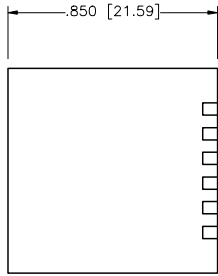

mal't. code		surface		tolerance	projection	product family	
		ISO 1302		ISO 406 ISO 1001		LATCH-N-LOK	
lfr		ecn no	dr	date	tolerances unless otherwise specified		title
C	V01795	TFG		9/11/00	angles	linear	1X4 LNL RT ANGLE HEADER ASSEMBLY
D	V10425	TFG		2/7/01	linear	linear	
E	M05-0033	ERE		2/25/05	0'±2'	linear	dwg no 69273
F	M05-0052	MHT		3/16/05	dr	J. LINN	
G	M06-0285	AGS		7/28/06	eng	D. HORCHLER	sheet 1 of 2 size A3
H	M06-0365	AGS		9/20/06	chr	D. HORCHLER	type Product Customer Drawing
J	M09-0048	MHT		3/12/09	appd	D. HORCHLER	
sheet	revision		J	J			
index	sheet	1	2				

69273-XXXLF

LEAD FREE OPTION (6) (7)

COLOR (4)		
1	70343-LT GRAY	OBS
2	80166 OFF WHITE	
3	70634-DK GRAY	OBS
4	701 BLACK	
5	70511-SLATE GRAY	OBS
7	70455 SILVER GRAY	
8	80189 PEARL WHITE	OBS
9	70419 PEBBLE GRAY	

PLATING (8)	
0	30u" GXT
3	30u" AU OVER 50u" NI
5	50u" AU OVER 50u" NI

PIN LENGTH	
DIM L	
0	.150/3.81
1	.110/2.79

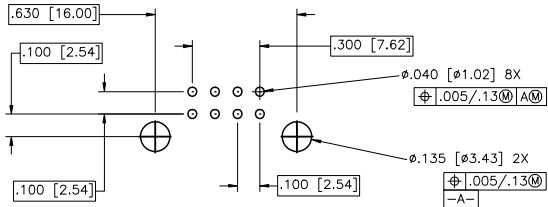

RECOMMENDED PCB LAYOUT

NOTES:

- HEADER SHROUD
MAT'L: POLYCARBONATE, 94 VO RATED.
- GROUND CONTACT
MAT'L: COPPER ALLOY
PLATING: 100-150u"/2.54-4.06u TIN.
- SIGNAL CONTACT
MAT'L: COPPER ALLOY
PLATING: SEE TABLE.
- NUMBERS SHOWN ARE FOR G.E. LEXAN AND ARE FOR REFERENCE ONLY.
- THIS ASSEMBLY U.L. APPROVED PER FILE E66906 VOL. 1, SEC 84 AND CSA APPROVED PER MASTER FILE LR 46923
- ADD LF SUFFIX AT THE END OF PART NUMBER FOR LEAD FREE OPTION.
- THIS PRODUCT MEETS EUROPEAN UNION DIRECTIVES AND OTHER COUNTRY REGULATION AS DESCRIBED IN GS-22-008.
- PLATING OPTIONS:
MAY BE EITHER GOLD OR GXT PLATED AT MANUFACTURER'S OPTION.

mat'l. code		surface	tolerance	projection	product family
ISO 1902		ISO 1902	ISO 146	ISO 1001	LATCH-N-LOK
lfr	ecr no	dr	date	title	
J				1X4 LNL RT ANGLE HEADER ASSEMBLY	
angles		linear	linear	INCH/MM	dwg no
0'±2'		linear	linear	1:1	69273
dr		J. LINN	7/17/90	scale	sheet 2 of 2
eng		D. HORCHLER	7/17/90	size	A3
chr		D. HORCHLER	7/17/90	type	Product Customer Drawing
appd		D. HORCHLER	7/17/90		
sheet	revision				
index	sheet				