

REV	DATE	DESCRIPTION	BY	CHK	APP
CM 00					
B		REVISED PER ECO-08-017244			

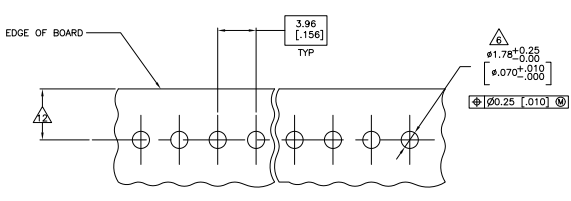
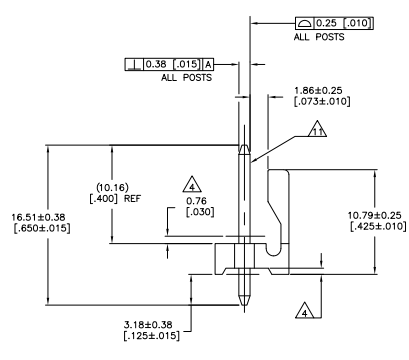
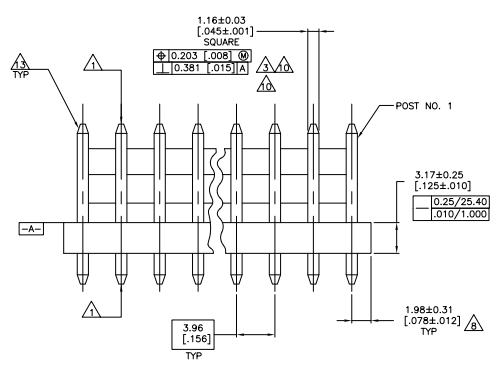
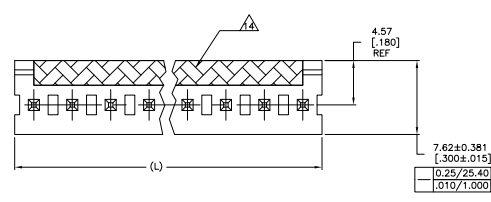

RECOMMENDED MOUNTING HOLE PATTERN FOR 1.60 [063] THICK P.C. BOARD

- △ POST TO WITHSTAND 13 NEWTONS (3LBS.) MIN. AXIAL FORCE IN BOTH DIRECTIONS SHOWN WITHOUT DISLODGING.
- △ TOLERANCES APPLY TO SOLDER SIDE OF BOARD.
- △ MEASURED AT SURFACE [-A-]
- △ PLASTIC FLASH PERMITTED IN THIS AREA.
- 5 PARTS COMPLY WITH AMP SOLDERABILITY SPEC. NO. 109-11-2.
- △ ONE HOLE MAY BE UNDERSIZED (.065/.060 DIA.) FOR ASSEMBLY RETENTION DURING WAVE SOLDERING.
- △ MATERIAL: HEADER-THERMOPLASTIC POLYESTER GLASS-FILLED 94V-0 (NATURAL) POST-COPPER ALLOY (TIN PLATED)
- △ COORDINATE DIMENSION APPLIES FROM CENTER OF ACTUAL FEATURE.
- 9 PLASTIC BURRS CAUSED BY CUT-OFF TOOLING ARE PERMITTED WITHIN THE MAXIMUM TOLERANCE ENVELOPE.
- △ POST TO BE MEASURED WHEN STRIP IS HELD FLAT.
- △ POST MUST WITHSTAND TWO 90° BENDS AGAINST EXTRUSION WITHOUT BREAKING.
- △ DIMENSION SHOULD BE 4.45 [175] MIN WHEN MATING WITH A MTA-156 CONNECTOR ASSEMBLY OR A SL-156 CONNECTOR ASSEMBLY.
- △ PIN BURR OF 0.127 [005] MAX. VERTICAL AND 0.076 [003] MAX. HORIZONTAL PERMITTED AT POST TIPS ON BOTH ENDS.
- △ COLOR STRIPE ORANGE IN APPROXIMATE LOCATION SHOWN

7.92	.312	2	647684-2
MM	[IN]	NUMBER OF POSITIONS	PART NUMBER

THIS DRAWING IS A CONTROLLED DOCUMENT.		DESIGNED BY	DR	DATE	REV
DRAWN BY		CHECKED BY	DATE	REV	
APPROVED BY		DATE	REV		
CUSTOMER DRAWING		DATE	REV		

