

4

3

2

1

THIS DRAWING IS UNPUBLISHED. RELEASED FOR PUBLICATION. ALL RIGHTS RESERVED.

LOC	DIST	REVISIONS			
F	LNK	DESCRIPTION	DATE	BY	APPD
U2		REVISED PER ECO-11-005027	12MAR11	RLK	HMR

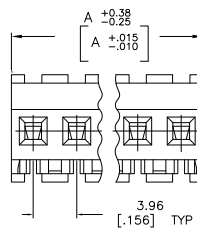
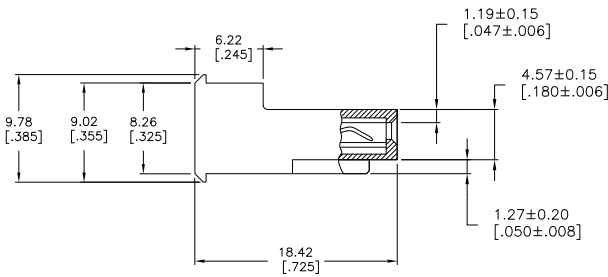
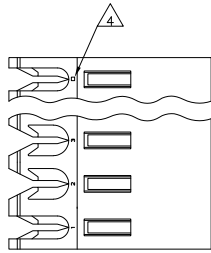

95.10	3.744	24	5-640606-4
91.14	3.588	23	5-640606-3
87.17	3.432	22	5-640606-2
83.21	3.276	21	5-640606-1
79.25	3.120	20	5-640606-0
75.29	2.964	19	4-640606-9
71.32	2.808	18	4-640606-8
67.36	2.652	17	4-640606-7
63.40	2.496	16	4-640606-6
59.44	2.340	15	4-640606-5
55.47	2.184	14	4-640606-4
51.51	2.028	13	4-640606-3
47.55	1.872	12	4-640606-2
43.59	1.716	11	4-640606-1
39.62	1.560	10	4-640606-0
35.66	1.404	9	3-640606-9
31.70	1.248	8	3-640606-8
27.74	1.092	7	3-640606-7
23.77	.936	6	3-640606-6
19.81	.780	5	3-640606-5
15.85	.624	4	3-640606-4
11.89	.468	3	3-640606-3
7.92	.312	2	3-640606-2
95.10	3.744	24	2-640606-4
91.14	3.588	23	2-640606-3
87.17	3.432	22	2-640606-2
83.21	3.276	21	2-640606-1
79.25	3.120	20	2-640606-0
75.29	2.964	19	1-640606-9
71.32	2.808	18	1-640606-8
67.36	2.652	17	1-640606-7
63.40	2.496	16	1-640606-6
59.44	2.340	15	1-640606-5
55.47	2.184	14	1-640606-4
51.51	2.028	13	1-640606-3
47.55	1.872	12	1-640606-2
43.59	1.716	11	1-640606-1
39.62	1.560	10	1-640606-0
35.66	1.404	9	640606-9
31.70	1.248	8	640606-8
27.74	1.092	7	640606-7
23.77	.936	6	640606-6
19.81	.780	5	640606-5
15.85	.624	4	640606-4
11.89	.468	3	640606-3
7.92	.312	2	640606-2
DIM A		NO OF CIRCUITS	PART NO

△ MATERIAL: CONNECTOR - NYLON UL94V-2 (RED)
 CONTACTS - 0.30[.012] THICK COPPER ALLOY
 (BRIGHT TIN-LEAD 0.00203[.000080] MIN. THICK
 FOR CONTACTS 640606-2 THRU 2-640606-4)
 (MATTE WHISKER MITIGATED TIN 0.00203[.000080] MIN
 THICKNESS OVER NICKEL UNDERPLATE FOR 3-640606-2
 THRU 5-640606-4).

- 2 CONTACTS ACCEPT 22 AWG WIRE WITH 2.41[.095] MAX INSULATION DIAMETER.
- 3 CONTACTS MUST ACCEPT 1.14±0.03[.045±.001] SQUARE POST AND REMAIN LOCKED IN POSITION.
- △ IDENTIFICATION NUMBER FOR LAST CIRCUIT MAY NOT APPEAR ON ALL ASSEMBLIES.

- 5 DIMENSIONS IN BRACKETS ARE IN INCHES.
- 6 HOUSING FEATURES ARE: FEED-THRU WITHOUT LOCKING RAMP.

△ OBSOLETE PARTS: OBSOLETE CIS STREAMLINING PER D.RENAUD/D.SINISI



THIS DRAWING IS A CONTROLLED DOCUMENT.

DIMENSIONS: mm [INCHES]	TOLERANCES UNLESS OTHERWISE SPECIFIED: 0 PLG ± .005 1 PLG ± .005 2 PLG ± .005 3 PLG ± .005 4 PLG ± .005 ANGLES ± .005	DRN S. LEWIS 12FEB91	CHK R. SWING 12FEB91	APPR D. CLARK 12FEB91	NAME 108-1051	SIZE A2	CASE CODE 00779	DRAWING NO C-640606	RESTRICTED TO -	
MATERIAL △		FINISH △		APPLICATION SPEC 114-1020		CUSTOMER DRAWING		SCALE 4:1	SHEET 1 of 1	REV U2

TE Connectivity
 MTA-156 CONNECTOR ASSEMBLY,
 22 AWG, STANDARD