

PRODUCT NO.	CABLES
62435-001	RG196A/U RG178B/U 0.8DS-PBE
-001LF	
62435-101	RG196A/U RG178B/U 0.8DS-PBE
-101LF	

① INNER CONTACT

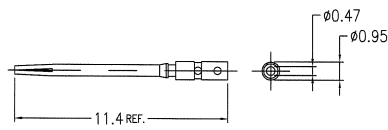

② BODY

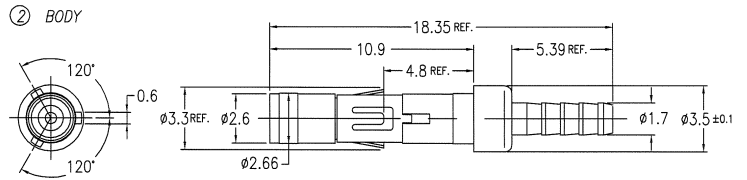

③ CRIMP SLEEVE

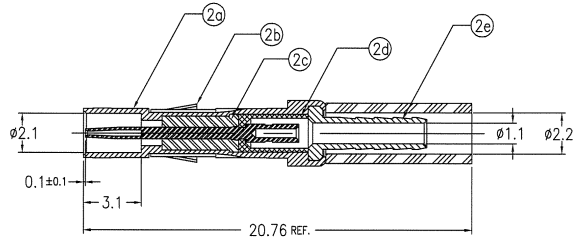
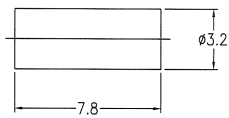

AFTER ASSY

NOTES

- PULL OUT FOR OF CENTER CONTACT MUST BE 0.2N MIN. / 0.8N MAX.
- ASSEMBLE PRODUCT WITH TOOL HT430 USE INSERTS EPL 193460-001
- FOR LEAD FREE P/N, THE PRODUCT MEET EUROPEAN UNION DIRECTIVES AND OTHER COUNTRY REGULATIONS AS DESCRIBED IN GS-22-008
- THE PRODUCT IS NOT INTENDED TO BE EXPOSED TO A MANUFACTURING SOLDER PROCESS.

No.	DESCRIPTION	MATERIAL	PLATING
①	INNER CONTACT	BERYLLIUM COPPER	Au 1.27um MIN. (FOR -001) Au 0.8um MIN. (FOR -101)
②	BODY		
②a	SHELL	BRASS	Au 1.27um MIN. (FOR -001) Au 0.8um MIN. (FOR -101)
②b	SPRING CLIP	BERYLLIUM COPPER	Ni 1.27um MIN.
②c	FRONT INSULATOR	PTFE	
②d	REAR INSULATOR	PTFE	
②e	FERRULE	BRASS	Au 0.05um MIN.
③	CRIMP SLEEVE	BRASS	Au 0.05um MIN. (FOR -001) Ni 1.27um MIN. (FOR -101)

ltr	description	ecn no	dr	date	surface	tolerance	projection	product family	CODE
D	REVISED	J00331	Y.K	5/10/00	ISO 1302	ISO 406 ISO 1101	MM	METRAL	JP
E	REVISED	J00951	Y.K	12/12/00	angles	0.XX ±0.2	MM	METRAL MINICOAX CONTACT KIT	
F	REVISED	J10393	Y.K	7/6/01	linear	0.XXX ±0.2	scale 5:1	FEMALE SOLDER-TO-WIRE	
G	REVISED	J20204	Y.K	4/10/02	dr	Y.KODAIRA 1/28/99		dwg no	sheet 1 of 8 size
H	REVISED	J03-0172	Y.K	4/10/03	enrg	S.OKUDAIRA 1/22/07		62435	A3
J	REVISED	J05-0670	T.S	10/21/05	chr	K. Shiroki 1/21/07			
K	REVISED	J07-0039	S.O	1/22/07	appd	S. M. M. 1/22/07		type	Customer Drawing
sheet index	revision	K	F	E	D	C	C		Rev.
	sheet	1	2	3	4	5	6	7	8

PRODUCT NO.	CABLES
62435-002	RG188A/U
-002LF	RG316/U
62435-102	RG188A/U
-102LF	RG316/U

① INNER CONTACT

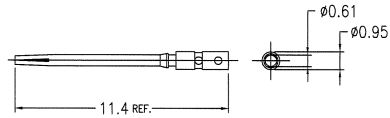

② BODY

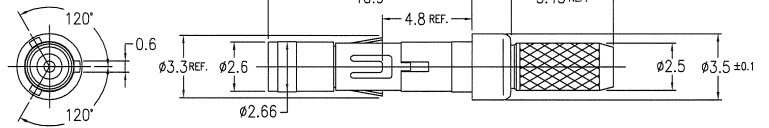

③ CRIMP SLEEVE

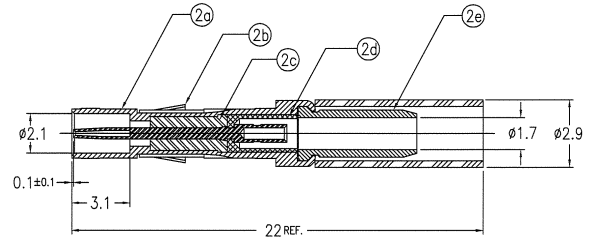
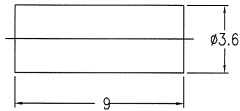

No.	DESCRIPTION	MATERIAL	
①	INNER CONTACT	BERYLLIUM COPPER	Au 1.27µm MIN. (FOR -002) Au 0.8µm MIN. (FOR -102)
②	BODY		
②a	SHELL	BRASS	Au 1.27µm MIN. (FOR -002) Au 0.8µm MIN. (FOR -102)
②b	SPRING CLIP	BERYLLIUM COPPER	Ni 1.27µm MIN.
②c	FRONT INSULATOR	PTFE	
②d	REAR INSULATOR	PTFE	
②e	FERRULE	BRASS	Au 0.05µm MIN.
③	CRIMP SLEEVE	BRASS	Au 0.05µm MIN. (FOR -002) Ni 1.27µm MIN. (FOR -102)

NOTES

- PULL OUT FOR OF CENTER CONTACT MUST BE 0.2N MIN. / 0.8N MAX.
- ASSEMBLE PRODUCT WITH TOOL HT430 USE INSERTS EPL 193460-001
- FOR LEAD FREE P/N, THE PRODUCT MEET EUROPEAN UNION DIRECTIVES AND OTHER COUNTRY REGULATIONS AS DESCRIBED IN GS-22-008
- THE PRODUCT IS NOT INTENDED TO BE EXPOSED TO A MANUFACTURING SOLDER PROCESS.

AFTER ASSY

mat'l. code	---	surface	ISO 1302	tolerance	ISO 406	projection	product family	METRAL	CODE	JP
ltr	description	ecn no	dr	date	tolerances unless otherwise specified	MM	title			
A	REVISED	J90110	Y.K	3/31/99	angles	0.XX ±0.2	METRAL MINICOAX CONTACT KIT			
B	REVISED	J00062	Y.K	1/21/00	linear	0.XX ±0.2	FEMALE SOLDER-TO-WIRE			
C	REVISED	J00331	Y.K	5/10/00	0°±3'	0.XXX ±0.2	scale 5:1			
D	REVISED	J20204	Y.K	4/10/02	dr	Y.KODAIRA	3/31/99			
E	REVISED	J05-0670	T.S	10/21/05	enrg	S.OKUDAIRA	1/22/07			
F	REVISED	J07-0039	S.O	1/22/07	chr	K. Atsuya	1/22/07			
sheet index							revision	sheet	type	Customer Drawing
sheet index							revision	sheet	type	Customer Drawing

PRODUCT NO.	CABLES	CABLES
62435-003	DOUBLE SHIELDED TYPE M17/152-0001(HARBOUR INDUSTRIES)	
-003LF		
62435-103	DOUBLE SHIELDED TYPE M17/152-0001(HARBOUR INDUSTRIES)	
-103LF		

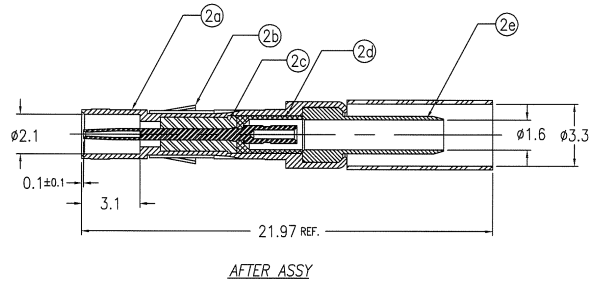
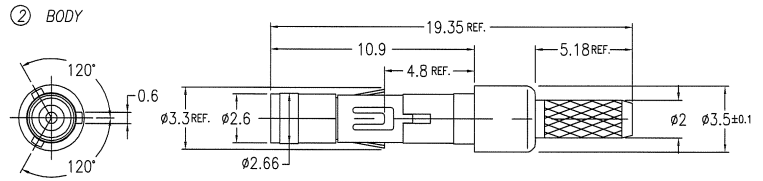
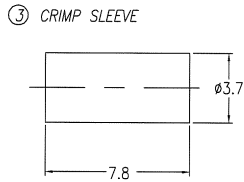
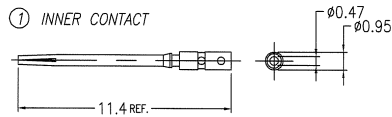

No.	DESCRIPTION	MATERIAL	PLATING
①	INNER CONTACT	BERYLLIUM COPPER	Au 1.27um MIN. (FOR -003) Au 0.8um MIN. (FOR -103)
②	BODY		
②a	SHELL	BRASS	Au 1.27um MIN. (FOR -003) Au 0.8um MIN. (FOR -103)
②b	SPRING CLIP	BERYLLIUM COPPER	Ni 1.27um MIN.
②c	FRONT INSULATOR	PTFE	
②d	REAR INSULATOR	PTFE	
②e	FERRULE	BRASS	Au 0.05um MIN.
③	CRIMP SLEEVE	BRASS	Au 0.05um MIN. (FOR -003) Ni 1.27um MIN. (FOR -103)

NOTES

- PULL OUT FOR OF CENTER CONTACT MUST BE 0.2N MIN. / 0.8N MAX.
- ASSEMBLE PRODUCT WITH TOOL HT430 USE INSERTS EPL 193460-001
- FOR LEAD FREE P/N, THE PRODUCT MEET EUROPEAN UNION DIRECTIVES AND OTHER COUNTRY REGULATIONS AS DESCRIBED IN GS-22-008
- THE PRODUCT IS NOT INTENDED TO BE EXPOSED TO A MANUFACTURING SOLDER PROCESS.

mat'l. code	---	surface	ISO 1302	tolerance	ISO 406	projection	product family	METRAL	CODE	JP
ltr	description	ecm no	dr	date	tolerances unless otherwise specified	angles	linear	0.XX ±0.2	0.XXX ±0.2	scale 5:1
A	RELEASED	J90036	Y.K	1/28/99						
B	REVISED	J00062	Y.K	1/21/00						
C	REVISED	J00331	Y.K	5/10/00						
D	REVISED	J05-0670	T.S	10/21/05	dr	Y.KODAIRA	1/28/99			
E	REVISED	J07-0039	S.O	1/22/07	enrg	S.OKUDAIRA	1/22/07			
					chr	R. Arisawa	1/22/07			
					app	J. Okada	1/22/07			
sheet	revision									
index	sheet									
							product family	METRAL	CODE	JP
							title	METRAL MINICOAX CONTACT KIT FEMALE SOLDER-TO-WIRE		
							dwg no	62435	sheet 3 of	size
							type	Customer Drawing		A3
							Rev.	E		

PRODUCT NO.	CABLES
62435-004	1.5C-XV (SUMITOMO)
-004LF	1.5C-QEV.CW (FUJIKURA)
62435-104	1.5C-XV (SUMITOMO)
-104LF	1.5C-QEV.CW (FUJIKURA)

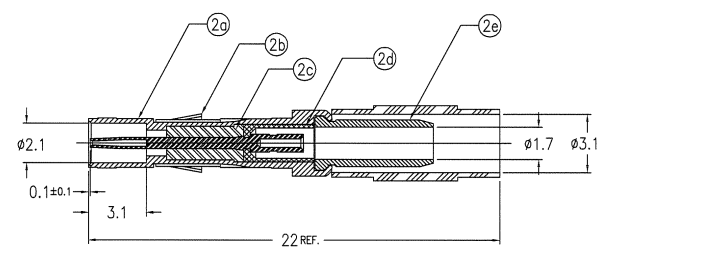
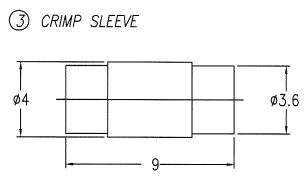
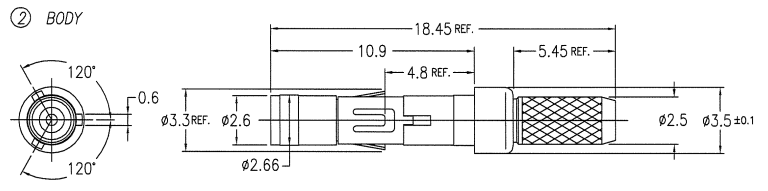
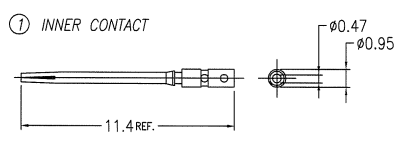

No.	DESCRIPTION	MATERIAL	PLATING
①	INNER CONTACT	BERYLLIUM COPPER	Au 1.27um MIN. (FOR -004) Au 0.8um MIN. (FOR -104)
②	BODY		
②a	SHELL	BRASS	Au 1.27um MIN. (FOR -004) Au 0.8um MIN. (FOR -104)
②b	SPRING CLIP	BERYLLIUM COPPER	Ni 1.27um MIN.
②c	FRONT INSULATOR	PTFE	
②d	REAR INSULATOR	PTFE	
②e	FERRULE	BRASS	Au 0.05um MIN.
③	CRIMP SLEEVE	BRASS	Au 0.05um MIN. (FOR -004) Ni 1.27um MIN. (FOR -104)

NOTES

- PULL OUT FOR OF CENTER CONTACT MUST BE 0.2N MIN. / 0.8N MAX.
- ASSEMBLE PRODUCT WITH TOOL HT430 USE INSERTS EPL 193460-001
- FOR LEAD FREE P/N, THE PRODUCT MEET EUROPEAN UNION DIRECTIVES AND OTHER COUNTRY REGULATIONS AS DESCRIBED IN GS-22-008
- THE PRODUCT IS NOT INTENDED TO BE EXPOSED TO A MANUFACTURING SOLDER PROCESS.

mat'l. code	---	surface ISO 1302	tolerance ISO 406 ISO 1101	projection	product family	METRAL	CODE JP
ltr	description	ecn no	dr	date	tolerances unless otherwise specified	title	
A	RELEASED	J90036	Y.K	1/28/99	angles linear	METRAL MINICOAX CONTACT KIT FEMALE SOLDER-TO-WIRE	
B	REVISED	J00062	Y.K	1/21/00	0.XX ±0.2		
C	REVISED	J00331	Y.K	5/10/00	0.XXX ±0.2		
D	REVISED	J05-0670	T.S	10/21/05	0 ±3'	scale 5:1	
E	REVISED	J07-0039	S.O	1/22/07			
sheet index		revision sheet		dr Y.KODAIRA 1/28/99 engr S.OKUDAIRA 1/22/07 chr R. Shewji 1/22/07 apbd S. Okuda 1/22/07		dwg no 62435 sheet 4 of size A3 type Customer Drawing	Rev. E

PRODUCT NO.	CABLES
62435-005	1.5C-XW (SUMITOMO)
-005LF	
62435-105	1.5C-XW (SUMITOMO)
-105LF	

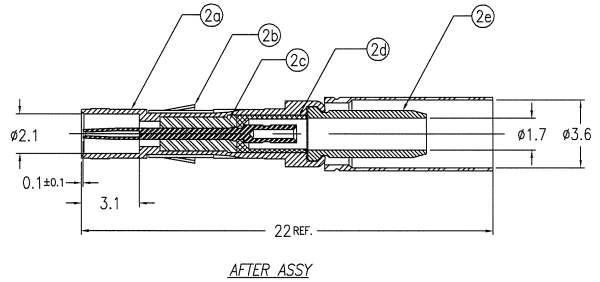
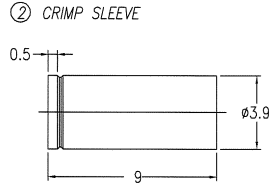
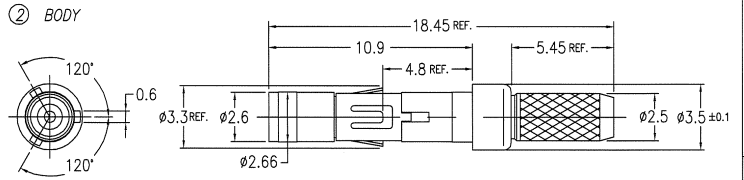
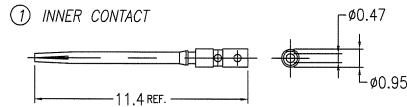

No.	DESCRIPTION	MATERIAL	PLATING
①	INNER CONTACT	BERYLLIUM COPPER	Au 1.27um MIN. (FOR -005) Au 0.8um MIN. (FOR -105)
②	BODY		
②a	SHELL	BRASS	Au 1.27um MIN. (FOR -005) Au 0.8um MIN. (FOR -105)
②b	SPRING CLIP	BERYLLIUM COPPER	Ni 1.27um MIN.
②c	FRONT INSULATOR	PTFE	
②d	REAR INSULATOR	PTFE	
②e	FERRULE	BRASS	Au 0.05um MIN.
③	CRIMP SLEEVE	BRASS	Au 0.05um MIN. (FOR -005) Ni 1.27um MIN. (FOR -105)

NOTES

- PULL OUT FOR OF CENTER CONTACT MUST BE 0.1N MIN. / 0.8N MAX.
- ASSEMBLE PRODUCT WITH TOOL HT430 USE INSERTS EPL 193460-001
- FOR LEAD FREE P/N, THE PRODUCT MEET EUROPEAN UNION DIRECTIVES AND OTHER COUNTRY REGULATIONS AS DESCRIBED IN GS-22-008
- THE PRODUCT IS NOT INTENDED TO BE EXPOSED TO A MANUFACTURING SOLDER PROCESS.

mat'l. code	---	surface	ISO 1302	tolerance	ISO 406	projection	product family	METRAL	CODE	JP		
ltr	description	ecn no	dr	date	tolerances unless otherwise specified	angles	linear	0.XX ±0.2	MM	title		
A	RELEASED	J00062	Y.K	1/21/00	0°±3'	linear	0.XX ±0.2	0.XXX ±0.2	scale 5:1	METRAL MINICOAX CONTACT KIT FEMALE SOLDER-TO-WIRE		
B	REVISED	J00331	Y.K	5/10/00						dwg no	sheet 5 of	size
C	REVISED	J05-0670	T.S	10/21/05						62435	A3	
D	REVISED	J07-0039	S.O	1/22/07						type	Customer Drawing	Rev.
											D	
sheet index	revision sheet											

PRODUCT NO.	CABLES
62435-006	RG187A/U RG179B/U
-006LF	
62435-106	RG187A/U RG179B/U
-106LF	

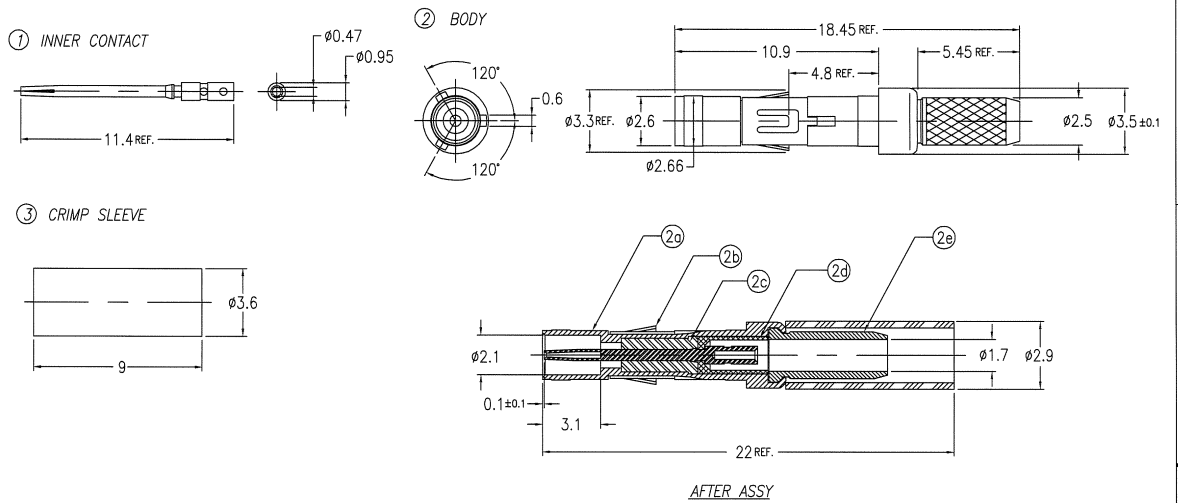

No.	DESCRIPTION	MATERIAL	PLATING
①	INNER CONTACT	BERYLLIUM COPPER	Au 1.27µm MIN. (FOR -006) Au 0.8µm MIN. (FOR -106)
②	BODY		
②a	SHELL	BRASS	Au 1.27µm MIN. (FOR -006) Au 0.8µm MIN. (FOR -106)
②b	SPRING CLIP	BERYLLIUM COPPER	Ni 1.27µm MIN.
②c	FRONT INSULATOR	PTFE	
②d	REAR INSULATOR	PTFE	
②e	FERRULE	BRASS	Au 0.05µm MIN.
③	CRIMP SLEEVE	BRASS	Au 0.05µm MIN. (FOR -006) Ni 1.27µm MIN. (FOR -106)

NOTES

- PULL OUT FOR OF CENTER CONTACT MUST BE 0.2N MIN. / 0.8N MAX.
- ASSEMBLE PRODUCT WITH TOOL HT430 USE INSERTS EPL 193460-001
- FOR LEAD FREE P/N, THE PRODUCT MEET EUROPEAN UNION DIRECTIVES AND OTHER COUNTRY REGULATIONS AS DESCRIBED IN GS-22-008
- THE PRODUCT IS NOT INTENDED TO BE EXPOSED TO A MANUFACTURING SOLDER PROCESS.

mat'l. code		surface ISO 1302		tolerance ISO 406		projection		product family		CODE	
---		✓		ISO 1101		⊕		METRAL		JP	
tr		description		ecn no		dr		date		title	
A		RELEASED		J00951		Y.K		12/12/00		METRAL MINICOAX CONTACT KIT	
B		REVISED		J05-0670		T.S		10/21/05		FEMALE SOLDER-TO-WIRE	
C		REVISED		J07-0039		S.O		1/22/07		scale 5:1	
						dr		Y.KODAIRA		12/12/00	
						enrg		S.OKUDAIRA		1/22/07	
						chr		R. Shigetani		1/22/07	
						appd		S. Okudaira		1/22/07	
sheet index		revision sheet								dwg no	
3		1		2		3		4		62435	
										sheet 6 of	
										size	
										A3	
										type	
										Customer Drawing	
										Rev.	
										C	

PRODUCT NO.	CABLES
62435-007	1.5DS-PBP
-007LF	
62435-107	1.5DS-PBP
-107LF	

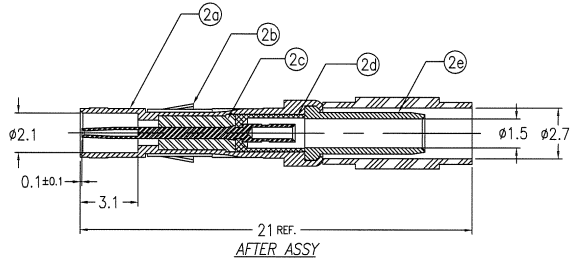
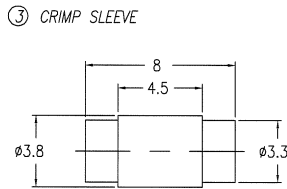
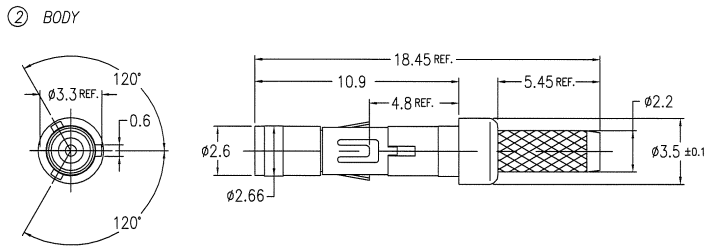
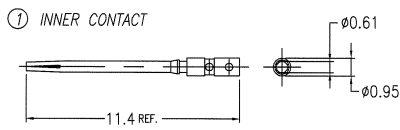

No.	DESCRIPTION	MATERIAL	PLATING
①	INNER CONTACT	BERYLLIUM COPPER	Au 1.27um MIN. (FOR -001) Au 0.8um MIN. (FOR -101)
②	BODY		
②a	SHELL	BRASS	Au 1.27um MIN. (FOR -001) Au 0.8um MIN. (FOR -101)
②b	SPRING CLIP	BERYLLIUM COPPER	Ni 1.27um MIN.
②c	FRONT INSULATOR	PTFE	
②d	REAR INSULATOR	PTFE	
②e	FERRULE	BRASS	Au 0.05um MIN.
③	CRIMP SLEEVE	BRASS	Au 0.05um MIN. (FOR -001) Ni 1.27um MIN. (FOR -101)

NOTES

- PULL OUT FOR OF CENTER CONTACT MUST BE 0.2N MIN. / 0.8N MAX.
- ASSEMBLE PRODUCT WITH TOOL HT430 USE INSERTS EPL 193460-001
- FOR LEAD FREE P/N, THE PRODUCT MEET EUROPEAN UNION DIRECTIVES AND OTHER COUNTRY REGULATIONS AS DESCRIBED IN GS-22-008
- THE PRODUCT IS NOT INTENDED TO BE EXPOSED TO A MANUFACTURING SOLDER PROCESS.

mat'l. code		surface		tolerance		projection		product family		CODE	
---		ISO 1302		ISO 408		MM		METRAL		JP	
description		ecn no		date		tolerances unless otherwise specified		title			
A RELEASED		J10393		Y.K 7/6/01		0.X ±0.2		METRAL MINICOAX CONTACT KIT			
B REVISED		J05-0670		T.S 10/21/05		0.XX ±0.2		FEMALE SOLDER-TO-WIRE			
C REVISED		J07-0039		S.O 1/22/07		0.XXX ±0.2		scale 5:1			
dr		Y.KODAIRA		7/6/01		FCJ		dwg no		sheet 7 of size	
enrg		S.OKUDAIRA		1/22/07				62435		A3	
chr		R. Shoji		1/22/07				type		Customer Drawing	
apbd		J. Boudreau		1/22/07						Rev. C	
sheet index		revision sheet									

PRODUCT NO.	CABLES
62435-108	1.5DS-xx, 1.5D-xx
-108LF	

① INNER CONTACT

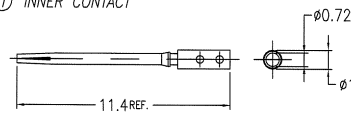

② BODY

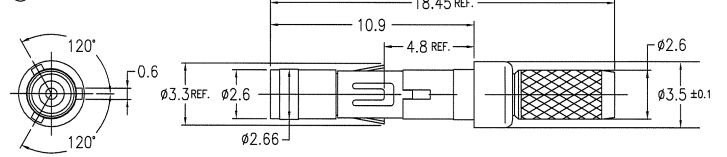

③ CRIMP SLEEVE

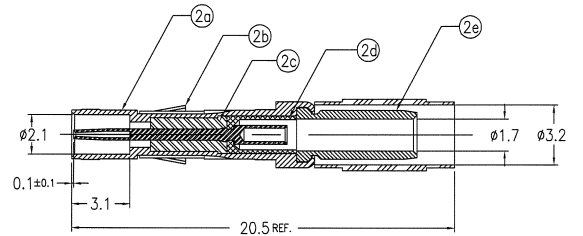
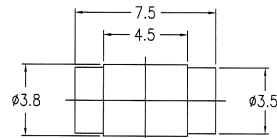

AFTER ASSY

No.	DESCRIPTION	MATERIAL	PLATING
①	INNER CONTACT	BERYLLIUM COPPER	Au 0.8um MIN.
②	BODY		
②a	SHELL	BRASS	Au 0.8um MIN.
②b	SPRING CLIP	BERYLLIUM COPPER	Ni 1.27um MIN.
②c	FRONT INSULATOR	PTFE	
②d	REAR INSULATOR	PTFE	
②e	FERRULE	BRASS	Au 0.05um MIN.
③	CRIMP SLEEVE	BRASS	Ni 1.27um MIN.

NOTES

- PULL OUT FOR OF CENTER CONTACT MUST BE 0.2N MIN. / 0.8N MAX.
- ASSEMBLE PRODUCT WITH TOOL HT430 USE INSERTS EPL 193460-001
- FOR LEAD FREE P/N, THE PRODUCT MEET EUROPEAN UNION DIRECTIVES AND OTHER COUNTRY REGULATIONS AS DESCRIBED IN GS-22-008
- THE PRODUCT IS NOT INTENDED TO BE EXPOSED TO A MANUFACTURING SOLDER PROCESS.

mat'l. code	---	surface ISO 1302	tolerance ISO 408 ISO 1101	projection	product family METRAL	CODE JP
ltr	description	ecn no	dr	date	tolerances unless otherwise specified	title
A	RELEASED	J03-0172	Y.K	4/10/03	angles linear 0.X ±0.2	METRAL MINICOAX CONTACT KIT FEMALE SOLDER-TO-WIRE
B	REVISED	J05-0670	T.S	10/21/05	0°.XXX ±0.2	
C	REVISED	J07-0039	S.O	1/22/07	0°±3'	
					scale 5:1	
					dr Y.KODAIRA 4/10/03	dwg no
					enrg S.OKUDAIRA 1/22/07	sheet 8 of
					chr R. Hironaka 1/22/07	size
					appd S. Okuda 1/22/07	A3
sheet index	revision sheet				FCJ	type Customer Drawing
						Rev. C