

4

3

2

1

THIS DRAWING IS UNPUBLISHED. RELEASED FOR PUBLICATION
 © COPYRIGHT BY TYCO ELECTRONICS CORPORATION. ALL INTERNATIONAL RIGHTS RESERVED.

LOC	DIST	REVISIONS			
P	LTR	DESCRIPTION	DATE	DWN	APVD
G1		REVISED PER ECO-09-009918	4/23/09	SS	PD

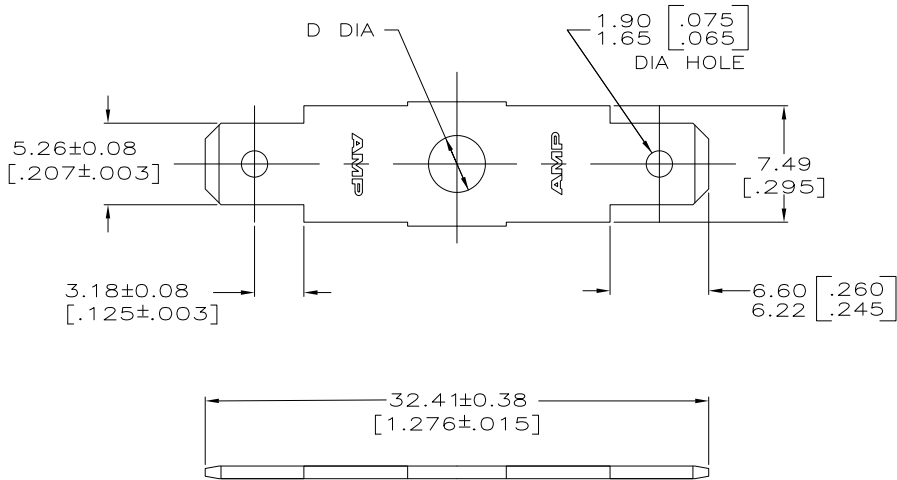

- 1 SUPPLIED IN LOOSE PIECE.
 2 ELECTRICAL TEST TAB ONLY.

3.68 [.145]	6	0.002032 [.000080] MIN TIN	0.813±0.012 [.032±.0005] CR STEEL	60922-5
3.68 [.145]	6	0.002032 [.000080] MIN TIN	0.813±0.025 [.032±.001] BRASS	60922-4
OBSOLETE 5.00 [.197]	10	-	0.813±0.025 [.032±.001] BRASS	60922-3
4.34 [.171]	8	-	0.813±0.025 [.032±.001] BRASS	60922-2
3.68 [.145]	6	-	0.813±0.007 [.032±.0003] BRASS	60922-1
± 0.076 DIA [.003]	STUD #	FINISH	MATERIAL	PART NO.
THIS DRAWING IS A CONTROLLED DOCUMENT.		DWN JR RUTH 8/6/96 CHK MS FEHER 8/6/96 APVD P DESANTIS 8/6/96		
DIMENSIONS: mm [INCHES]		Tyco Electronics Corporation Harrisburg, PA 17105-3608		
TOLERANCES UNLESS OTHERWISE SPECIFIED:		NAME TAB, FASTON, 5.21 [.205] SERIES		
0 PLC ± -		PRODUCT SPEC -		
1 PLC ± -		APPLICATION SPEC -		
2 PLC ± 0.25 [.010]		SIZE A3 CAGE CODE C-60922 DRAWING NO - RESTRICTED TO -		
3 PLC ± -		WEIGHT -		
4 PLC ± -		CUSTOMER DRAWING SCALE 4:1 SHEET 1 OF 1 REV G1		
ANGLES ± -				
MATERIAL	FINISH			
SEE TABLE	SEE TABLE			