

Dialight

.....

Based LED Selector Guide

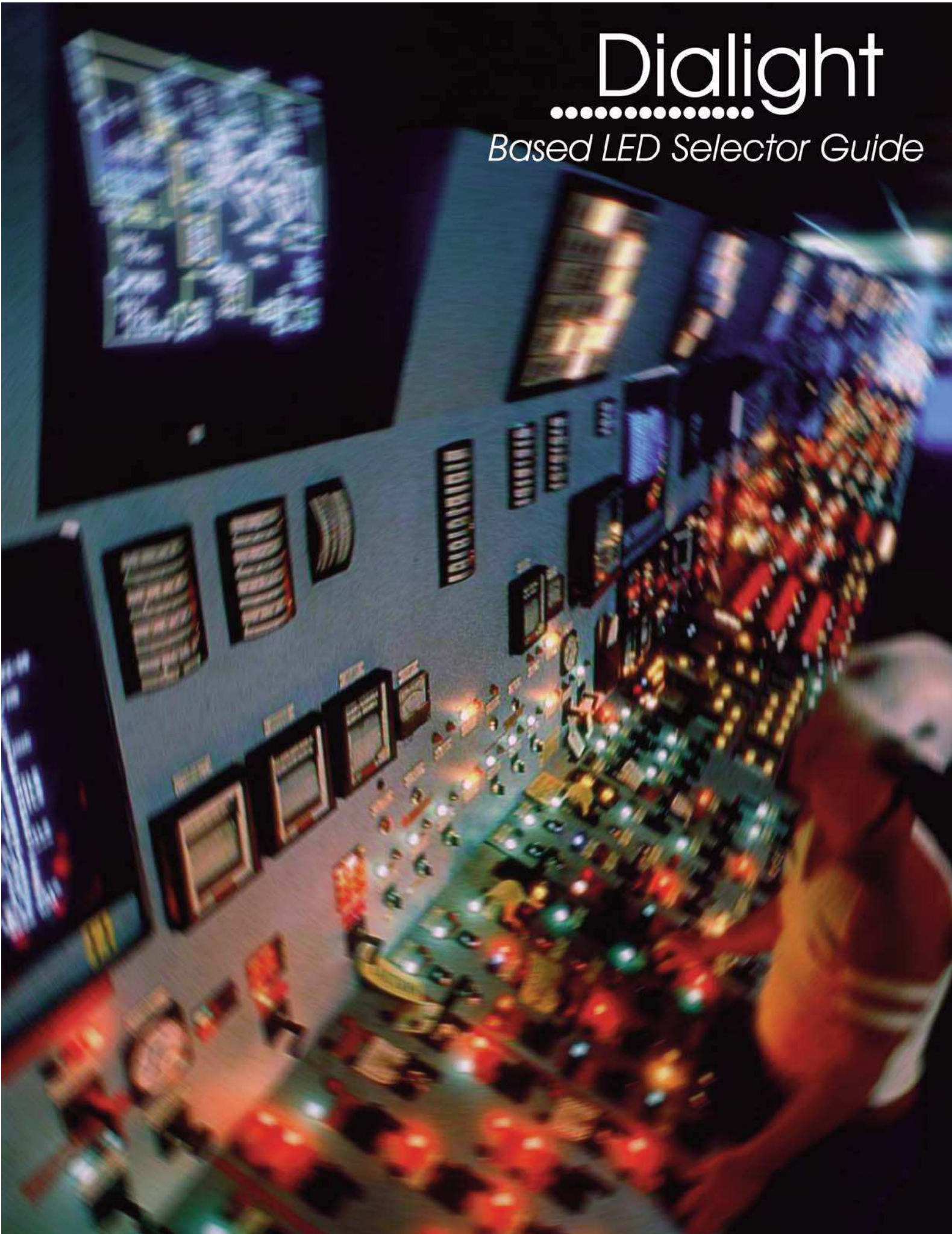

With the technological advancements in Light Emitting Diodes (LEDs) brightness can now rival the incandescent lamp when used in similar packages. These advancements have allowed for a new type of product called the *Based LED* - an LED with the fit and functionality of an incandescent light bulb.

Dialight's line of based LEDs were designed with flexibility and efficiency in mind.

- ▲ RoHS compliant
- ▲ Longer life
- ▲ Energy savings - 90% less power required
- ▲ High reliability - vibration and shock resistant
- ▲ Multi-chip, Cluster, and Single Ultra-Bright Chip
- ▲ AllInGaP and InGaN die technology
- ▲ Polarized and non-polarized
- ▲ Single and multi-voltage input



| BASE STYLE | CONFIG. | RED | GREEN | YELLOW | BLUE | WHITE | 6 VDC | 12/14* VDC | 24/28* VDC | 120 VAC | POLARIZED | NON-POLARIZED | 6-36 AC/DC | RoHS Compliant |
|---------------------------------|--------------------|-----|-------|--------|------|-------|-------|------------|------------|---------|-----------|---------------|------------|----------------|
| T1 3/4 Midget Flange | Single Chip | ✓ | ✓ | ✓ | ✓ | ✓ | ✓ | ✓ | ✓ | | ✓ | | | ✓ |
| T1 3/4 Midget Flange | Multi Chip | ✓ | ✓ | ✓ | | | ✓ | ✓ | ✓ | | ✓ | ✓ | | |
| T1 3/4 Wedge (T5) | Multi Chip | ✓ | ✓ | ✓ | | | ✓ | ✓ | ✓ | | ✓ | ✓ | | |
| T1 3/4 Wedge (T5) | Single / Dual Chip | ✓ | ✓ | ✓ | ✓ | ✓ | ✓ | ✓ | ✓ | | | ✓ | | ✓ |
| T1 3/4 Bi-Pin | Single Chip | ✓ | ✓ | ✓ | ✓ | ✓ | ✓ | ✓ | ✓ | | ✓ | | | ✓ |
| T1 3/4 Bi-Pin | Multi Chip | ✓ | ✓ | ✓ | | | ✓ | ✓ | ✓ | | ✓ | ✓ | | |
| T2 Telephone Slide | Single Chip | ✓ | ✓ | ✓ | ✓ | ✓ | | | ✓ | | | ✓ | | ✓ |
| T3 1/4 Miniature Bayonet (BA9s) | Single Chip | ✓ | ✓ | ✓ | ✓ | ✓ | ✓ | ✓ | ✓ | | ✓ | ✓ | ✓ | ✓ |
| T3 1/4 Miniature Bayonet (BA9s) | Cluster | ✓ | ✓ | ✓ | ✓ | ✓ | ✓ | ✓ | ✓ | ✓ | ✓ | ✓ | | ✓ |
| T3 1/4 Miniature Screw (E10) | Single Chip | ✓ | ✓ | ✓ | ✓ | ✓ | ✓ | ✓ | ✓ | | | ✓ | ✓ | ✓ |
| T3 1/4 Wedge (T10) | Cluster | ✓ | ✓ | ✓ | ✓ | ✓ | ✓ | ✓ | ✓ | | | ✓ | | ✓ |
| 15mm Bayonet (BA15s) | Cluster | ✓ | ✓ | ✓ | ✓ | ✓ | | | ✓ | ✓ | ✓ | | | ✓ |

Considerations:

- ▲ Since lens caps act as filters for the light emitted from the based LED, it is important to match the emitting color of the LED. If not matched properly, the overall light output may be substantially reduced. Dialight recommends using transparent lenses, which will optimize the light output.
- ▲ Although these lamps can be operated at a lower voltage, which will increase the life, the intensity will be reduced.
- ▲ Operation of the based LED at a higher voltage should not exceed 10% above the recommended voltage.
- ▲ Dialight does not recommend that based LED lamps be used in neon sockets.

Dialight

586 Series Single Chip BASED LED T 1 3/4 MIDGET FLANGE

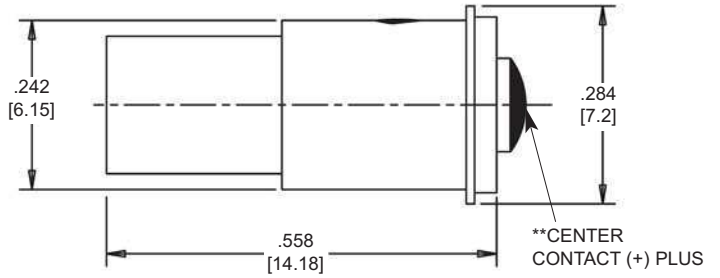

Measurements are typical
Dimensions are inches [mm]

T 1 3/4 MIDGET FLANGE - POLARIZED

| PART NUMBER | COLOR | PEAK WAVELENGTH (nm) | VOLTAGE (VDC) | CURRENT TYP.-(mA) | INTENSITY TYP.-(mcd) | RoHS COMPLIANT |
|---------------|--------|----------------------|---------------|-------------------|----------------------|----------------|
| 586-1101-101F | Red | 639 | 6 | 10 | 775 | ✓ |
| 586-1102-101F | Green | 520 | 6 | 10 | 600 | ✓ |
| 586-1103-101F | Yellow | 592 | 6 | 10 | 775 | ✓ |
| 586-1105-101F | Blue | 467 | 6 | 10 | 210 | ✓ |
| 586-1106-101F | White | * | 6 | 10 | 460 | ✓ |
| 586-1101-103F | Red | 639 | 14 | 10 | 775 | ✓ |
| 586-1102-103F | Green | 520 | 14 | 10 | 600 | ✓ |
| 586-1103-103F | Yellow | 592 | 14 | 10 | 775 | ✓ |
| 586-1105-103F | Blue | 467 | 14 | 10 | 210 | ✓ |
| 586-1106-103F | White | * | 14 | 10 | 460 | ✓ |
| 586-1101-105F | Red | 639 | 28 | 10 | 775 | ✓ |
| 586-1102-105F | Green | 520 | 28 | 10 | 600 | ✓ |
| 586-1103-105F | Yellow | 592 | 28 | 10 | 775 | ✓ |
| 586-1105-105F | Blue | 467 | 28 | 10 | 210 | ✓ |
| 586-1106-105F | White | * | 28 | 10 | 460 | ✓ |

* Color coordinates: x = .320, y = .320

** (Center Contact Negative Versions Available)

Dialight

585 Series

Multi-Chip BASED LED T1 3/4 Midget Flange

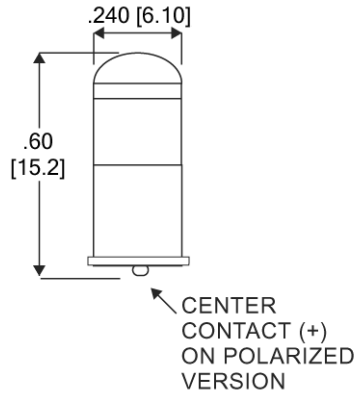

Measurements are typical
Dimensions are inches [mm]

POLARIZED

| Part Number | Color | Peak Wavelength (nm) | Voltage (VDC) | Current TYP.-(mA) | Intensity TYP.-(mcd) |
|-------------|--------|----------------------|---------------|-------------------|----------------------|
| 585-1211 | Red | 660 | 6 | 50 | 67 |
| 585-1311 | Green | 565 | 6 | 46 | 77 |
| 585-1411 | Yellow | 585 | 6 | 44 | 22 |
| 585-1213 | Red | 660 | 14 | 30 | 60 |
| 585-1313 | Green | 565 | 14 | 28 | 70 |
| 585-1413 | Yellow | 585 | 14 | 30 | 23 |
| 585-1215 | Red | 660 | 28 | 16 | 64 |
| 585-1315 | Green | 565 | 28 | 15 | 75 |
| 585-1415 | Yellow | 585 | 28 | 15 | 23 |

NON-POLARIZED

| Part Number | Color | Peak Wavelength (nm) | Voltage (VDC) | Current TYP.-(mA) | Intensity TYP.-(mcd) |
|-------------|--------|----------------------|---------------|-------------------|----------------------|
| 585-1221 | Red | 660 | 6 | 75 | 50 |
| 585-1321 | Green | 565 | 6 | 67 | 56 |
| 585-1421 | Yellow | 585 | 6 | 73 | 18 |
| 585-1223 | Red | 660 | 14 | 26 | 50 |
| 585-1323 | Green | 565 | 14 | 23 | 56 |
| 585-1423 | Yellow | 585 | 14 | 24 | 18 |
| 585-1225 | Red | 660 | 28 | 14 | 56 |
| 585-1325 | Green | 565 | 28 | 13 | 65 |
| 585-1425 | Yellow | 585 | 28 | 13 | 20 |

Dialight

586 Series SINGLE CHIP BASED LED T1 3/4 WEDGE (T5)

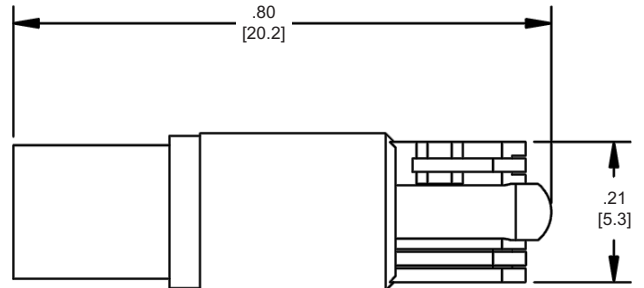

Measurements are typical
Dimensions are inches [mm]

T1 3/4 WEDGE (T5) POLARIZED

| Part Number | Color | Dominant Wavelength (TYP- nm) | Nominal Voltage (VDC) | Forward Current TYP-(mA) | Intensity TYP.-(mcd) | RoHS Compliant |
|---------------|--------|-------------------------------|-----------------------|--------------------------|----------------------|----------------|
| 586-1A01-101F | Red | 630 | 6 | 16 | 775 | ✓ |
| 586-1A02-101F | Green | 526 | 6 | 16 | 600 | ✓ |
| 586-1A03-101F | Yellow | 592 | 6 | 16 | 775 | ✓ |
| 586-1A04-101F | Orange | 615 | 6 | 16 | 775 | ✓ |
| 586-1A05-101F | Blue | 472 | 6 | 16 | 165 | ✓ |
| 586-1A06-101F | White | * | 6 | 16 | 460 | ✓ |
| 586-1A01-103F | Red | 630 | 14 | 16 | 775 | ✓ |
| 586-1A02-103F | Green | 526 | 14 | 16 | 600 | ✓ |
| 586-1A03-103F | Yellow | 592 | 14 | 16 | 775 | ✓ |
| 586-1A04-103F | Orange | 615 | 14 | 16 | 775 | ✓ |
| 586-1A05-103F | Blue | 472 | 14 | 16 | 165 | ✓ |
| 586-1A06-103F | White | * | 14 | 16 | 460 | ✓ |
| 586-1A01-105F | Red | 630 | 28 | 16 | 775 | ✓ |
| 586-1A02-105F | Green | 526 | 28 | 16 | 600 | ✓ |
| 586-1A03-105F | Yellow | 592 | 28 | 16 | 775 | ✓ |
| 586-1A04-105F | Orange | 615 | 28 | 16 | 775 | ✓ |
| 586-1A05-105F | Blue | 472 | 28 | 16 | 165 | ✓ |
| 586-1A06-105F | White | * | 28 | 16 | 460 | ✓ |

Dialight

586 Series BASED LED

T1 3/4 WEDGE (T5)

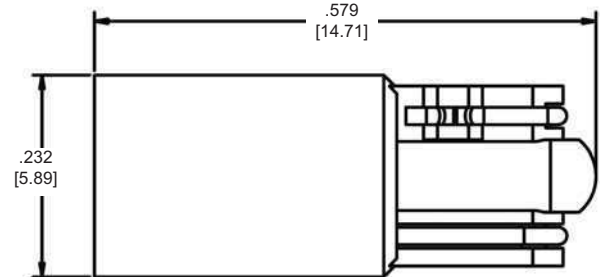

Measurements are typical
Dimensions are inches [mm]

T1 3/4 WEDGE (T5) NON-POLARIZED

| PART NUMBER | COLOR | PEAK WAVELENGTH (nm) | VOLTAGE (VDC) | CURRENT TYP.-(mA) | INTENSITY TYP.-(mcd) | RoHS COMPLIANT |
|---------------|--------|----------------------|---------------|-------------------|----------------------|----------------|
| 586-1201-201F | Red | 615 | 6 | 35 | 450 | ✓ |
| 586-1202-201F | Green | 528 | 6 | 12 | 120 | ✓ |
| 586-1203-201F | Yellow | 587 | 6 | 35 | 450 | ✓ |
| 586-1205-201F | Blue | 470 | 6 | 12 | 50 | ✓ |
| 586-1206-201F | White | * | 6 | 15 | 320 | ✓ |
| 586-1201-202F | Red | 615 | 12 | 18 | 450 | ✓ |
| 586-1202-202F | Green | 528 | 12 | 8 | 170 | ✓ |
| 586-1203-202F | Yellow | 587 | 12 | 18 | 450 | ✓ |
| 586-1205-202F | Blue | 470 | 12 | 8 | 70 | ✓ |
| 586-1206-202F | White | * | 12 | 11 | 450 | ✓ |
| 586-1201-203F | Red | 615 | 14 | 20 | 500 | ✓ |
| 586-1202-203F | Green | 528 | 14 | 8.5 | 185 | ✓ |
| 586-1203-203F | Yellow | 587 | 14 | 20 | 500 | ✓ |
| 586-1205-203F | Blue | 470 | 14 | 8.5 | 75 | ✓ |
| 586-1206-203F | White | * | 14 | 12 | 500 | ✓ |
| 586-1201-204F | Red | 615 | 24 | 14 | 350 | ✓ |
| 586-1202-204F | Green | 528 | 24 | 10 | 215 | ✓ |
| 586-1203-204F | Yellow | 587 | 24 | 14 | 350 | ✓ |
| 586-1205-204F | Blue | 470 | 24 | 10 | 85 | ✓ |
| 586-1206-204F | White | * | 24 | 14 | 580 | ✓ |
| 586-1201-205F | Red | 615 | 28 | 14 | 350 | ✓ |
| 586-1202-205F | Green | 528 | 28 | 10 | 210 | ✓ |
| 586-1203-205F | Yellow | 587 | 28 | 14 | 350 | ✓ |
| 586-1205-205F | Blue | 470 | 28 | 10 | 80 | ✓ |
| 586-1206-205F | White | * | 28 | 14 | 540 | ✓ |

Dialight

585 Series Multi-Chip BASED LED T 1 3/4 Wedge

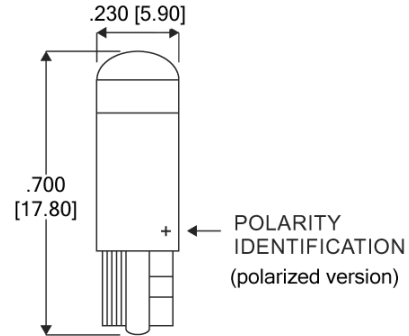

Measurements are typical

Dimensions are inches [mm]

POLARIZED

| Part Number | Color | Peak Wavelength (nm) | Nominal Voltage (VDC) | Forward Current TYP. (mA) | Intensity TYP. (mcd) |
|-------------|--------|----------------------|-----------------------|---------------------------|----------------------|
| 585-2211 | Red | 660 | 6 | 50 | 67 |
| 585-2311 | Green | 565 | 6 | 46 | 77 |
| 585-2411 | Yellow | 585 | 6 | 44 | 22 |
| 585-2213 | Red | 660 | 14 | 30 | 60 |
| 585-2313 | Green | 565 | 14 | 28 | 70 |
| 585-2413 | Yellow | 585 | 14 | 30 | 23 |
| 585-2215 | Red | 660 | 28 | 16 | 64 |
| 585-2315 | Green | 565 | 28 | 15 | 75 |
| 585-2415 | Yellow | 585 | 28 | 15 | 23 |

NON-POLARIZED

| Part Number | Color | Peak Wavelength (nm) | Nominal Voltage (VDC) | Forward Current TYP. (mA) | Intensity TYP. (mcd) |
|-------------|--------|----------------------|-----------------------|---------------------------|----------------------|
| 585-2221 | Red | 660 | 6 | 75 | 50 |
| 585-2321 | Green | 565 | 6 | 67 | 56 |
| 585-2421 | Yellow | 585 | 6 | 73 | 18 |
| 585-2223 | Red | 660 | 14 | 26 | 50 |
| 585-2323 | Green | 565 | 14 | 23 | 56 |
| 585-2423 | Yellow | 585 | 14 | 24 | 18 |
| 585-2225 | Red | 660 | 28 | 14 | 56 |
| 585-2325 | Green | 565 | 28 | 13 | 65 |
| 585-2425 | Yellow | 585 | 28 | 13 | 20 |



586 Series Single Chip BASED LED

T1 3/4 BI-PIN

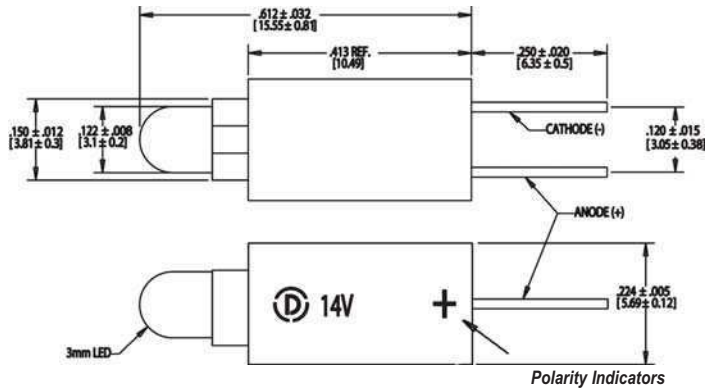
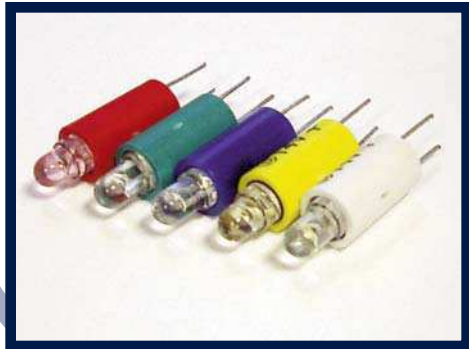

Measurements are typical
Dimensions are inches [mm]

T1 3/4 BI-PIN POLARIZED

| PART NUMBER | COLOR | PEAK WAVELENGTH (nm) | VOLTAGE (VDC) | CURRENT TYP.-(mA) | INTENSITY TYP.-(mcd) | RoHS COMPLIANT |
|---------------|--------|----------------------|---------------|-------------------|----------------------|----------------|
| 586-1301-101F | Red | 626 | 6 | 10 | 90 | ✓ |
| 586-1302-101F | Green | 525 | 6 | 10 | 1700 | ✓ |
| 586-1303-101F | Yellow | 590 | 6 | 10 | 110 | ✓ |
| 586-1305-101F | Blue | 470 | 6 | 10 | 500 | ✓ |
| 586-1306-101F | White | * | 6 | 10 | 635 | ✓ |
| 586-1301-103F | Red | 626 | 14 | 10 | 90 | ✓ |
| 586-1302-103F | Green | 525 | 14 | 10 | 1700 | ✓ |
| 586-1303-103F | Yellow | 590 | 14 | 10 | 110 | ✓ |
| 586-1305-103F | Blue | 470 | 14 | 10 | 500 | ✓ |
| 586-1306-103F | White | * | 14 | 10 | 635 | ✓ |
| 586-1301-105F | Red | 626 | 28 | 10 | 90 | ✓ |
| 586-1302-105F | Green | 525 | 28 | 10 | 1700 | ✓ |
| 586-1303-105F | Yellow | 590 | 28 | 10 | 110 | ✓ |
| 586-1305-105F | Blue | 470 | 28 | 10 | 500 | ✓ |
| 586-1306-105F | White | * | 28 | 10 | 635 | ✓ |

Dialight

585 Series Multi-Chip BASED LED T1 3/4 Bi-Pin

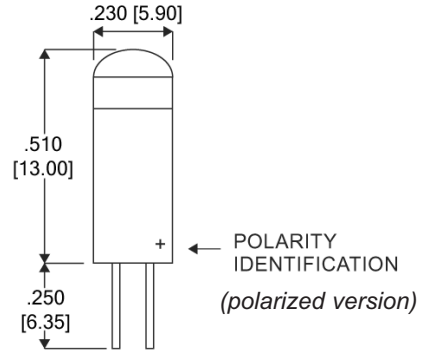

Measurements are typical
Dimensions are inches [mm]

POLARIZED

| Part Number | Color | Peak Wavelength (nm) | Voltage (VDC) | Current TYP.-(mA) | Intensity TYP.-(mcd) |
|-------------|--------|----------------------|---------------|-------------------|----------------------|
| 585-3211 | Red | 660 | 6 | 50 | 67 |
| 585-3311 | Green | 565 | 6 | 46 | 77 |
| 585-3411 | Yellow | 585 | 6 | 44 | 22 |
| 585-3213 | Red | 660 | 14 | 30 | 60 |
| 585-3313 | Green | 565 | 14 | 28 | 70 |
| 585-3413 | Yellow | 585 | 14 | 30 | 23 |
| 585-3215 | Red | 660 | 28 | 16 | 64 |
| 585-3315 | Green | 565 | 28 | 15 | 75 |
| 585-3415 | Yellow | 585 | 28 | 15 | 23 |

NON-POLARIZED

| Part Number | Color | Peak Wavelength (nm) | Voltage (VDC) | Current TYP.-(mA) | Intensity TYP.-(mcd) |
|-------------|--------|----------------------|---------------|-------------------|----------------------|
| 585-3221 | Red | 660 | 6 | 75 | 50 |
| 585-3321 | Green | 565 | 6 | 67 | 56 |
| 585-3421 | Yellow | 585 | 6 | 73 | 18 |
| 585-3223 | Red | 660 | 14 | 26 | 50 |
| 585-3323 | Green | 565 | 14 | 23 | 56 |
| 585-3423 | Yellow | 585 | 14 | 24 | 18 |
| 585-3225 | Red | 660 | 28 | 14 | 56 |
| 585-3325 | Green | 565 | 28 | 13 | 65 |
| 585-3425 | Yellow | 585 | 28 | 13 | 20 |

Dialight

586 Series Single Chip BASED LED T2 Telephone Slide (TYPE 3)

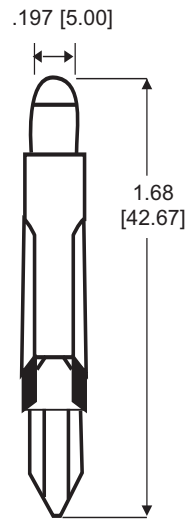

*Measurements are typical
Dimensions are inches [mm]*

T2 TELEPHONE SLIDE (ANSI #1) NON-POLARIZED

| PART NUMBER | COLOR | PEAK WAVELENGTH (nm) | VOLTAGE (VDC) | CURRENT TYP.-(mA) | INTENSITY TYP.-(mcd) | RoHS COMPLIANT |
|---------------|--------|----------------------|---------------|-------------------|----------------------|----------------|
| 586-3501-204F | Red | 622 | 24 | 25 | 600 | ✓ |
| 586-3502-204F | Green | 525 | 24 | 25 | 5000 | ✓ |
| 586-3503-204F | Yellow | 592 | 24 | 25 | 1700 | ✓ |
| 586-3505-204F | Blue | 470 | 24 | 25 | 1500 | ✓ |
| 586-3506-204F | White | * | 24 | 25 | 5600 | ✓ |

586 Series Single Chip BASED LED

T 3 1/4 MINIATURE BAYONET (BA9s)

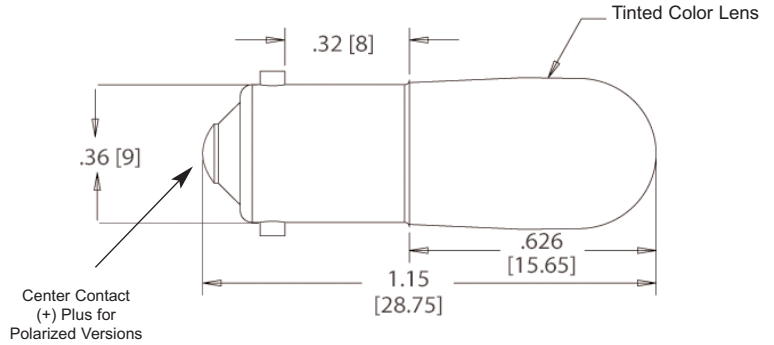

Measurements are typical
Dimensions are inches [mm]

T 3 1/4 MINIATURE BAYONET (BA9s) POLARIZED

| PART NUMBER | COLOR | PEAK WAVELENGTH (nm) | VOLTAGE (VDC) | CURRENT TYP.-(mA) | INTENSITY TYP.-(mcd) | RoHS COMPLIANT |
|---------------|--------|----------------------|---------------|-------------------|----------------------|----------------|
| 586-2401-101F | Red | 630 | 6 | 15 | 1050 | ✓ |
| 586-2402-101F | Green | 525 | 6 | 15 | 1650 | ✓ |
| 586-2403-101F | Yellow | 592 | 6 | 15 | 1275 | ✓ |
| 586-2405-101F | Blue | 470 | 6 | 15 | 487 | ✓ |
| 586-2406-101F | White | * | 6 | 15 | 825 | ✓ |
| 586-2401-103F | Red | 630 | 14 | 15 | 1050 | ✓ |
| 586-2402-103F | Green | 525 | 14 | 15 | 1650 | ✓ |
| 586-2403-103F | Yellow | 592 | 14 | 15 | 1275 | ✓ |
| 586-2405-103F | Blue | 470 | 14 | 15 | 487 | ✓ |
| 586-2406-103F | White | * | 14 | 15 | 825 | ✓ |
| 586-2401-105F | Red | 630 | 28 | 15 | 1050 | ✓ |
| 586-2402-105F | Green | 525 | 28 | 15 | 1650 | ✓ |
| 586-2403-105F | Yellow | 592 | 28 | 15 | 1275 | ✓ |
| 586-2405-105F | Blue | 470 | 28 | 15 | 487 | ✓ |
| 586-2406-105F | White | * | 28 | 15 | 825 | ✓ |

T 3 1/4 MINIATURE BAYONET (BA9s) NON-POLARIZED

| PART NUMBER | COLOR | PEAK WAVELENGTH (nm) | VOLTAGE (VDC) | CURRENT TYP.-(mA) | INTENSITY TYP.-(mcd) | RoHS COMPLIANT |
|---------------|--------|----------------------|---------------|-------------------|----------------------|----------------|
| 586-2401-201F | Red | 630 | 6 | 15 | 1050 | ✓ |
| 586-2402-201F | Green | 525 | 6 | 15 | 1650 | ✓ |
| 586-2403-201F | Yellow | 592 | 6 | 15 | 1275 | ✓ |
| 586-2405-201F | Blue | 470 | 6 | 15 | 487 | ✓ |
| 586-2406-201F | White | * | 6 | 15 | 825 | ✓ |
| 586-2401-203F | Red | 630 | 14 | 15 | 1050 | ✓ |
| 586-2402-203F | Green | 525 | 14 | 15 | 1650 | ✓ |
| 586-2403-203F | Yellow | 592 | 14 | 15 | 1275 | ✓ |
| 586-2405-203F | Blue | 470 | 14 | 15 | 487 | ✓ |
| 586-2406-203F | White | * | 14 | 15 | 825 | ✓ |
| 586-2401-205F | Red | 630 | 28 | 7.5 | 525 | ✓ |
| 586-2402-205F | Green | 525 | 28 | 7.5 | 825 | ✓ |
| 586-2403-205F | Yellow | 592 | 28 | 7.5 | 637 | ✓ |
| 586-2405-205F | Blue | 470 | 28 | 7.5 | 243 | ✓ |
| 586-2406-205F | White | * | 28 | 7.5 | 412 | ✓ |

Dialight

586 VIP Series

Variable Input 6-36 Volts DC

Single Chip BASED LED

T 3 1/4 MINIATURE BAYONET BASE (BA9S)

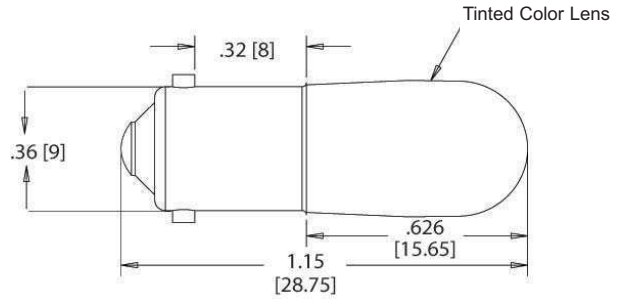

Measurements are typical
Dimensions are inches [mm]

T 3 1/4 MINIATURE BAYONET (BA9S) NON-POLARIZED MULTI-VOLTAGE INPUT

| Part Number | Color | Dominant Wavelength (nm) | Nominal Voltage (VDC) | Forward Current TYP. (mA) | Intensity TYP. (mcd) | RoHS Compliant |
|---------------|--------|--------------------------|-----------------------|---------------------------|----------------------|----------------|
| 586-2401-220F | Red | 630 | 6-36 | 10 | 1000 | ✓ |
| 586-2402-220F | Green | 525 | 6-36 | 10 | 1500 | ✓ |
| 586-2403-220F | Yellow | 592 | 6-36 | 10 | 550 | ✓ |
| 586-2405-220F | Blue | 470 | 6-36 | 10 | 200 | ✓ |
| 586-2406-220F | White | * | 6-36 | 10 | 650 | ✓ |

* Color Coordinates: x = 0.330, y = 0.365

586 Series - Sunlight Readable CLUSTER BASED LED T3 1/4 Miniature Bayonet (BA9s)

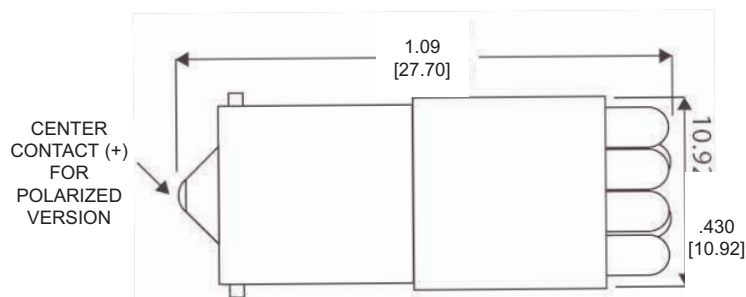

*Measurements are typical
Dimensions are inches [mm]*

POLARIZED

| Part Number | Color | Peak Wavelength (nm) | Nominal Voltage (VDC) | Forward Current TYP.-(mA) | Intensity TYP.-(mcd) | RoHS Compliant |
|---------------|--------|----------------------|-----------------------|---------------------------|----------------------|----------------|
| 586-6401-101F | Red | 630 | 6 | 100 | 1000 | ✓ |
| 586-6402-101F | Green | 526 | 6 | 90 | 3800 | ✓ |
| 586-6403-101F | Yellow | 592 | 6 | 100 | 2000 | ✓ |
| 586-6405-101F | Blue | 472 | 6 | 90 | 850 | ✓ |
| 586-6406-101F | White | * | 6 | 90 | 4800 | ✓ |
| 586-6401-103F | Red | 630 | 14 | 50 | 1000 | ✓ |
| 586-6402-103F | Green | 526 | 14 | 40 | 3100 | ✓ |
| 586-6403-103F | Yellow | 592 | 14 | 50 | 2000 | ✓ |
| 586-6405-103F | Blue | 472 | 14 | 40 | 685 | ✓ |
| 586-6406-103F | White | * | 14 | 40 | 4800 | ✓ |
| 586-6401-105F | Red | 630 | 28 | 17 | 1000 | ✓ |
| 586-6402-105F | Green | 526 | 28 | 13 | 3600 | ✓ |
| 586-6403-105F | Yellow | 592 | 28 | 17 | 2000 | ✓ |
| 586-6405-105F | Blue | 472 | 28 | 13 | 780 | ✓ |
| 586-6406-105F | White | * | 28 | 13 | 4200 | ✓ |

NON-POLARIZED

| Part Number | Color | Peak Wavelength (nm) | Nominal Voltage | Forward Current TYP.-(mA) | Intensity TYP.-(mcd) | RoHS Compliant |
|---------------|--------|----------------------|-----------------|---------------------------|----------------------|----------------|
| 586-6401-201F | Red | 630 | 6 VDC | 100 | 1000 | ✓ |
| 586-6402-201F | Green | 526 | 6 VDC | 70 | 3400 | ✓ |
| 586-6403-201F | Yellow | 592 | 6 VDC | 100 | 2000 | ✓ |
| 586-6405-201F | Blue | 472 | 6 VDC | 70 | 685 | ✓ |
| 586-6406-201F | White | * | 6 VDC | 70 | 4000 | ✓ |
| 586-6401-203F | Red | 630 | 14 VDC | 50 | 1000 | ✓ |
| 586-6402-203F | Green | 526 | 14 VDC | 40 | 3400 | ✓ |
| 586-6403-203F | Yellow | 592 | 14 VDC | 50 | 2000 | ✓ |
| 586-6405-203F | Blue | 472 | 14 VDC | 40 | 685 | ✓ |
| 586-6406-203F | White | * | 14 VDC | 40 | 4000 | ✓ |
| 586-6401-205F | Red | 630 | 28 VDC | 18 | 1000 | ✓ |
| 586-6402-205F | Green | 526 | 28 VDC | 11 | 3400 | ✓ |
| 586-6403-205F | Yellow | 592 | 28 VDC | 18 | 2000 | ✓ |
| 586-6405-205F | Blue | 472 | 28 VDC | 11 | 685 | ✓ |
| 586-6406-205F | White | * | 28 VDC | 11 | 4000 | ✓ |
| 586-6401-206F | Red | 630 | 120 VAC | 9 | 500 | ✓ |
| 586-6402-206F | Green | 526 | 120 VAC | 9 | 2400 | ✓ |
| 586-6403-206F | Yellow | 592 | 120 VAC | 9 | 1000 | ✓ |
| 586-6405-206F | Blue | 472 | 120 VAC | 9 | 565 | ✓ |
| 586-6406-206F | White | * | 120 VAC | 9 | 3000 | ✓ |

Dialight

585 Series

CLUSTER BASED LED

T3 1/4 Miniature Bayonet (BA9s)

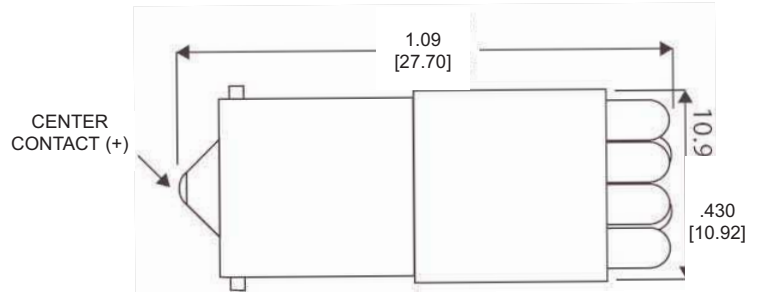

Measurements are typical
Dimensions are inches [mm]

POLARIZED

| Part Number | Color | Peak Wavelength (nm) | Nominal Voltage (VDC) | Forward Current TYP.-(mA) | Intensity TYP.-(mcd) |
|-------------|--------|----------------------|-----------------------|---------------------------|----------------------|
| 585-5211 | Red | 660 | 6 | 60 | 480 |
| 585-5311 | Green | 565 | 6 | 60 | 420 |
| 585-5511 | Yellow | 592 | 6 | 90 | 1800 |
| 585-5213 | Red | 660 | 14 | 40 | 480 |
| 585-5313 | Green | 565 | 14 | 40 | 420 |
| 585-5513 | Yellow | 592 | 14 | 60 | 1800 |
| 585-5215 | Red | 660 | 28 | 20 | 560 |
| 585-5315 | Green | 565 | 28 | 20 | 490 |
| 585-5515 | Yellow | 592 | 28 | 30 | 2100 |

NON-POLARIZED

| Part Number | Color | Peak Wavelength (nm) | Nominal Voltage (VDC) | Forward Current TYP.-(mA) | Intensity TYP.-(mcd) |
|-------------|--------|----------------------|-----------------------|---------------------------|----------------------|
| 585-5223 | Red | 660 | 14 | 40 | 480 |
| 585-5323 | Green | 565 | 14 | 40 | 420 |
| 585-5523 | Yellow | 592 | 14 | 60 | 1800 |
| 585-5225 | Red | 660 | 28 | 20 | 560 |
| 585-5325 | Green | 565 | 28 | 20 | 490 |
| 585-5525 | Yellow | 592 | 28 | 30 | 2100 |
| 585-5256 | Red | 660 | 120 VAC | 9 | 252 |
| 585-5356 | Green | 565 | 120 VAC | 9 | 220 |
| 585-5556 | Yellow | 592 | 120 VAC | 9 | 945 |

Dialight

586 Series Single Chip BASED LED T3 1/4 MINIATURE SCREW (E10)

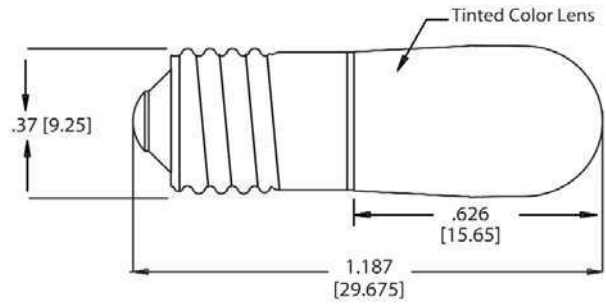

Measurements are typical
Dimensions are inches [mm]

T3 1/4 MINIATURE SCREW (E10) NON-POLARIZED

| PART NUMBER | COLOR | PEAK WAVELENGTH (nm) | VOLTAGE (VDC) | CURRENT TYP.-(mA) | INTENSITY TYP.-(mcd) | RoHS COMPLIANT |
|---------------|--------|----------------------|---------------|-------------------|----------------------|----------------|
| 586-2701-201F | Red | 630 | 6 | 15 | 1050 | ✓ |
| 586-2702-201F | Green | 525 | 6 | 15 | 1650 | ✓ |
| 586-2703-201F | Yellow | 592 | 6 | 15 | 1275 | ✓ |
| 586-2705-201F | Blue | 470 | 6 | 15 | 487 | ✓ |
| 586-2706-201F | White | * | 6 | 15 | 825 | ✓ |
| 586-2701-203F | Red | 630 | 14 | 15 | 1050 | ✓ |
| 586-2702-203F | Green | 525 | 14 | 15 | 1650 | ✓ |
| 586-2703-203F | Yellow | 592 | 14 | 15 | 1275 | ✓ |
| 586-2705-203F | Blue | 470 | 14 | 15 | 487 | ✓ |
| 586-2706-203F | White | * | 14 | 15 | 825 | ✓ |
| 586-2701-205F | Red | 630 | 28 | 7.5 | 525 | ✓ |
| 586-2702-205F | Green | 525 | 28 | 7.5 | 825 | ✓ |
| 586-2703-205F | Yellow | 592 | 28 | 7.5 | 637 | ✓ |
| 586-2705-205F | Blue | 470 | 28 | 7.5 | 243 | ✓ |
| 586-2706-205F | White | * | 28 | 7.5 | 412 | ✓ |

Dialight

586 VIP Series

Variable Input 6-36 Volts DC

Single Chip BASED LED

T 3 1/4 MINIATURE SCREW BASE (E10)

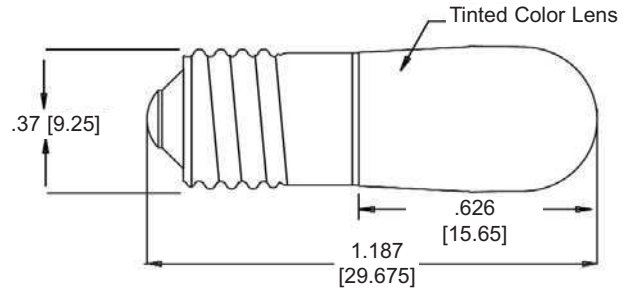

Measurements are typical
Dimensions are inches [mm]

T3 1/4 MINIATURE SCREW (E10) NON-POLARIZED MULTI-VOLTAGE INPUT

| Part Number | Color | Dominant Wavelength (nm) | Nominal Voltage (VDC) | Forward Current TYP. (mA) | Intensity TYP. (mcd) | RoHS Compliant |
|---------------|--------|--------------------------|-----------------------|---------------------------|----------------------|----------------|
| 586-2701-220F | Red | 630 | 6-36 | 10 | 1000 | ✓ |
| 586-2702-220F | Green | 525 | 6-36 | 10 | 1500 | ✓ |
| 586-2703-220F | Yellow | 592 | 6-36 | 10 | 550 | ✓ |
| 586-2705-220F | Blue | 470 | 6-36 | 10 | 200 | ✓ |
| 586-2706-220F | White | * | 6-36 | 10 | 650 | ✓ |

* Color Coordinates: x = 0.330, y = 0.365

Dialight

586 Series BASED LED T3 1/4 WEDGE (T10)

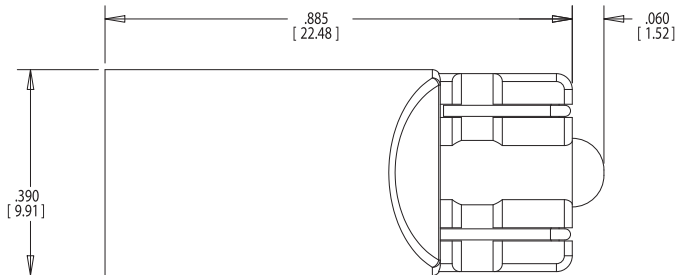

Measurements are typical
Dimensions are inches [mm]

T3 1/4 WEDGE NON-POLARIZED

| PART NUMBER | COLOR | PEAK WAVELENGTH (nm) | VOLTAGE (VDC) | CURRENT TYP.-(mA) | INTENSITY TYP.-(mcd) | RoHS COMPLIANT |
|---------------|--------------|----------------------|---------------|-------------------|----------------------|----------------|
| 586-2201-201F | Red | 615 | 6 | 69 | 770 | ✓ |
| 586-2202-201F | Green | 528 | 6 | 30 | 300 | ✓ |
| 586-2203-201F | Yellow | 591 | 6 | 69 | 550 | ✓ |
| 586-2205-201F | Blue | 470 | 6 | 30 | 90 | ✓ |
| 586-2206-201F | White | * | 6 | 30 | 630 | ✓ |
| 586-2201-202F | Red | 615 | 12 | 37 | 820 | ✓ |
| 586-2202-202F | Green | 528 | 12 | 19 | 380 | ✓ |
| 586-2203-202F | Yellow | 591 | 12 | 37 | 590 | ✓ |
| 586-2205-202F | Blue | 470 | 12 | 19 | 115 | ✓ |
| 586-2206-202F | White | * | 12 | 19 | 800 | ✓ |
| 586-220A-202F | White/Yellow | * / 591 | 12 | 25 | 725 | ✓ |
| 586-220B-202F | White/Orange | * / 610 | 12 | 25 | 775 | ✓ |
| 586-2201-203F | Red | 615 | 14 | 41 | 910 | ✓ |
| 586-2202-203F | Green | 528 | 14 | 24 | 480 | ✓ |
| 586-2203-203F | Yellow | 591 | 14 | 41 | 650 | ✓ |
| 586-2205-203F | Blue | 470 | 14 | 24 | 145 | ✓ |
| 586-2206-203F | White | * | 14 | 24 | 1000 | ✓ |
| 586-220A-203F | White/Yellow | * / 591 | 14 | 25 | 725 | ✓ |
| 586-220B-203F | White/Orange | * / 610 | 14 | 25 | 775 | ✓ |
| 586-2201-204F | Red | 615 | 24 | 19 | 850 | ✓ |
| 586-2202-204F | Green | 528 | 24 | 12 | 480 | ✓ |
| 586-2203-204F | Yellow | 591 | 24 | 19 | 610 | ✓ |
| 586-2205-204F | Blue | 470 | 24 | 12 | 145 | ✓ |
| 586-2206-204F | White | * | 24 | 12 | 1000 | ✓ |
| 586-220A-204F | White/Yellow | * / 591 | 24 | 14 | 810 | ✓ |
| 586-220B-204F | White/Orange | * / 610 | 24 | 14 | 870 | ✓ |

* White Color Coordinates: x = .320, y = .310

Dialight

586 Series CLUSTER BASED LED 15mm BAYONET (BA15s)

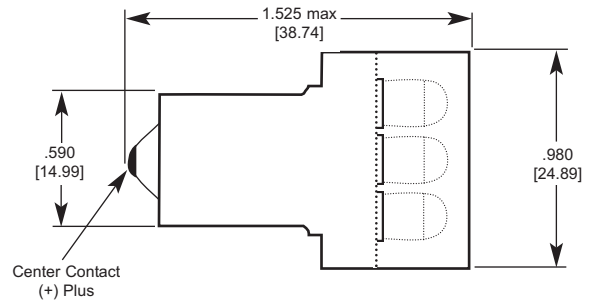

Measurements are typical

Dimensions are inches [mm]

15mm BAYONET (BA15s) - POLARIZED

| PART NUMBER | COLOR | PEAK WAVELENGTH (nm) | VOLTAGE (VDC) | CURRENT TYP.-(mA) | INTENSITY TYP.-(mcd) | RoHS COMPLIANT |
|---------------|--------|----------------------|---------------|-------------------|----------------------|----------------|
| 586-4601-103F | Red | 639 | 14 | 30 | 17325 | ✓ |
| 586-4602-103F | Green | 525 | 14 | 20 | 21000 | ✓ |
| 586-4603-103F | Yellow | 594 | 14 | 30 | 17325 | ✓ |
| 586-4605-103F | Blue | 470 | 14 | 20 | 6300 | ✓ |
| 586-4606-103F | White | * | 14 | 20 | 23800 | ✓ |
| 586-4601-105F | Red | 639 | 28 | 30 | 17325 | ✓ |
| 586-4602-105F | Green | 525 | 28 | 20 | 21000 | ✓ |
| 586-4603-105F | Yellow | 594 | 28 | 30 | 17325 | ✓ |
| 586-4605-105F | Blue | 470 | 28 | 20 | 6300 | ✓ |
| 586-4606-105F | White | * | 28 | 20 | 23800 | ✓ |

| Incandescent Lamp # | Size | Base Style | Operating Voltage (VDC) | Configuration | Dialight Based LED Part Number | | | | |
|---------------------|---------|--------------------------------|-------------------------|-------------------------------|--------------------------------|--------------|--------------|--------------|--------------|
| | | | | | Red | Green | Yellow | Blue | White |
| 16 | T1 3/4 | Wedge Base | 6 | Polarized | 586-1A01-101 | 586-1A02-101 | 586-1A03-101 | 586-1A05-101 | 586-1A06-101 |
| | | | | Non-Polarized | 586-1201-201 | 586-1202-201 | 586-1203-201 | 586-1205-201 | 586-1206-201 |
| 17 | T1 3/4 | Wedge Base | 28 | Polarized | 586-1A01-105 | 586-1A02-105 | 586-1A03-105 | 586-1A05-105 | 586-1A06-105 |
| | | | | Non-Polarized | 586-1201-205 | 586-1202-205 | 586-1203-205 | 586-1205-205 | 586-1206-205 |
| 18 | T1 3/4 | Wedge Base | 14 | Polarized | 586-1A01-103 | 586-1A02-103 | 586-1A03-103 | 586-1A05-103 | 586-1A06-103 |
| | | | | Non-Polarized | 586-1201-203 | 586-1202-203 | 586-1203-203 | 586-1205-203 | 586-1206-203 |
| 24 | T2 | Telephone Slide (Type 3) | 24 | Non-Polarized | 586-3501-204 | 586-3502-204 | 586-3503-204 | 586-3505-204 | 586-3506-204 |
| 37 | T1 3/4 | Wedge Base | 14 | Polarized | 586-1A01-103 | 586-1A02-103 | 586-1A03-103 | 586-1A05-103 | 586-1A06-103 |
| | | | | Non-Polarized | 586-1201-203 | 586-1202-203 | 586-1203-203 | 586-1205-203 | 586-1206-203 |
| 40, 46 | T3 1/4 | Miniature Screw | 6 | Non-Polarized | 586-2701-201 | 586-2702-201 | 586-2703-201 | 586-2705-201 | 586-2706-201 |
| 44, 47 | T3 1/4 | Miniature Bayonet (BA9s) | 6 | Non-Polarized High Brightness | 586-6401-201 | 586-6402-201 | 586-6403-201 | 586-6405-201 | 586-6406-201 |
| | | | | Non-Polarized | 586-2401-201 | 586-2402-201 | 586-2403-201 | 586-2405-201 | 586-2406-201 |
| 52 | T3 1/4 | Miniature Screw | 14 | Non-Polarized | 586-2701-203 | 586-2702-203 | 586-2703-203 | 586-2705-203 | 586-2706-203 |
| 56 | T1 3/4 | Wedge Base | 6 | Polarized | 586-1A01-101 | 586-1A02-101 | 586-1A03-101 | 586-1A05-101 | 586-1A06-101 |
| | | | | Non-Polarized | 586-1201-201 | 586-1202-201 | 586-1203-201 | 586-1205-201 | 586-1206-201 |
| 67 | G-6 | Single Contact Bayonet (BA15s) | 14 | Polarized | 586-4601-103 | 586-4602-103 | 586-4603-103 | 586-4605-103 | 586-4606-103 |
| 70, 73, 74 | T1 3/4 | Wedge Base | 14 | Polarized | 586-1A01-103 | 586-1A02-103 | 586-1A03-103 | 586-1A05-103 | 586-1A06-103 |
| | | | | Non-Polarized | 586-1201-203 | 586-1202-203 | 586-1203-203 | 586-1205-203 | 586-1206-203 |
| 79, 84 | T1 3/4 | Wedge Base | 6 | Polarized | 586-1A01-101 | 586-1A02-101 | 586-1A03-101 | 586-1A05-101 | 586-1A06-101 |
| | | | | Non-Polarized | 586-1201-201 | 586-1202-201 | 586-1203-201 | 586-1205-201 | 586-1206-201 |
| 85 | T1 3/4 | Wedge Base | 28 | Polarized | 586-1A01-105 | 586-1A02-105 | 586-1A03-105 | 586-1A05-105 | 586-1A06-105 |
| | | | | Non-Polarized | 586-1201-205 | 586-1202-205 | 586-1203-205 | 586-1205-205 | 586-1206-205 |
| 86 | T1 3/4 | Wedge Base | 6 | Polarized | 586-1A01-101 | 586-1A02-101 | 586-1A03-101 | 586-1A05-101 | 586-1A06-101 |
| | | | | Non-Polarized | 586-1201-201 | 586-1202-201 | 586-1203-201 | 586-1205-201 | 586-1206-201 |
| 93, 97, 98, 105 | G-6/S-8 | Single Contact Bayonet (BA15s) | 14 | Polarized | 586-4601-103 | 586-4602-103 | 586-4603-103 | 586-4605-103 | 586-4606-103 |
| 124 | T3 1/4 | Wedge Base | 14 | Non-Polarized | 586-2201-203 | 586-2202-203 | 586-2203-203 | 586-2205-203 | 586-2206-203 |
| 152 | T3 1/4 | Wedge Base | 28 | Non-Polarized | 586-2201-205 | 586-2202-205 | 586-2203-205 | 586-2205-205 | 586-2206-205 |
| 158, 161, 168 | T3 1/4 | Wedge Base | 14 | Non-Polarized | 586-2201-203 | 586-2202-203 | 586-2203-203 | 586-2205-203 | 586-2206-203 |
| 159 | T3 1/4 | Wedge Base | 6 | Non-Polarized | 586-2201-201 | 586-2202-201 | 586-2203-201 | 586-2205-201 | 586-2206-201 |
| 181 | T3 1/4 | Miniature Bayonet (BA9s) | 14 | Non-Polarized High Brightness | 586-6401-203 | 586-6402-203 | 586-6403-203 | 586-6405-203 | 586-6406-203 |
| | | | | Non-Polarized | 586-2401-203 | 586-2402-203 | 586-2403-203 | 586-2405-203 | 586-2406-203 |
| 184, 193, 194 | T3 1/4 | Wedge Base | 14 | Non-Polarized | 586-2201-203 | 586-2202-203 | 586-2203-203 | 586-2205-203 | 586-2206-203 |
| 199 | S-8 | Single Contact Bayonet (BA15s) | 14 | Polarized | 586-4601-103 | 586-4602-103 | 586-4603-103 | 586-4605-103 | 586-4606-103 |

Dialight reserves the right to make changes at any time in order to supply the best product possible.

(see notes on page 21)



| Incandescent Lamp # | Size | Base Style | Operating Voltage (VDC) | Configuration | Dialight Based LED Part Number | | | | |
|------------------------------------------|---------|--------------------------------|-------------------------|-------------------------------|--------------------------------|--------------|--------------|--------------|--------------|
| | | | | | Red | Green | Yellow | Blue | White |
| 216 | T3 ¼ | Miniature Bayonet (BA9s) | 14 | Non-Polarized High Brightness | 586-6401-203 | 586-6402-203 | 586-6403-203 | 586-6405-203 | 586-6406-203 |
| | | | | Non-Polarized | 586-2401-203 | 586-2402-203 | 586-2403-203 | 586-2405-203 | 586-2406-203 |
| 259 | T3 ¼ | Wedge Base | 6 | Non-Polarized | 586-2201-201 | 586-2202-201 | 586-2203-201 | 586-2205-201 | 586-2206-201 |
| 303, 305, 307, 315 | S-8 | Single Contact Bayonet (BA15s) | 28 | Polarized | 586-4601-105 | 586-4602-105 | 586-4603-105 | 586-4605-105 | 586-4606-105 |
| 313 | T3 ¼ | Miniature Bayonet (BA9s) | 28 | Non-Polarized High Brightness | 586-6401-205 | 586-6402-205 | 586-6403-205 | 586-6405-205 | 586-6406-205 |
| | | | | Non-Polarized | 586-2401-205 | 586-2402-205 | 586-2403-205 | 586-2405-205 | 586-2406-205 |
| 327 | T1 ¾ | Midget Flange | 28 | Polarized | 586-1101-105 | 586-1102-105 | 586-1103-105 | 586-1105-105 | 586-1106-105 |
| 328 | T1 ¾ | Midget Flange | 6 | Polarized | 586-1101-101 | 586-1102-101 | 586-1103-101 | 586-1105-101 | 586-1106-101 |
| 330 | T1 ¾ | Midget Flange | 14 | Polarized | 586-1101-103 | 586-1102-103 | 586-1103-103 | 586-1105-103 | 586-1106-103 |
| 345, 349, 350 | T1 ¾ | Midget Flange | 6 | Polarized | 586-1101-101 | 586-1102-101 | 586-1103-101 | 586-1105-101 | 586-1106-101 |
| 376 | T1 ¾ | Midget Flange | 28 | Polarized | 586-1101-105 | 586-1102-105 | 586-1103-105 | 586-1105-105 | 586-1106-105 |
| 377, 380, 381 | T1 ¾ | Midget Flange | 6 | Polarized | 586-1101-101 | 586-1102-101 | 586-1103-101 | 586-1105-101 | 586-1106-101 |
| 382 | T1 ¾ | Midget Flange | 14 | Polarized | 586-1101-103 | 586-1102-103 | 586-1103-103 | 586-1105-103 | 586-1106-103 |
| 385, 387 | T1 ¾ | Midget Flange | 28 | Polarized | 586-1101-105 | 586-1102-105 | 586-1103-105 | 586-1105-105 | 586-1106-105 |
| 394 | T1 ¾ | Midget Flange | 14 | Polarized | 586-1101-103 | 586-1102-103 | 586-1103-103 | 586-1105-103 | 586-1106-103 |
| 400, 464, 585, 655, 656, 657 | T3 ¼ | Wedge Base | 28 | Non-Polarized | 586-2201-205 | 586-2202-205 | 586-2203-205 | 586-2205-205 | 586-2206-205 |
| 658 | T3 ¼ | Wedge Base | 14 | Non-Polarized | 586-2201-203 | 586-2202-203 | 586-2203-203 | 586-2205-203 | 586-2206-203 |
| 444, 447 | T3 ¼ | Wedge Base | 6 | Non-Polarized | 586-2201-201 | 586-2202-201 | 586-2203-201 | 586-2205-201 | 586-2206-201 |
| 502 | T3 ¼ | Miniature Screw | 6 | Non-Polarized | 586-2701-201 | 586-2702-201 | 586-2703-201 | 586-2705-201 | 586-2706-201 |
| 555 | T3 ¼ | Wedge Base | 6 | Non-Polarized | 586-2201-201 | 586-2202-201 | 586-2203-201 | 586-2205-201 | 586-2206-201 |
| 623 | G-6 | Single Contact Bayonet (BA15s) | 28 | Polarized | 586-4601-105 | 586-4602-105 | 586-4603-105 | 586-4605-105 | 586-4606-105 |
| 631 | G-6 | Single Contact Bayonet (BA15s) | 14 | Polarized | 586-4601-103 | 586-4602-103 | 586-4603-103 | 586-4605-103 | 586-4606-103 |
| 755 | T3 ¼ | Miniature Bayonet (BA9s) | 6 | Non-Polarized High Brightness | 586-6401-201 | 586-6402-201 | 586-6403-201 | 586-6405-201 | 586-6406-201 |
| | | | | Non-Polarized | 586-2401-201 | 586-2402-201 | 586-2403-201 | 586-2405-201 | 586-2406-201 |
| 756 | T3 ¼ | Miniature Bayonet (BA9s) | 14 | Non-Polarized High Brightness | 586-6401-203 | 586-6402-203 | 586-6403-203 | 586-6405-203 | 586-6406-203 |
| | | | | Non-Polarized | 586-2401-203 | 586-2402-203 | 586-2403-203 | 586-2405-203 | 586-2406-203 |
| 757 | T3 ¼ | Miniature Bayonet (BA9s) | 28 | Non-Polarized High Brightness | 586-6401-205 | 586-6402-205 | 586-6403-205 | 586-6405-205 | 586-6406-205 |
| | | | | Non-Polarized | 586-2401-205 | 586-2402-205 | 586-2403-205 | 586-2405-205 | 586-2406-205 |
| 1003, 1093, 1095, 1141, 1155, 1156, 1159 | B-6/S-8 | Single Contact Bayonet (BA15s) | 14 | Polarized | 586-4601-103 | 586-4602-103 | 586-4603-103 | 586-4605-103 | 586-4606-103 |

Dialight reserves the right to make changes at any time in order to supply the best product possible.

(see notes on page 21)

Incandescent Lamp/Based LED Cross Reference

| Incandescent Lamp # | Size | Base Style | Operating Voltage (VDC) | Configuration | Dialight Based LED Part Number | | | | |
|------------------------------------|------|--------------------------------|-------------------------|-------------------------------|--------------------------------|--------------|--------------|--------------|--------------|
| | | | | | Red | Green | Yellow | Blue | White |
| 1203, 1251 | S-8 | Single Contact Bayonet (BA15s) | 28 | Polarized | 586-4601-105 | 586-4602-105 | 586-4603-105 | 586-4605-105 | 586-4606-105 |
| 1295 | S-8 | Single Contact Bayonet (BA15s) | 14 | Polarized | 586-4601-103 | 586-4602-103 | 586-4603-103 | 586-4605-103 | 586-4606-103 |
| 1308 | B-6 | Single Contact Bayonet (BA15s) | 28 | Polarized | 586-4601-105 | 586-4602-105 | 586-4603-105 | 586-4605-105 | 586-4606-105 |
| 1446, 1481, 1487 | T3 ¼ | Miniature Screw | 14 | Non-Polarized | 586-2701-203 | 586-2702-203 | 586-2703-203 | 586-2705-203 | 586-2706-203 |
| 1488 | T3 ¼ | Miniature Bayonet (BA9s) | 14 | Non-Polarized High Brightness | 586-6401-203 | 586-6402-203 | 586-6403-203 | 586-6405-203 | 586-6406-203 |
| | | | | Non-Polarized | 586-2401-203 | 586-2402-203 | 586-2403-203 | 586-2405-203 | 586-2406-203 |
| 1591, 1665, 1683, 1691 | S-8 | Single Contact Bayonet (BA15s) | 28 | Polarized | 586-4601-105 | 586-4602-105 | 586-4603-105 | 586-4605-105 | 586-4606-105 |
| 1813, 1815 | T3 ¼ | Miniature Bayonet (BA9s) | 14 | Non-Polarized High Brightness | 586-6401-203 | 586-6402-203 | 586-6403-203 | 586-6405-203 | 586-6406-203 |
| | | | | Non-Polarized | 586-2401-203 | 586-2402-203 | 586-2403-203 | 586-2405-203 | 586-2406-203 |
| 1819, 1820 | T3 ¼ | Miniature Bayonet (BA9s) | 28 | Non-Polarized High Brightness | 586-6401-205 | 586-6402-205 | 586-6403-205 | 586-6405-205 | 586-6406-205 |
| | | | | Non-Polarized | 586-2401-205 | 586-2402-205 | 586-2403-205 | 586-2405-205 | 586-2406-205 |
| 1821 | T3 ¼ | Miniature Screw | 28 | Non-Polarized | 586-2701-205 | 586-2702-205 | 586-2703-205 | 586-2705-205 | 586-2706-205 |
| 1829, 1843 | T3 ¼ | Miniature Bayonet (BA9s) | 28 | Non-Polarized High Brightness | 586-6401-205 | 586-6402-205 | 586-6403-205 | 586-6405-205 | 586-6406-205 |
| | | | | Non-Polarized | 586-2401-205 | 586-2402-205 | 586-2403-205 | 586-2405-205 | 586-2406-205 |
| 1847, 1850, 1866 | T3 ¼ | Miniature Bayonet (BA9s) | 6 | Non-Polarized High Brightness | 586-6401-201 | 586-6402-201 | 586-6403-201 | 586-6405-201 | 586-6406-201 |
| | | | | Non-Polarized | 586-2401-201 | 586-2402-201 | 586-2403-201 | 586-2405-201 | 586-2406-201 |
| 1864, 1873 | T3 ¼ | Miniature Bayonet (BA9s) | 28 | Non-Polarized High Brightness | 586-6401-205 | 586-6402-205 | 586-6403-205 | 586-6405-205 | 586-6406-205 |
| | | | | Non-Polarized | 586-2401-205 | 586-2402-205 | 586-2403-205 | 586-2405-205 | 586-2406-205 |
| 1889, 1891, 1892, 1893, 1894, 1898 | T3 ¼ | Miniature Bayonet (BA9s) | 14 | Non-Polarized High Brightness | 586-6401-203 | 586-6402-203 | 586-6403-203 | 586-6405-203 | 586-6406-203 |
| | | | | Non-Polarized | 586-2401-203 | 586-2402-203 | 586-2403-203 | 586-2405-203 | 586-2406-203 |
| 2232, 2233 | S-8 | Single Contact Bayonet (BA15s) | 28 | Polarized | 586-4601-105 | 586-4602-105 | 586-4603-105 | 586-4605-105 | 586-4606-105 |
| 2306 | T1 ¾ | Bi-Pin | 6 | Polarized | 586-1301-101 | 586-1302-101 | 586-1303-101 | 586-1305-101 | 586-1306-101 |
| 2312, 2314 | T1 ¾ | Bi-Pin | 28 | Polarized | 586-1301-105 | 586-1302-105 | 586-1303-105 | 586-1305-105 | 586-1306-105 |
| 2323 | T1 ¾ | Bi-Pin | 6 | Polarized | 586-1301-101 | 586-1302-101 | 586-1303-101 | 586-1305-101 | 586-1306-101 |
| 2324, 2325 | T1 ¾ | Bi-Pin | 28 | Polarized | 586-1301-105 | 586-1302-105 | 586-1303-105 | 586-1305-105 | 586-1306-105 |

Dialight reserves the right to make changes at any time in order to supply the best product possible.

(see notes on page 21)



| Incandescent Lamp # | Size | Base Style | Operating Voltage (VDC) | Configuration | Dialight Based LED Part Number | | | | |
|------------------------|--------|-----------------|-------------------------|---------------|--------------------------------|--------------|--------------|--------------|--------------|
| | | | | | Red | Green | Yellow | Blue | White |
| 2329 | T1 3/4 | Bi-Pin | 28 | Polarized | 586-1301-105 | 586-1302-105 | 586-1303-105 | 586-1305-105 | 586-1306-105 |
| 2332, 2335 | T1 3/4 | Bi-Pin | 14 | Polarized | 586-1301-103 | 586-1302-103 | 586-1303-103 | 586-1305-103 | 586-1306-103 |
| 2337 | T1 3/4 | Bi-Pin | 6 | Polarized | 586-1301-101 | 586-1302-101 | 586-1303-101 | 586-1305-101 | 586-1306-101 |
| 2342 | T1 3/4 | Bi-Pin | 28 | Polarized | 586-1301-105 | 586-1302-105 | 586-1303-105 | 586-1305-105 | 586-1306-105 |
| 3149 | T1 3/4 | Bi-Pin | 6 | Polarized | 586-1301-101 | 586-1302-101 | 586-1303-101 | 586-1305-101 | 586-1306-101 |
| 3708 | T3 1/4 | Miniature Screw | 6 | Non-Polarized | 586-2701-201 | 586-2702-201 | 586-2703-201 | 586-2705-201 | 586-2706-201 |
| 6034 | T1 3/4 | Midget Flange | 28 | Polarized | 586-1101-105 | 586-1102-105 | 586-1103-105 | 586-1105-105 | 586-1106-105 |
| 7327 | T1 3/4 | Bi-Pin | 28 | Polarized | 586-1301-105 | 586-1302-105 | 586-1303-105 | 586-1305-105 | 586-1306-105 |
| 7328 | T1 3/4 | Bi-Pin | 6 | Polarized | 586-1301-101 | 586-1302-101 | 586-1303-101 | 586-1305-101 | 586-1306-101 |
| 7330 | T1 3/4 | Bi-Pin | 14 | Polarized | 586-1301-103 | 586-1302-103 | 586-1303-103 | 586-1305-103 | 586-1306-103 |
| 7332, 7333, 7335 | T1 3/4 | Midget Flange | 6 | Polarized | 586-1101-101 | 586-1102-101 | 586-1103-101 | 586-1105-101 | 586-1106-101 |
| 7341 | T1 3/4 | Midget Flange | 28 | Polarized | 586-1101-105 | 586-1102-105 | 586-1103-105 | 586-1105-105 | 586-1106-105 |
| 7349, 7361, 7364, 7368 | T1 3/4 | Bi-Pin | 6 | Polarized | 586-1301-101 | 586-1302-101 | 586-1303-101 | 586-1305-101 | 586-1306-101 |
| 7374, 7376 | T1 3/4 | Bi-Pin | 28 | Polarized | 586-1301-105 | 586-1302-105 | 586-1303-105 | 586-1305-105 | 586-1306-105 |
| 7377, 7380, 7381 | T1 3/4 | Bi-Pin | 6 | Polarized | 586-1301-101 | 586-1302-101 | 586-1303-101 | 586-1305-101 | 586-1306-101 |
| 7382 | T1 3/4 | Bi-Pin | 14 | Polarized | 586-1301-103 | 586-1302-103 | 586-1303-103 | 586-1305-103 | 586-1306-103 |
| 7387, 7876 | T1 3/4 | Bi-Pin | 28 | Polarized | 586-1301-105 | 586-1302-105 | 586-1303-105 | 586-1305-105 | 586-1306-105 |
| 7945 | T1 3/4 | Bi-Pin | 6 | Polarized | 586-1301-101 | 586-1302-101 | 586-1303-101 | 586-1305-101 | 586-1306-101 |

Notes -

- ▲ To maximize light output the LED emitting color should match lens or filter
- ▲ Based LEDs are designed for specified operating voltage
- ▲ Based LEDs listed are for typical applications, some applications may require modifications to the products
- ▲ Additional products are available. Contact factory for details.

UNDERSTANDING BASED LEDs

A COMPARISON BETWEEN LED AND INCANDESCENT

LED

Light produced through luminescence

Typical 100K hours of life

Semiconductor based light

Constant current

Epoxy encapsulation is rugged under exposure to shock and vibration

Up to 90% less power required

Responds 0.2 seconds faster

Low maintenance

INCANDESCENT

Generate heat to produce light

Typical 2K hours of operation

Light source being burned away

Subject to inrush current

Susceptible to catastrophic failures

Uses high power

Slow response

Frequent maintenance

COST COMPARISON BETWEEN LED AND INCANDESCENT BULBS

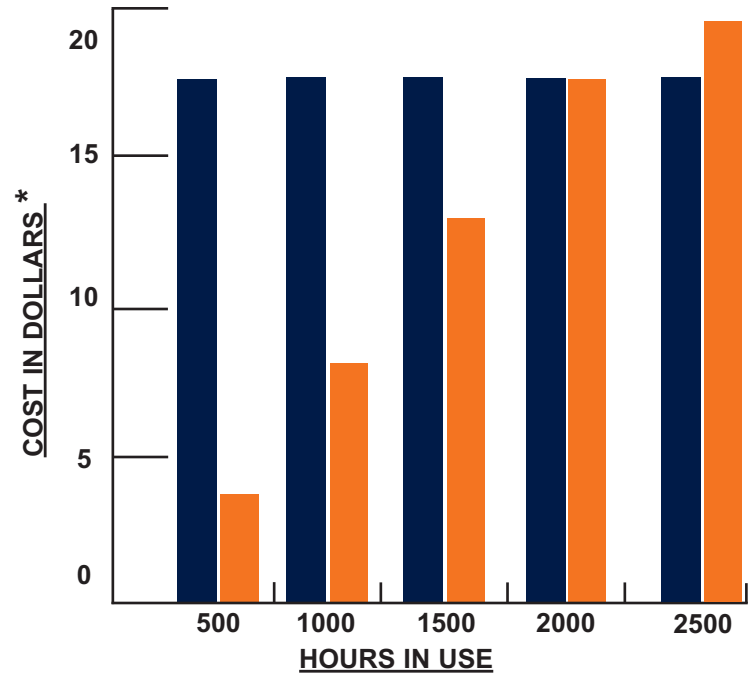

■ Based LED ■ Incandescent Bulbs

*Cost includes -replacement of bulb, labor, and energy savings

LED Configuration:

Single Chip - The single chip design consists of a single ultra-bright LED of the latest LED technology, AlInGaP or InGaN, which is mounted onto an incandescent base. Even though there is only one LED, this high intensity product can provide equivalent light output of the bulb it replaces. This design has a slightly narrower viewing angle than either the multi-chip or cluster, yet is one of the most cost-effective designs available.

Cluster - The cluster uses multiple discrete SMD or 3 mm (T1) LEDs mounted into the appropriate incandescent base. The viewing angle of the cluster is 120°, however the use of multiple LEDs increases the overall light output. The overall design provides flexibility where the latest in LED technology, AlInGaP and InGaN, can be employed.

Multi-chip - The multi-chip device incorporates 6 LED die-mounted on a specially designed ceramic header which is then placed onto a traditional incandescent base. It's unique construction enables versatility; not only can the die be mounted on this header but additional components can be added. Typical viewing angle of the multi-chip is 120°.

Polarity

LEDs are diodes which allow current to flow in only one direction. If you are unfamiliar with the polarity of your circuit, a rectifying circuit must be used. Dialight's non-polarized based LEDs incorporate a full wave rectifier and all the necessary components to allow proper operation in any circuit providing the correct voltage is used.

Maximizing Light Output

Since lens caps act as filters for the light emitted from the based LED, it is important to match the emitting color of the LED. If not matched properly, the overall light output may be substantially reduced. Dialight recommends using transparent lenses which will optimize the light output.

Dialight

*Dialight Corporate Office
1501 Rt 34 South
Farmingdale, NJ 07727 USA
Tel: +1.732.919.3119
Fax: +1.732.751.5778
Email: info@dialight.com*



Dialight reserves the right to make changes at any time in order to supply the best product possible.
Contact us directly for the latest information.

www.dialight.com

© 2008 Dialight Corp. All Rights Reserved
Based LED Selector Guide Ver 1