



Heyco® EMC Metal Liquid Tight Cordgrips

EMC Nickel-Plated Brass with Contact Sleeve

PG Hubs

- Excellent 360° shield contact with contact sleeve due to braided shield which runs into the gland.
- Combination of the sealing insert and the contact socket guarantees a constant contact quality with minimal transfer impedance.
- Ideal for applications where Electromagnetic Compatibility (EMC) is needed.
- Long thread for use in standard or thick panels.
- Inner cable protection.
- Nickel-plated finish over brass provides excellent corrosion resistance and durability.
- EMC locknuts available. See page X-X.
- Multiple sizes for cable diameters ranging from .10" (2,5 mm) to 1.00" (25,5 mm).
- IP 68 Rated.
- Temperature range of -40°F (-40°C) to 212°F (100°C).
- Cord Grips are made of nickel plated brass and the gland is made of TPE.



CABLE DIA. RANGE				PART NO.	Thread Size	Clearance Hole		PART DIMENSIONS					
Minimum		Maximum						A Max. O.A. Length		B Thread Length		C Wrenching Flat Size	
in.	mm.	in.	mm.			in.	mm.	in.	mm.	in.	mm.	in.	mm.
.18	4,5	.24	6,0	4600	PG7	.50	12,7	1.06	27,0	.39	10,0	.59	15,0
.24	6,0	.30	7,5	4641	PG7	.50	12,7	1.06	27,0	.39	10,0	.59	15,0
.24	6,0	.32	8,0	4644	PG9	.61	15,5	1.18	30,0	.39	10,0	.71	18,0
.32	8,0	.39	10,0	4645	PG9	.61	15,5	1.26	32,0	.39	10,0	.71	18,0
.22	5,5	.33	8,5	4647	PG11	.75	19,0	1.22	31,0	.39	10,0	.83	21,0
.33	8,5	.47	12,0	4648	PG11	.75	19,0	1.22	31,0	.39	10,0	.83	21,0
.32	8,0	.43	11,0	4650	PG13	.83	21,1	1.22	31,0	.39	10,0	.94	24,0
.43	11,0	.55	14,0	4651	PG13	.83	21,1	1.3	33,0	.39	10,0	.94	24,0
.32	8,0	.43	11,0	4653	PG16	.91	23,1	1.22	31,0	.39	10,0	.94	24,0
.43	11,0	.55	14,0	4654	PG16	.91	23,1	1.3	33,0	.39	10,0	.94	24,0
.51	13,0	.63	16,0	4656	PG21	1.14	29,0	1.45	37,0	.47	12,0	1.18	30,0
.63	16,0	.75	19,0	4657	PG21	1.14	29,0	1.57	40,0	.47	12,0	1.18	30,0
.75	19,0	.91	23,0	4659	PG29	1.48	37,6	1.61	41,0	.47	12,0	1.50	38,0
.91	23,0	1.00	25,5	4660	PG29	1.48	37,6	1.61	41,0	.47	12,0	1.50	38,0

Metric Hubs

CABLE DIA. RANGE				PART NO.	Thread Size	Clearance Hole		PART DIMENSIONS					
Minimum		Maximum						A Max. O.A. Length		B Thread Length		C Wrenching Flat Size	
in.	mm.	in.	mm.			in.	mm.	in.	mm.	in.	mm.	in.	mm.
.10	2,5	.14	3,5	4613	M8x1,25	.33	8,4	.94	24,0	.39	10,0	.43	11,0
.12	3,0	.16	4,0	4614	M8x1,25	.33	8,4	.94	24,0	.39	10,0	.43	11,0
.12	3,0	.16	4,0	4615	M10x1,5	.41	10,4	.98	25,0	.39	10,0	.51	13,0
.16	4,0	.24	6,0	4616	M10x1,5	.41	10,4	.98	25,0	.39	10,0	.51	13,0
.18	4,5	.24	6,0	4618	M12x1,5	.50	12,7	1.06	27,0	.39	10,0	.59	15,0
.24	6,0	.30	7,5	4619	M12x1,5	.50	12,7	1.06	27,0	.39	10,0	.59	15,0
.24	6,0	.32	8,0	4622	M16x1,5	.64	16,3	1.18	30,0	.39	10,0	.71	18,0
.32	8,0	.39	10,0	4623	M16x1,5	.64	16,3	1.26	32,0	.39	10,0	.71	18,0
.32	8,0	.43	11,0	4625	M20x1,5	.80	20,3	1.22	31,0	.39	10,0	.94	24,0
.43	11,0	.55	14,0	4626	M20x1,5	.80	20,3	1.30	33,0	.39	10,0	.94	24,0
.51	13,0	.63	16,0	4628	M25x1,5	1.00	25,4	1.41	36,0	.43	11,0	1.18	30,0
.63	16,0	.75	18,0	4629	M25x1,5	1.00	25,4	1.53	39,0	.43	11,0	1.18	30,0
.71	18,0	.83	21,0	4631	M32x1,5	1.27	32,3	1.65	42,0	.51	13,0	1.42	36,0
.21	21,0	.98	25,0	4632	M32x1,5	1.27	32,3	1.65	42,0	.51	13,0	1.42	36,0

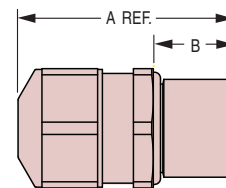
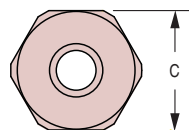

Quick Specs

Material	Nickel-Plated Brass W/TPE sealing gland
Certifications	Recognized under the Component Program of Underwriters' Laboratories File E51579 to both Canadian and U.S. requirements
Temperature Rating	-40°F (-40°C) to 212°F (100°C)
IP Rating	IP 68