

LTR	EN	DESCRIPTION	APPR	BY	DATE
A	-	INITIAL RELEASE	RB	DC	01-28-05
A1	-	ADDED BLACK NUT	RB	DC	02-17-05

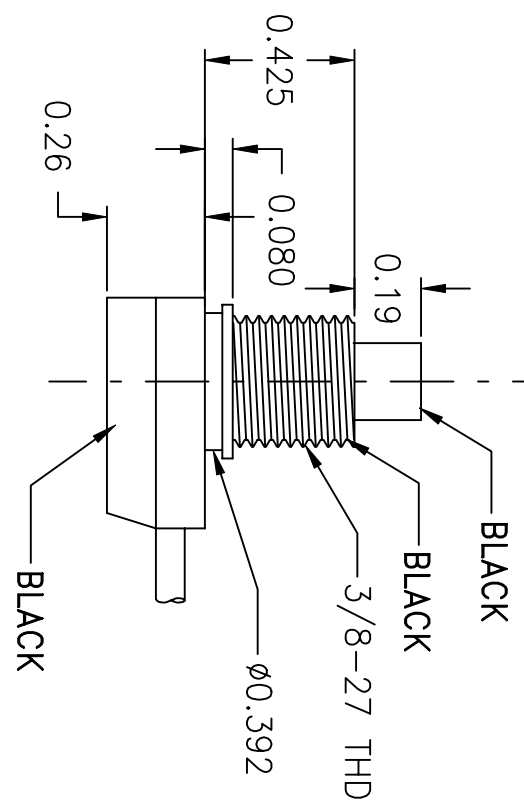
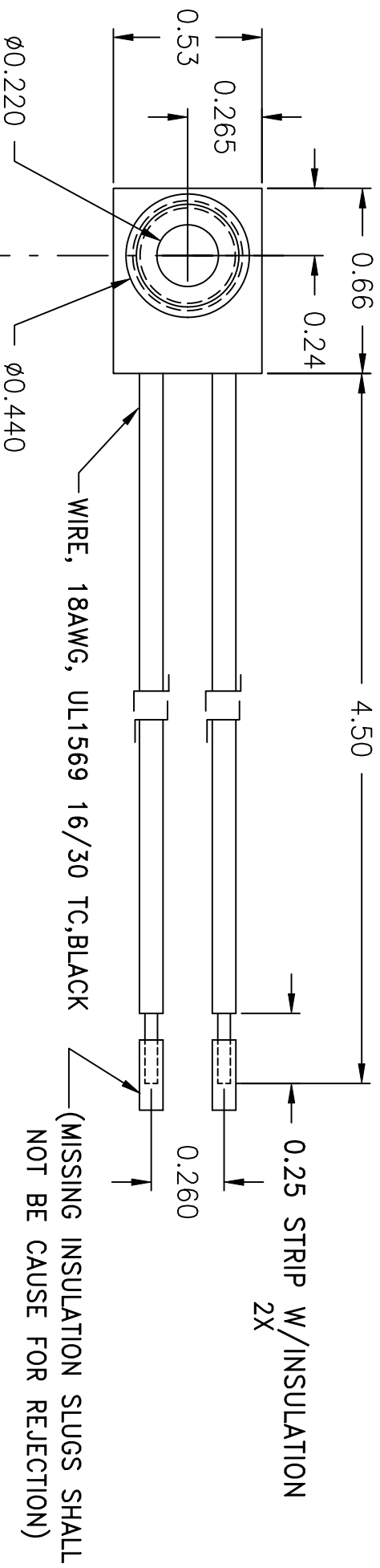

JUDCO INVENTORY NO. 40-4314-00
 SWITCH TYPE: MOMENTARY, NORMALLY OPEN
 UL ELECTRICAL RATING: 14VDC, 4A-T
 UL TEMPERATURE RATING: 65°C
 NUT PACKED SEPARATELY.

CUSTOMER: DIGI-KEY
 CUSTOMER PN: TBD

APPROVED BY: _____
 DATE: _____

DIMENSIONS IN INCHES
 DIMENSIONS ARE REFERENCE

DRAWN: DC 01-28-05
 APPR: KJ 02-17-05

1415U742A1.DWG

TITLE
 HARBOR CITY CALIFORNIA
 OUTLINE
 J-188A-2S ULDC

DWG. NO. 1415-742
 SHEET 1 OF 1

This document embodies a product, component, and/or design proprietary to JUDCO MANUFACTURING INC., and which is protected either as a trade secret, by U.S. Patent, or by copyright. It may not be used in any way without written express consent of JUDCO MANUFACTURING INC.