

DRAWING MADE IN THIRD ANGLE PROJECTION  
 THIS DRAWING IS UNPUBLISHED. RELEASED FOR PUBLICATION .19  
 © COPYRIGHT 19 BY AMP INCORPORATED. ALL INTERNATIONAL RIGHTS RESERVED.

| LOC |    | DIST |   | ZONE |  | LTR |  | REVISIONS               |  | DATE    | APPD  |
|-----|----|------|---|------|--|-----|--|-------------------------|--|---------|-------|
| CM  | 53 | P    | F |      |  | L   |  | REV PER EC 0730-0245-95 |  | 1-25-95 | JH RS |

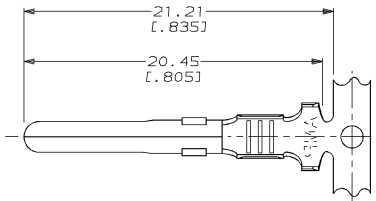

1. WIRE RANGE: 2 WIRES OF 0.8 - 0.9 mm<sup>2</sup> [18 AWG] OR 1 WIRE OF 0.8 - 0.9 mm<sup>2</sup> [18 AWG] AND 1 WIRE OF 1.25 - 1.4 mm<sup>2</sup> [16 AWG].
2. INSULATION RANGE: 2 WIRES OF 2.92 [.115] MAX DIA EACH, STACKED.
3. DIMENSIONS IN BRACKETS ARE IN INCHES.

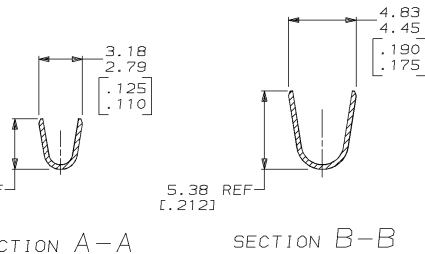
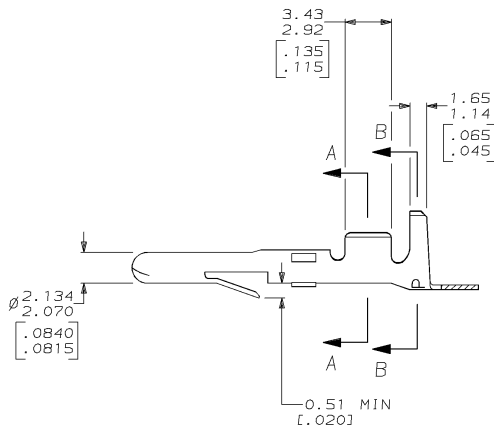

**METRIC**

THIS DRAWING IS A CONTROLLED DOCUMENT FOR AMP INCORPORATED. IT IS SUBJECT TO CHANGE AND THE CONTROLLING ENGINEERING ORGANIZATION SHOULD BE CONTACTED FOR THE LATEST REVISION.

|         |                    |          |
|---------|--------------------|----------|
| PRE-TIN | 0.30 [.012] PH BRZ | 350558-4 |
| PRE-TIN | 0.30 [.012] BRASS  | 350558-1 |
| FINISH  | MATERIAL           | PART NO  |

|   |   |   |                        |
|---|---|---|------------------------|
| DO NOT SCALE PRINT.<br>UNLESS SPECIFIED<br>DIMENSIONS IN mm [INCHES]<br>TOLERANCES ON :<br>2 PLC DEC ± -<br>3 PLC DEC ± 0.13 (.005)<br>ANGLES ± - | DR 1-20-93<br>T. BECK<br>CHK 1-20-93<br>R. SWING<br>APPD 1-25-93<br>C. MARTIN | AMP AMP Incorporated<br>Harrisburg, PA 17105-3608 |                        |
| MATERIAL<br>SEE TABLE   | APPD 1-25-93<br>C. MARTIN<br>PRODUCT SPEC<br>-                                | NAME<br>PIN, MATE-N-LOK™                          |                        |
| FINISH<br>SEE TABLE   | APPLICATION SPEC<br>-   | SIZE<br>C 00779                                   | DRAWING NO<br>C=350558 |
| WEIGHT<br>-   | SCALE<br>5:1  | SHEET 1 OF 1                                      |                        |