

REV	DATE	DESCRIPTION	BY	CHK	APP
D	22FEB07	REVISED PER ECO-07-003723	KW	DB	
DT		REVISED PER ECO-09-021510	19AUG09	KK	AEG

1. MATERIAL: CONNECTOR-NYLON UL94V-2 (GREEN).
 CONTACTS-0.30 [.012] THICK COPPER ALLOY
 BRIGHT TIN-LEAD 0.00203 [.000080] MINIMUM THICK FOR CONTACTS
 641537-2 THRU 641537-3,
 MATTE WHISKER MITIGATED TIN PLATE 0.00203 [.000080] MINIMUM THICK OVER
 NICKEL UNDERPLATE FOR CONTACTS 3-641537-2 THRU 3-641537-3.
2. CONTACTS ACCEPT 28 AWG WIRE WITH 1.52 [.060] MAXIMUM INSULATION DIAMETER.
3. CONTACTS MUST ACCEPT 0.36-0.51 [.014-.020] SQUARE OR ROUND POST AND
 REMAINED LOCKED IN POSITION.
4. IDENTIFICATION NUMBER FOR LAST CIRCUIT MAY NOT APPEAR ON ALL ASSEMBLIES.
5. DIMENSIONS IN BRACKETS ARE IN INCHES.
6. HOUSING FEATURES ARE: CLOSED END WITH LOCKING RAMP & LED CONTACT.
- △ OBSOLETE PARTS: OBSOLETE CIS STREAMLINING PER D.RENAUD/D.SINISI

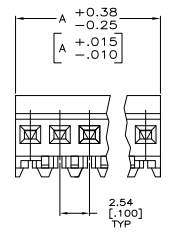
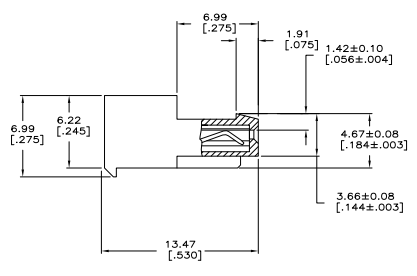
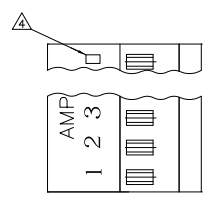

LEAD FREE	DIM A		NO. OF POSN		ASSEMBLY	
	7.62 [.300]	5.08 [.200]	3	2	3-641537-3	3-641537-2

CONTAINS LEAD	DIM A		NO. OF POSN		ASSEMBLY	
	7.62 [.300]	5.08 [.200]	3	2	641537-3	641537-2

△ SUPERSEDED



THIS DRAWING IS A CONTROLLED DOCUMENT. METRIC ELECTRONICS CORPORATION, 17100-3608, Harrisburg, PA 17106-3608.

DESIGNER: J. BOGGS, CHECKER: J. BOGGS, DATE: 10-10-05, REV: 114-1019, DRAWING NO: A100779, CUSTOMER DRAWING: G-641537.

SIZE: 5.1, SHEET: 1 OF 1, REV: DT