

1. MATERIAL: CONNECTOR-NYLON UL94V-2 (WHITE).  
 CONTACTS-0.30 [.012] THICK COPPER ALLOY  
 BRIGHT TIN-LEAD 0.00203 [.000080] MINIMUM THICK FOR CONTACTS  
 641535-2 THRU 641535-6,  
 MATTE WHISKER MITIGATED TIN PLATE 0.00203 [.000080] MINIMUM THICK OVER  
 NICKEL UNDERPLATE FOR CONTACTS 3-641535-2 THRU 3-641535-6.
2. CONTACTS ACCEPT 24 AWG WIRE WITH 1.52 [.060] MAXIMUM INSULATION DIAMETER.
3. CONTACTS MUST ACCEPT 0.36-0.51 [.014-.020] SQUARE OR ROUND POST AND REMAINED LOCKED IN POSITION.
4. IDENTIFICATION NUMBER FOR LAST CIRCUIT MAY NOT APPEAR ON ALL ASSEMBLIES.
5. DIMENSIONS IN BRACKETS ARE IN INCHES.
6. HOUSING FEATURES ARE: CLOSED END WITH LOCKING RAMP & LED CONTACT.
- OBsolete PARTS: OBSOLETE CIS STREAMLINING PER D.RENAUD/D.SINISI

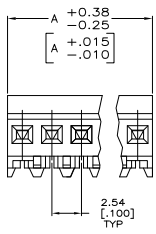
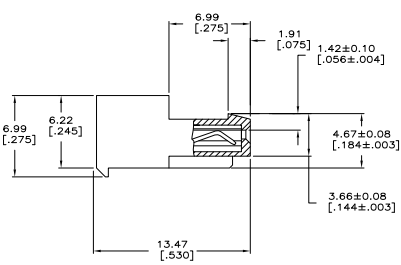
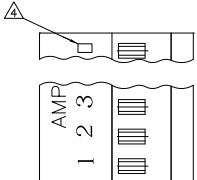

LEAD FREE	15.24	[.600]	6	3-641535-6
	12.70	[.500]	5	3-641535-5
	7.62	[.300]	3	3-641535-3
	5.08	[.200]	2	3-641535-2
	DIM A		NO.OF POSN	ASSEMBLY

CONTAINS LEAD	15.24	[.600]	6	641535-6
	12.70	[.500]	5	641535-5
	7.62	[.300]	3	641535-3
	5.08	[.200]	2	641535-2
	DIM A		NO.OF POSN	ASSEMBLY

~~△ SUPERSEDED~~  
~~△ SUPERSEDED~~



THIS DRAWING IS A CONTROLLED DOCUMENT.

DESIGNED BY	10-001-0001
DR	10-001-0001
BY	10-001-0001
DATE	108-1050
OPERATION SPEC	114-1019
REV	A1

TE Connectivity  
 MTA-100 CONNECTOR ASSEMBLY,  
 24 AWG, FOR .014 TO .020 POST, SPECIAL

DATE SIZE DRAWING NO. 100779 (G) 641535

CUSTOMER DRAWING