

4

3

2

1

THIS DRAWING IS UNPUBLISHED. RELEASED FOR PUBLICATION. ALL RIGHTS RESERVED.

LOC	DIST	REVISIONS			
F	LNK	DESCRIPTION	DATE	BY	APPD
CM	OO	T3	REVISED PER ECO-11-004917	11MAR11	RK HMR

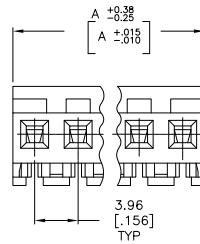
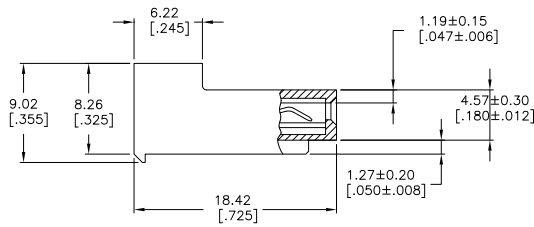
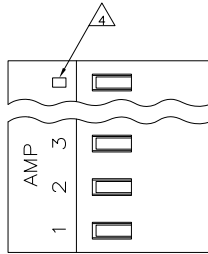

95.10 [3.744]	24	5-640432-4
91.13 [3.588]	23	5-640432-3
87.17 [3.432]	22	5-640432-2
83.21 [3.276]	21	5-640432-1
79.25 [3.120]	20	5-640432-0
75.29 [2.964]	19	4-640432-9
71.32 [2.808]	18	4-640432-8
67.36 [2.652]	17	4-640432-7
63.40 [2.496]	16	4-640432-6
59.44 [2.340]	15	4-640432-5
55.47 [2.184]	14	4-640432-4
51.51 [2.028]	13	4-640432-3
47.55 [1.872]	12	4-640432-2
43.59 [1.716]	11	4-640432-1
39.62 [1.560]	10	4-640432-0
35.66 [1.404]	9	3-640432-9
31.70 [1.248]	8	3-640432-8
27.74 [1.092]	7	3-640432-7
23.77 [936]	6	3-640432-6
19.81 [780]	5	3-640432-5
15.85 [624]	4	3-640432-4
11.89 [468]	3	3-640432-3
7.92 [312]	2	3-640432-2
3.96 [156]	1	3-640432-1

△ SUPERCEDED BY 5-640432-4	95.10 [3.744]	24	2-640432-4
SUPERCEDED BY 3-640432-3	91.13 [3.588]	23	2-640432-3
SUPERCEDED BY 5-640432-2	87.17 [3.432]	22	2-640432-2
SUPERCEDED BY 5-640432-1	83.21 [3.276]	21	2-640432-1
SUPERCEDED BY 5-640432-0	79.25 [3.120]	20	1-640432-0
SUPERCEDED BY 4-640432-9	75.29 [2.964]	19	1-640432-9
SUPERCEDED BY 4-640432-8	71.32 [2.808]	18	1-640432-8
SUPERCEDED BY 4-640432-7	67.36 [2.652]	17	1-640432-7
SUPERCEDED BY 4-640432-6	63.40 [2.496]	16	1-640432-6
SUPERCEDED BY 4-640432-5	59.44 [2.340]	15	1-640432-5
SUPERCEDED BY 4-640432-4	55.47 [2.184]	14	1-640432-4
SUPERCEDED BY 4-640432-3	51.51 [2.028]	13	1-640432-3
SUPERCEDED BY 4-640432-2	47.55 [1.872]	12	1-640432-2
SUPERCEDED BY 4-640432-1	43.59 [1.716]	11	1-640432-1
	39.62 [1.560]	10	1-640432-0
	35.66 [1.404]	9	640432-9
	31.70 [1.248]	8	640432-8
	27.74 [1.092]	7	640432-7
	23.77 [936]	6	640432-6
	19.81 [780]	5	640432-5
	15.85 [624]	4	640432-4
	11.89 [468]	3	640432-3
	7.92 [312]	2	640432-2

△ MATERIAL: CONNECTOR - NYLON UL94-V2 (YELLOW)
 CONTACTS - 0.30[.012] THICK COPPER ALLOY
 (BRIGHT TIN-LEAD 0.00203[.000080] MIN. THICK
 FOR CONTACTS 640432-2 THRU 2-640432-4).
 (MATTE WHISKER MITIGATED TIN 0.00203[.000080] MIN.
 THICKNESS OVER NICKEL UNDERPLATE FOR 3-640432-2
 THRU 5-640432-4).

2. CONTACTS ACCEPT 20 AWG WIRE WITH 2.41[.095] MAX INSULATION DIAMETER.

3. CONTACTS MUST ACCEPT 1.14±0.03[.045] POST AND REMAIN LOCKED IN POSITION.

△ IDENTIFICATION NUMBER FOR LAST CIRCUIT MAY NOT APPEAR ON ALL ASSEMBLIES.

5. DIMENSIONS IN BRACKETS ARE IN INCHES.

6. HOUSING FEATURES ARE: CLOSED END WITH LOCKING RAMP.

△ OBSOLETE PARTS: OBSOLETE CIS STREAMLINING PER D.RENAUD/D.SINISI

METRIC

THIS DRAWING IS A CONTROLLED DOCUMENT.

DRW: S. CARPENTER	13AUG2003	DATE	13AUG2003
CHK: D. BOSSI	13AUG2003	DATE	13AUG2003
APP: D. BOSSI	13AUG2003	DATE	13AUG2003
PRODUCT SPEC:	108-1051	APPLICATION SPEC:	114-1020
WEIGHT:	-	SIZE:	A2
CAGE CODE:	00779	DRAWING NO.:	640432
CUSTOMER DRAWING		SCALE:	4:1
		SHEET:	1 of 1
		REV:	T3

TE Connectivity
 MTA 156 CONNECTOR ASSEMBLY,
 20 AWG, STANDARD

RESTRICTED TO: -