

# C&K 1000 Series Miniature Slide Switches

## Features/Benefits

- Variety of actuators and terminations
- Panel mount tabs available
- Epoxy terminal seal—compatible with bottom-wash cleaning

## Typical Applications

- Test & measurement equipment
- Telecommunications
- Computer & peripherals

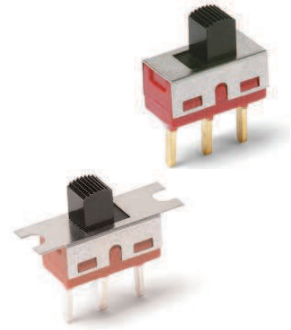

## Specifications

**CONTACT RATING:** B contact material: 0.4 VA max. @ 20 V AC or DC max. Q contact material: 6 AMPS @ 120 V AC or 28 V DC, 3 AMPS @ 250 V AC. See page I-16 for additional ratings.

**ELECTRICAL LIFE:** 100,000 make-and-break cycles at full load on models with B or K contact material; 40,000 cycles on models with G, Q, L or M contact material.

**CONTACT RESISTANCE:** Below 10 m Ω typ. initial @ 2-4 V DC, 100 mA, for both silver and gold plated contacts.

**INSULATION RESISTANCE:** 10<sup>9</sup> Ω min.

**DIELECTRIC STRENGTH:** 1,000 Vrms min. @ sea level.

**OPERATING TEMPERATURE:** -30°C to 65°C

**SOLDERABILITY:** Per MIL-STD-202F method 208D, or EIA RS-186E method 9 (1 hour steam aging).

## Materials

**CASE:** diallyl phthalate (DAP), (UL 94V-0).

**ACTUATOR:** Nylon, black, standard.

**HOUSING:** Stainless steel.

**SWITCH SUPPORT:** Brass or steel, tin plated.

**END CONTACTS:** B contact material: Copper alloy, with gold plate over nickel plate. Q contact material: Coin silver, silver plated. See page I-16 for additional contact materials.

**CENTER CONTACT & ALL TERMINALS:** B contact material: Copper alloy, with gold plate over nickel plate. Q contact material: Copper alloy, silver plated. See page I-16 for additional contact materials.

**TERMINAL SEAL:** Epoxy

**NOTE:** Specifications and materials listed above are for switches with standard options. For information on specific and custom switches, consult Customer Service Center.



Slide

## Build-A-Switch

To order, simply select desired option from each category and place in the appropriate box. Available options are shown and described on pages I-12 thru I-16. For additional options not shown in catalog, consult Customer Service Center. All models have epoxy terminal seal and are compatible with all "bottom-wash" PCB cleaning methods.

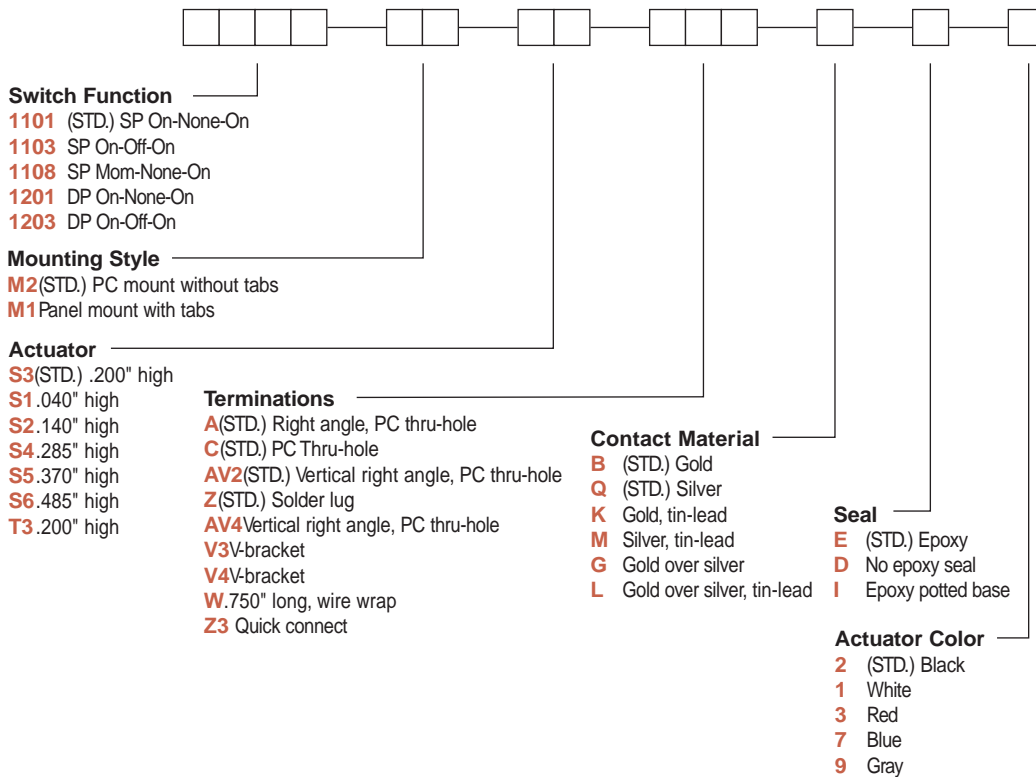

# C&K 1000 Series Miniature Slide Switches

## SWITCH FUNCTION

NO. POLES	MODEL NO.	SWITCH FUNCTION			CONNECTED TERMINALS			SCHEMATIC
		POS. 1	POS. 2	POS. 3	POS. 1	POS. 2	POS. 3	
SP	<b>1101 (STD.)</b>	ON	NONE	ON		N/A		 SPDT
	<b>1103</b>	ON	OFF	ON	1-2	OPEN	2-3	
	<b>1108</b>	MOM.	NONE	ON		N/A		
<b>SPDT</b>  Part number shown: 1101M2S3CQE2 Terminal Nos. For Reference Only								
DP	<b>1201</b>	ON	NONE	ON	2-1,5-4	OPEN	2-3,5-6	 DPDT
	<b>1203</b>	ON	OFF	ON				
<b>DPDT</b>  Part number shown: 1201M2S3CQE2 Terminal Nos. For Reference Only								

MOM. = Momentary

All models with all options when ordered with G, L, M or Q contact material.

## MOUNTING STYLE

**M2** (STD.) PC MOUNTING WITHOUT TABS

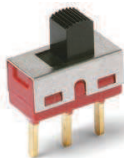

**M1** PANEL MOUNTING WITH TABS

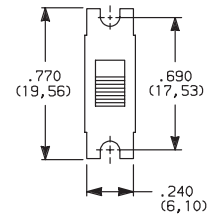
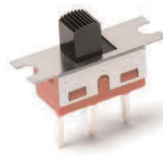

**NOTE:** Available with A, AV2, C, V3, V4, W terminations only.

**NOTE:** Available with C, W, Z, Z3 terminations only. No mounting hardware supplied.

### PANEL MOUNTING

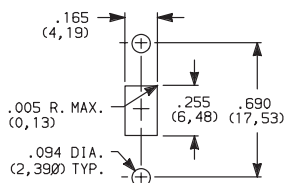

All actuators except T3.  
Single pole

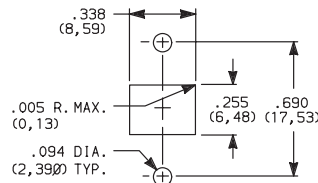

For T3 actuator only.  
Double pole



Dimensions are shown: IN (mm)  
Dimensions subject to change

# C&K 1000 Series Miniature Slide Switches

## ACTUATOR

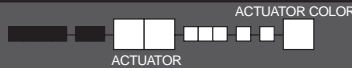

**S3** (STD.) .200" HIGH

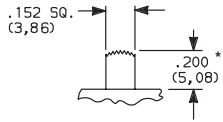

**S2** .140" HIGH

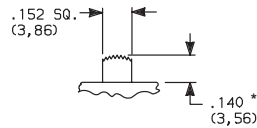

110X models only.

**S1** .040" HIGH

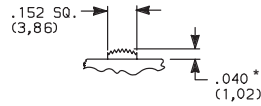

120X models only.

**S4** .285" HIGH

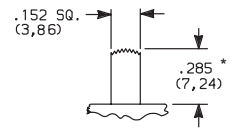

**S5** .370" HIGH

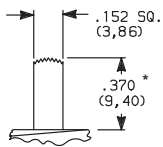

**S6** .485" HIGH

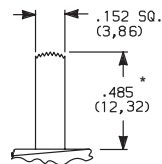

**T3** .200" HIGH

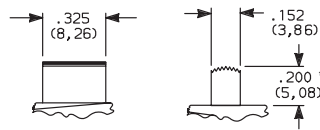

120X models only.

OPTION CODE	ACTUATOR COLOR
2	(STD.) BLACK
1	WHITE
3	RED
7	BLUE
9	GRAY

Other colors available, consult Customer Service Center.

\* Subtract .014 (0,36) from actuator height, all models with A, AV2, V3, V4 terminations.

## TERMINATIONS

**Z** (STD.) SOLDER LUG

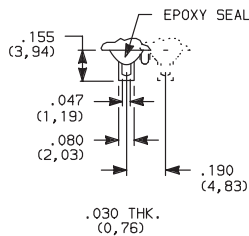

Not available with K, L or M contact materials.

**C** (STD.) PC THRU-HOLE

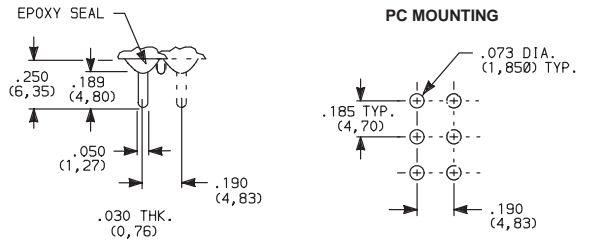

**SPDT & DPDT**

**SPDT & DPDT**

**Z3** QUICK CONNECT

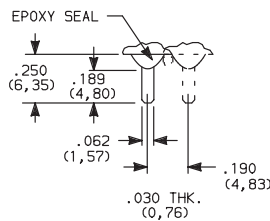

Not available with K, L or M contact materials. Mating quick connector available; order part number 530100000, page I-16.

**W** WIRE WRAP

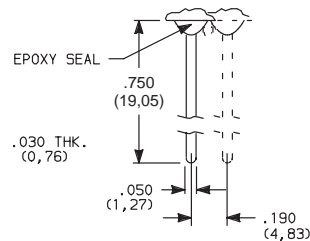

**SPDT & DPDT**

**SPDT & DPDT**



Dimensions are shown: IN (mm)  
Dimensions subject to change



Cannon

www.ittcannon.com

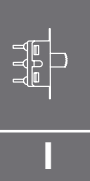

Slide

# C&K 1000 Series Miniature Slide Switches

## TERMINATIONS

**A** (STD.) RIGHT ANGLE, PC THRU-HOLE



**1101M2S3ABE2**  
Horizontal Actuation  
**SPDT**

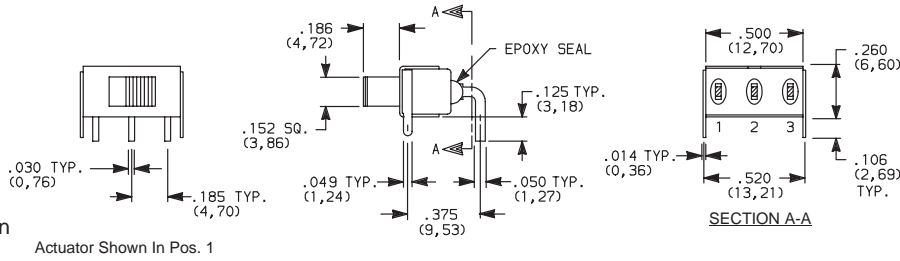

**PC MOUNTING**

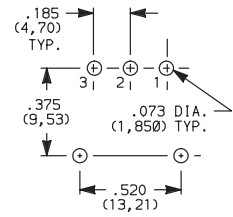

Not available with M1 mounting style, I seal option.  
Terminal bend radii and lead-in manufacturing option.

**A** (STD.) RIGHT ANGLE, PC THRU-HOLE

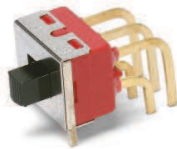

**1201M2S3ABE2**  
Horizontal Actuation  
**DPDT**

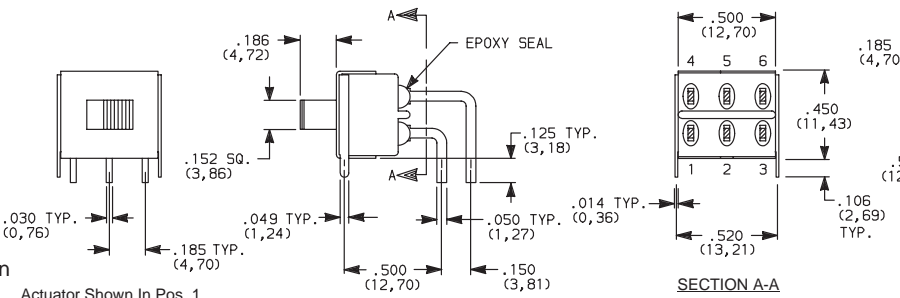

**PC MOUNTING**

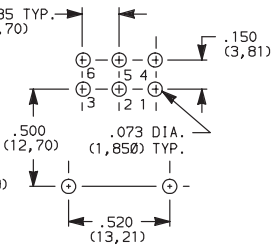

Not available with M1 mounting style, I seal option.  
Terminal bend radii and lead-in manufacturing option.

**AV2** (STD.) VERTICAL RIGHT ANGLE, PC THRU-HOLE,  
.150" PITCH



**1101M2S3AV2BE2**  
Vertical Actuation  
**SPDT**

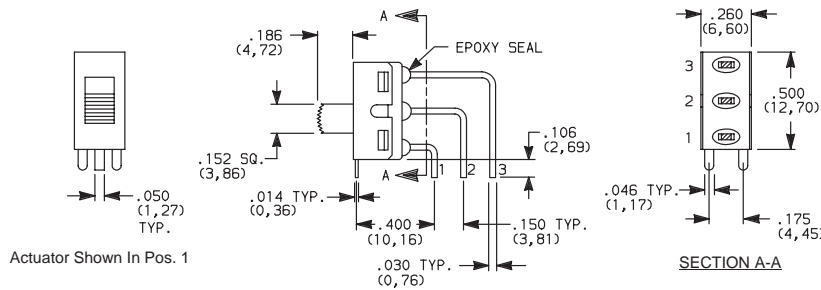

**PC MOUNTING**

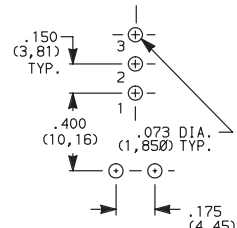

Not available with M1 mounting style, I seal option.  
Terminal bend radii and lead-in manufacturing option.

**AV4** VERTICAL RIGHT ANGLE, PC THRU-HOLE,  
.150" PITCH, EXTENDED

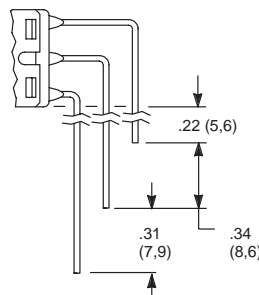

Dimensions are shown: IN (mm)  
Dimensions subject to change

www.ittcannon.com

# C&K 1000 Series Miniature Slide Switches

## TERMINATIONS

**AV2** (STD.) VERTICAL RIGHT ANGLE, PC THRU-HOLE,  
.150" PITCH

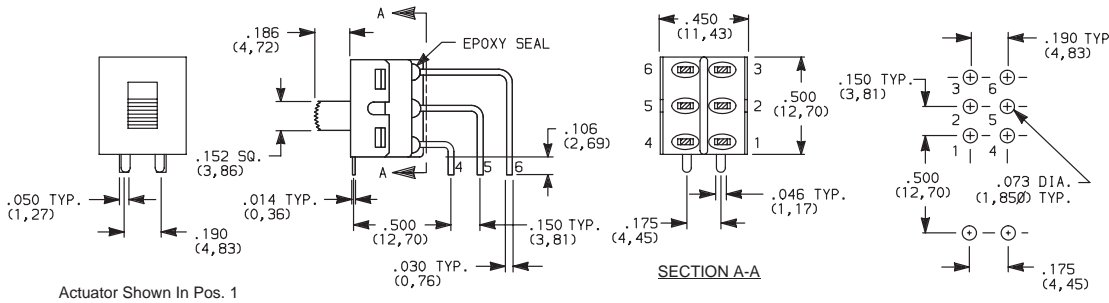

Not available with M1 mounting style, I seal option.  
Terminal bend radii and lead-in manufacturing option.

**AV4** VERTICAL RIGHT ANGLE, PC THRU-HOLE,  
.150" PITCH, EXTENDED

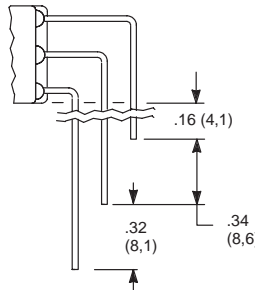

**V3, V4** VERTICAL MOUNT,  
V-BRACKET

OPTION CODE	DIM 'A'
V3	.350 (8,89)
V4	.525 (13,34)

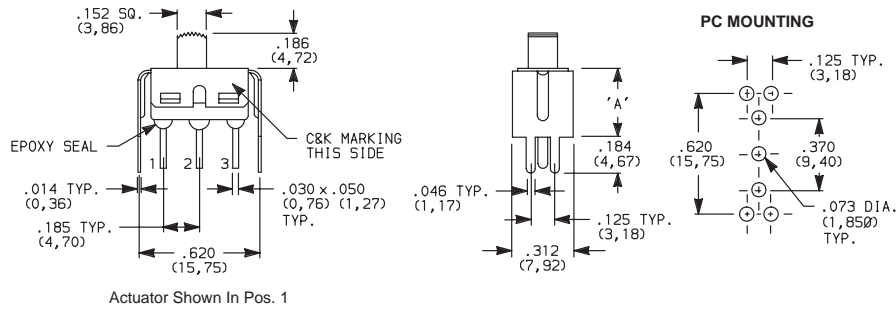

Not available with M1 mounting style and I seal.

**V3, V4** VERTICAL MOUNT,  
V-BRACKET

OPTION CODE	DIM 'A'
V3	.400 (10,16)
V4	.575 (14,61)

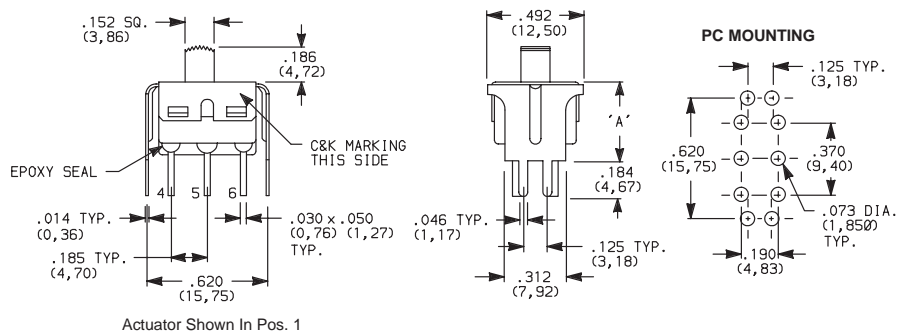

Not available with M1 mounting style and I seal.



Dimensions are shown: IN (mm)  
Dimensions subject to change



# C&K 1000 Series Miniature Slide Switches

## CONTACT MATERIAL

OPTION CODE	CONTACT MATERIAL	TERMINAL PLATING	RATINGS	
<b>B (STD.)</b>	GOLD <sup>1</sup>	GOLD <sup>1</sup>	LOW LEVEL/DRY CIRCUIT	0.4 VA MAX. @ 20 V AC OR DC MAX.
<b>K</b>		TIN-LEAD <sup>6</sup>		
<b>Q (STD.)</b>	SILVER <sup>4,5</sup>	SILVER <sup>5</sup>	POWER	6 AMPS @ 120 V AC OR 28 V DC; 3 AMPS @ 250 V AC.
<b>M</b>		TIN-LEAD <sup>6</sup>		
<b>G</b>	GOLD OVER SILVER <sup>2,3</sup>	GOLD <sup>3</sup>	LOW LEVEL/DRY CIRCUIT OR POWER	0.4 VA MAX @ 20 V AC OR DC MAX OR 6 AMPS @ 120 V AC OR 0.4 MAX. 28 V DC; 3 AMPS @ 250 V AC.
<b>L</b>		TIN-LEAD <sup>6</sup>		

CONTACT MATERIAL/APPLICATION RECOMMENDATIONS—SEE SECTION N.

- <sup>1</sup> CONTACTS & TERMINALS: Copper alloy, with gold plate over nickel plate.
- <sup>2</sup> END CONTACTS: Coin silver, with gold plate over nickel plate.
- <sup>3</sup> CENTER CONTACTS & ALL TERMINALS: Copper alloy, with gold plate over nickel plate.
- <sup>4</sup> END CONTACTS: Coin silver, silver plated.
- <sup>5</sup> CENTER CONTACT & ALL TERMINALS: Copper alloy, silver plated.
- <sup>6</sup> TERMINALS: Copper alloy, with tin-lead alloy over nickel plate.

All models   with all options when ordered with G, L, M or Q contact material.  
 B contact material standard with all terminations except C, Z, Z3..  
 Q contact material standard with C, Z, Z3 terminations.  
 K, L, M contact materials not available with Z, Z3 terminations.

Slide

## SEAL

### E (STD.) EPOXY SEAL

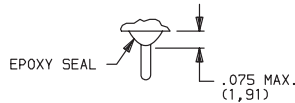

### D NO EPOXY SEAL

### I EPOXY POTTED BASE

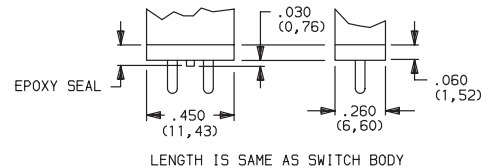

**NOTE:** Available with C, W, W3, Z, Z3 terminations only.

## AVAILABLE HARDWARE

Fits Z3 Termination  
female connector



**PART NO.**  
**530100000**

Available in loose pieces.

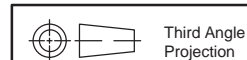

Dimensions are shown: IN (mm)  
Dimensions subject to change