

SC ADAPTER ASSY. P/N	SPLIT SLEEVE MATERIAL
106116-2000	Zr
106116-2200	Ph. Bronze

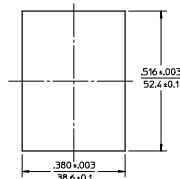
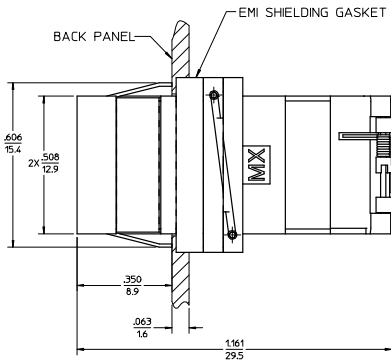
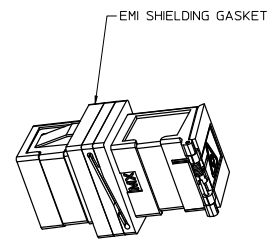
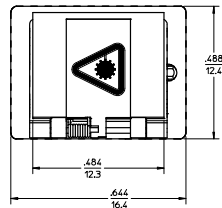
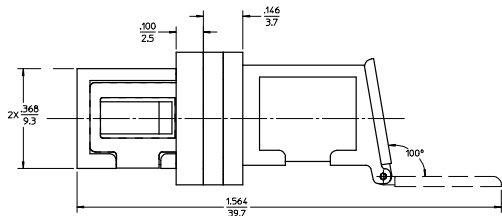

RECOMMENDED MOUNTING CUTOUT
FOR .063" THICK PANEL

NOTES:

1. ALL DIMENSIONS ARE FOR REFERENCE ONLY.
2. DUST CAP IS NOT SHOWN, BUT INCLUDED.
3. ADAPTERS TO BE PACKAGED IN TRAY.

IEC NO: MF2008-0344 DRAWN: REZNER 2008/02/22 CHKD: 2008/02/22 APPR: GUMIN 2008/02/22 REV A2	QUALITY SYMBOLS	GENERAL TOLERANCES (UNLESS SPECIFIED)	DIMENSION STYLE	SCALE	DESIGN UNITS	THIRD ANGLE PROJECTION
	$\nabla=0$ $\nabla=0$	4 PLACES ± --- ± .0002 3 PLACES ± 0.005 ± .005 2 PLACES ± 0.13 ± .01 1 PLACE ± 0.25 ± --- ANGULAR ± 1/2°	IN/MM	4:1	INCH	
		DRAFT WHERE APPLICABLE MUST REMAIN WITHIN DIMENSIONS	DRAWN BY: RPACIFIC1 CHECKED BY: DATE: 2005/10/18 APPROVED BY: DATE:	TITLE: SC METAL ADAPTER MATERIAL NO. SEE TABLE DOCUMENT NO. SD-106116-2000		
			MOLEX INCORPORATED SHEET NO. 1 OF 1			

tb_frame_C_P_ME_T
Rev. D 2004/04/02