

4

3

2

1

THIS DRAWING IS UNPUBLISHED. RELEASED FOR PUBLICATION. ALL RIGHTS RESERVED.

LOC	DIST	REVISIONS			
F	LNK	DESCRIPTION	DATE	BY	APPD
CM	54				
	C2	REVISED PER ECO-11-014117	13JUL11	HMR	SM

- △ MATERIAL: CONNECTOR - NYLON UL94V-2 (ORANGE).
CONTACTS - 0.30 [0.012] THICK COPPER ALLOY
(BRIGHT-TIN LEAD 0.00203 [0.00080] MIN THK FOR CONTACTS 644461-2 THRU 1-644461-4, MATTE WHISKER MITIGATED TIN 0.00203 [0.00080] MIN THICK FOR CONTACTS 3-644461-2 THRU 4-644461-4)
- 2. CONTACTS ACCEPT 18 AWG WIRE WITH 2.41 [0.095] MAX INSULATION DIAMETER.
- 3. CONTACTS MUST ACCEPT 1.14±0.03 [0.045±0.001] SQUARE POST AND REMAIN LOCKED IN POSITION.
- △ IDENTIFICATION NUMBER FOR LAST CIRCUIT MAY NOT APPEAR ON ALL ASSEMBLIES.
- 5. DIMENSIONS IN BRACKETS ARE IN INCHES.
- 6. HOUSING FEATURES ARE: CLOSED END WITHOUT LOCKING RAMP AND WITH POLARIZING TAB.
- △ OBSOLETE PARTS: OBSOLETE CIS STREAMLINING PER D.RENAUD/D.SINISI

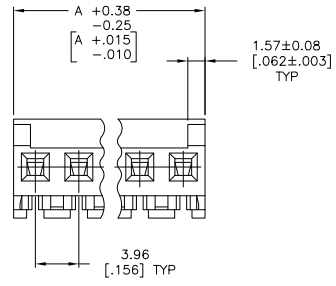
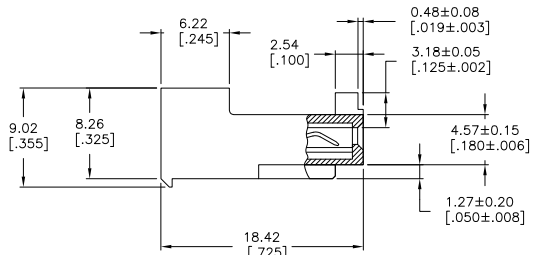
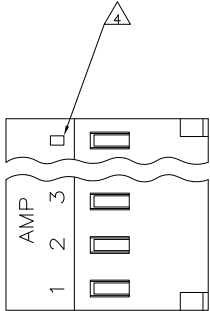

55.47	[2.184]	14	4-644461-4
51.51	[2.028]	13	4-644461-3
47.55	[1.872]	12	4-644461-2
43.59	[1.716]	11	4-644461-1
39.62	[1.560]	10	4-644461-0
35.66	[1.404]	9	3-644461-9
31.70	[1.248]	8	3-644461-8
27.74	[1.092]	7	3-644461-7
23.77	[.936]	6	3-644461-6
19.81	[.780]	5	3-644461-5
15.85	[.624]	4	3-644461-4
11.89	[.468]	3	3-644461-3
7.92	[.312]	2	3-644461-2
△ SUPERCEDED	55.47 [2.184]	14	1-644461-4
△ OBSOLETE	51.51 [2.028]	13	1-644461-3
△ SUPERCEDED	47.55 [1.872]	12	1-644461-2
△ SUPERCEDED	43.59 [1.716]	11	1-644461-1
△ SUPERCEDED	39.62 [1.560]	10	1-644461-0
△ SUPERCEDED	35.66 [1.404]	9	644461-9
△ SUPERCEDED	31.70 [1.248]	8	644461-8
△ SUPERCEDED	27.74 [1.092]	7	644461-7
	23.77 [.936]	6	644461-6
	19.81 [.780]	5	644461-5
	15.85 [.624]	4	644461-4
	11.89 [.468]	3	644461-3
△ SUPERCEDED	7.92 [.312]	2	644461-2

THIS DRAWING IS A CONTROLLED DOCUMENT.

DIMENSIONS: mm [INCHES]	TOLERANCES UNLESS OTHERWISE SPECIFIED:	0 PLC ±	1 PLC ±	2 PLC ±	3 PLC ±	4 PLC ±	ANGLES ±	FINISH

MATERIAL: △ FINISH: △

DRW: ST. LEWIS 12FEB91	CHK: ST. LEWIS 12FEB91	DES: SWING	DATE: 20FEB91	NAME: D.R. CLARK
PRODUCT SPEC: 108-1051			APPLICATION SPEC: 114-1020	
WEIGHT: -			SIZE: A2	ONE CODE: 00779
CUSTOMER DRAWING			SCALE: 4:1	SHEET: 1 of 1

TE Connectivity
MTA 156 CONNECTOR ASSEMBLY, 18 AWG, STANDARD

RESTRICTED TO: -
REV: C2

METRIC