

REV	FX	REVISED PER	DESCRIPTION	DATE	BY	CHK
00		C	REVISED PER ECO-11-017736			

△ DIMENSION TO BE MEASURED WHEN THE COVER IS CLOSED.

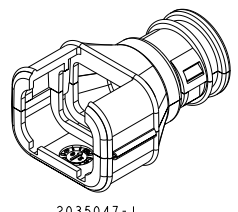

2035047-1

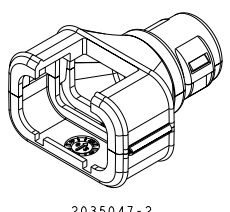

2035047-2

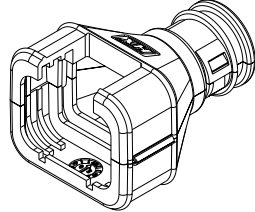

2035047-3

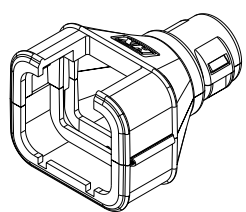

2035047-4

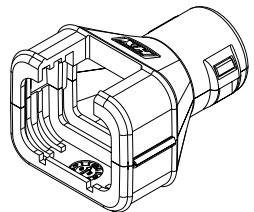

2035047-5

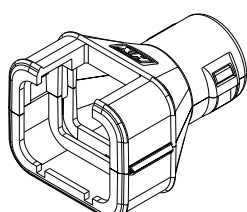

2035047-6

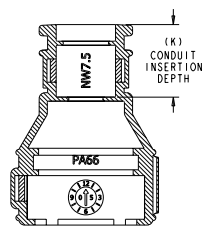

SECTION A-A

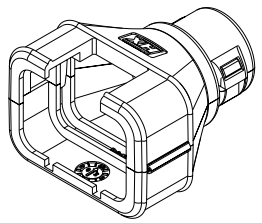
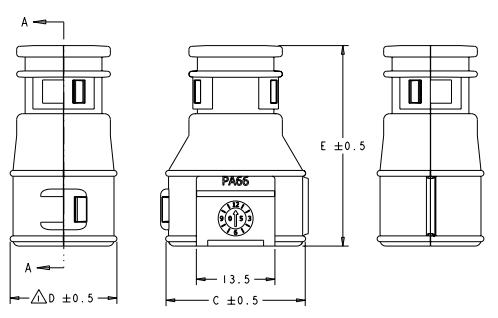

2035047-7

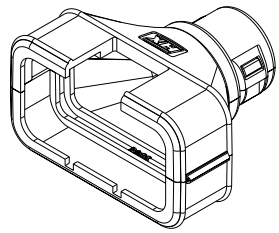

2035047-8

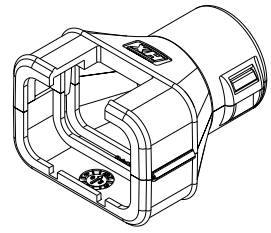

2035047-9

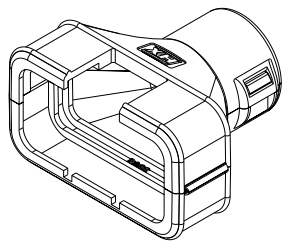

1-2035047-0

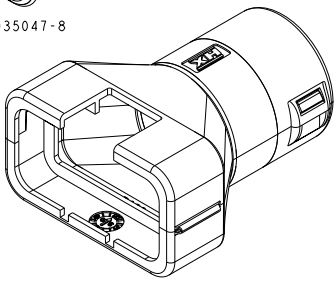

1-2035047-1

TE PART NUMBER	ASSY POSN	NOMINAL CONDUIT SIZE		NOMINAL DIMENSIONS			
		NC	NW	C	D	E	(K)
2035047-1	2	08	7.5	23.9	18.3	34.2	12.3
2035047-2	3	08	7.5	28.5	18.3	34.2	12.3
2035047-3	4	08	7.5	29.1	23.6	38.3	12.3
2035047-4	6	08	7.5	28.7	23.7	36.8	11.1
2035047-5	4	12	10	29.1	23.6	36.8	10.5
2035047-6	6	12	10	28.7	23.6	36.8	10.5
2035047-7	8	12	10	33.1	23.6	36.8	10.5
2035047-8	12	12	10	42.1	23.6	36.8	10.5
2035047-9	8	16	13	33.1	23.6	36.8	10.5
1-2035047-0	12	16	13	42.1	23.7	36.8	10.5
1-2035047-1	12	20	17	40.7	22.7	47.9	12.1

THIS DRAWING IS A CONTROLLED DOCUMENT. DATE: 11/20/2008 BY: MARELY TRAPZOOB

REVISIONS: 00

WILSON 616

STE TE Connectivity
 BACKSHELL AMPSEAL16, 0 DEGREE EXIT

SIZE: A CASE CODE: DRAWING NO: 00779@-2035047

CUSTOMER DRAWING