

Helping Customers Innovate, Improve & Grow



MX-041

### Features

- Ultra-High Stability
- Excellent Temperature Stability
- SC-Cut Crystal
- Frequency Range: 5 MHz to 15 MHz
- Low Package Height

### Applications

- CDMA2000, WiMax, LTE and UMTS Base Stations
- Test and Measurement Equipment
- Broadcast Reference Standard

### Performance Specifications

Frequency Stabilities <sup>1</sup>					
Parameter	Min	Typ	Max	Units	Condition
vs. operating temperature range (referenced to +25°C)	-0.2		+0.2	ppb	0... +70°C
	-0.4		+0.4	ppb	-20... +70°C
	-0.6		+0.6	ppb	-40... +85°C (+5V version)
Warm-up Time			5	minutes	to ± 10 ppb of final frequency (1 hour) @25°C
Initial Tolerance	-50		+50	ppb	at time of shipment, nominal EFC
vs. supply voltage change	-0.5		+0.5	ppb	VS ± 5%
vs. load change	-0.1		+0.1	ppb	Load ± 5%
vs. aging / day	-0.5		+0.5	ppb	after 72 hours of operation
vs. aging / day	-0.1		+0.1	ppb	after 7 days of operation
vs. aging / 1 year	-20		+20	ppb	after 72 hours of operation
vs. aging / year (following years)	-10		+10	ppb	
Supply Voltage (Vs)					
Supply voltage (Standard)	4.75	5.0	5.25	VDC	
Supply voltage (Option)	11.4	12.0	12.6	VDC	
Power consumption @+5V			4	Watts	during warm-up
			2	Watts	steady state @ +25°C
Power consumption @+12V			4	Watts	during warm-up
			2	Watts	steady state @ +25°C

# Performance Specifications

Frequency Stabilities <sup>1</sup>					
Parameter	Min	Typ	Max	Units	Condition
<b>RF Output</b>					
Frequency	±0.1				
Load		5		Ω	
Supply Voltage			6	VDC	Typ
Supply Voltage	3			VDC	Typ
Duty Cycle	5		5	%	(V <sub>b</sub> = V <sub>D</sub> )
Frequency	±0.1 ave				
Load		5		Ω	
Output Power	0	0	0	dBm	Typ
Modulation			0	dBc	Typ
Spurious Emission			0	dBc	Typ
<b>Frequency Tuning (EFC)</b>					
Tuning Range	0	0	0	ppm	
Stability			5	%	
Control Voltage	0	3	0	VDC	
Temp	±0.1				
<b>Additional Parameters</b>					
Phase Noise			0	dB Hz	Hz
			0	dB Hz	Hz
			0	dB Hz	Hz
			0	dB Hz	Hz
			0	dB Hz	Hz
Temperature Coefficient			3	e-2	ppm/°C
Weight			5	g	
Product Weight					Typical
<b>Absolute Maximum Ratings</b>					
Supply Voltage			5	VDC	
Output Power			0	dBm	Typical
Operating Temperature	5		5	°C	
Storage Temperature	5		5	°C	

# Outline Drawing / Enclosure

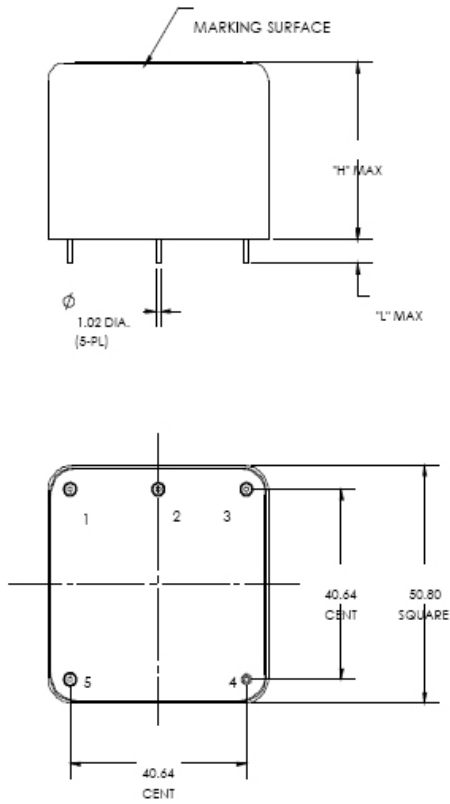

Type A		
Code	Height "	Pin Length "
0	5	5

Pin Connections	
1	Left ( )
2	
3	
4	
5	

## Ordering Information

**MX - 041 0 - D A J - 400 1 - 10M0000000**

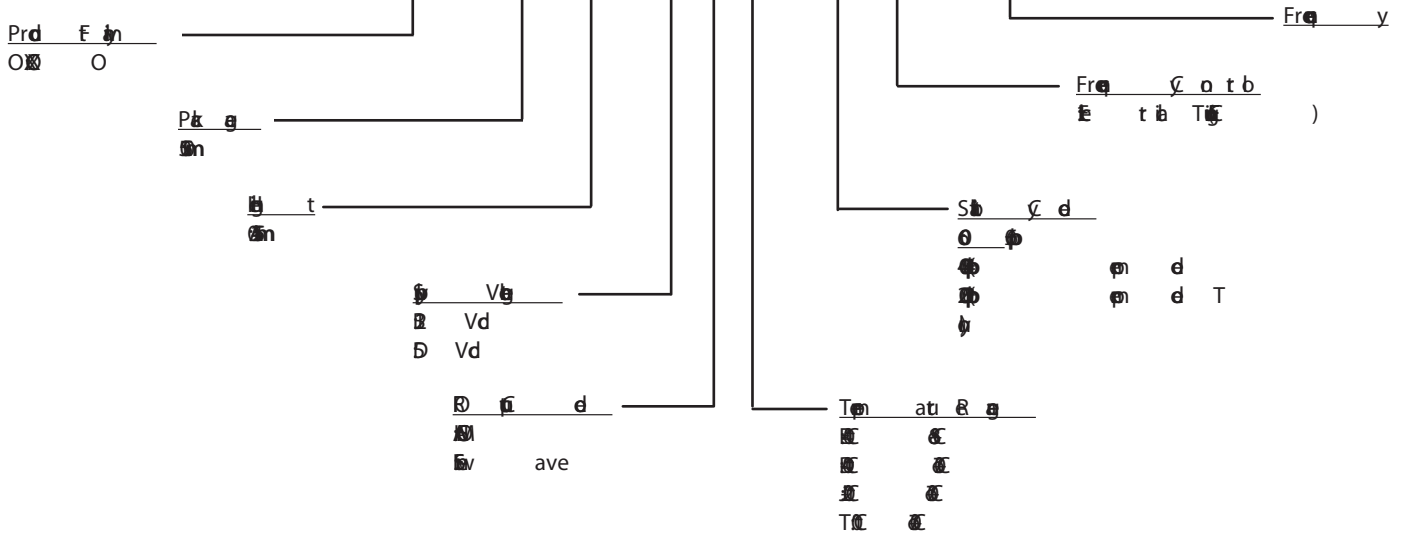

**Notes:**

1. Contact your representative for more information.
2. The temperature range is given in degrees Celsius.
3. Please refer to the data sheet for more information.
4. The part number is given in the data sheet.
5. Contact your representative for more information.

## For Additional Information, Please Contact

**USA:**

Vectron International  
 10000  
 Tel: 714-991-1000  
 Fax: 714-991-1001

**Europe:**

Vectron International  
 10000  
 Tel: 01473-833000  
 Fax: 01473-833001

**Asia:**

Vectron International  
 10000  
 Tel: 65-6349-1000  
 Fax: 65-6349-1001

**Disclaimer**

Vectron International reserves the right to make changes to the product(s) and or information contained herein without notice. No liability is assumed as a result of their use or application. No rights under any patent accompany the sale of any such product(s) or information.

Rev: 2-2-12 dmc